



ੴ ਸ੍ਰੀ ਵਾਹਿਗੁਰੂ ਜੀ ਕੀ ਫਤਹਿ

**Punjab & Sind Bank**

(A Govt. of India Undertaking)

*Where service is a way of life*

## **PUNJAB & SIND BANK**

Zonal office: 30-31, Mohan Tower, Prince Road, Vidyut Nagar  
Ajmer Road, Jaipur, Rajasthan-302021  
Ph: 0141-2358628, 2359352, 2358350

### **Short Term Notice for Interior Furniture Work of Branch**

Sealed tenders are invited from **Empanelled Furnishers/Contractors** for interior furnishing, electrical & Air-Conditioning work of Branch at Hanumangarh Town.

Earnest Money: Rs.26,700/- (Rupees: Twenty Six Thousand Seven Hundred only) by demand draft of any Nationalized bank, payable at Jaipur and drawn in favor of "PUNJAB & SIND BANK"

Date of tender issue : 06/11/2024

Time and date of submission of tender: On or before 5:00 P.M. : 26/11/2024

Time and date of opening of Tender: On or before 3:30 P.M. : 27/11/2024



## NOTICE INVITING TENDER

Dear Sir,

**Subject: Tender for Proposed Interior Furnishing, Electrical and Air Conditioning works from Empanelled Furnishers/Contractors for Punjab and Sind Bank Branch: Hanumangarh Town, District- Hanumangarh (Rajasthan).**

The Zonal Office Punjab and Sind Bank, 30-31 Mohan Tower, Prince Road, Vidhyut Nagar, Ajmer Road, Jaipur Rajasthan- 302021 invites tenders, in duplicate, for the afore said work. Tender copies will be available for free download from the website of Bank "<http://www.punjabandsindbank.co.in> from 06/11/2024 to 26/11/2024".

Tenders should be submitted to the office not later than **05:00 Hrs. on 26/11/2024.**

**The Earnest Money Deposit of Rs.26,700/- (Rupees Twenty Six Thousands Seven Hundred only) by Demand Draft or Banker's Cheque shall be submitted along with the tender in separate sealed envelope. Defect Liability and free maintenance period shall be twelve months from the date of virtual completion of the works; Validity of offer shall be 120 days from the date of opening of the tender.**

Sealed tenders, in the prescribed tender form as

**Envelope 1: Filled BOQ and accepted terms & conditions. Envelope should be super scribed "Tender Document".**

**Envelope 2: EMD of Rs. 26,700.00 in form of demand draft favoring "Punjab & Sind Bank" payable at Jaipur. Envelope should be super scribed "Earnest Money"**

### **Envelope 3: Financial Bid**

The entire two envelopes 1, 2 should be addressed to The Zonal Manager, Punjab and Sind Bank, 30-31 Mohan Tower, Prince Road, Vidhyut Nagar, Ajmer Road, Jaipur Rajasthan-302021 and super scribed **"Tender For Proposed Interior Furnishing, Electrical and Air Conditioning work for Punjab and Sind Bank branch at Hanumangarh Town, District- Hanumangarh (Rajasthan)"**

Tenders should be submitted to the office not later than 05:00 PM. on 26/11/2024. The bids shall be opened at 03:30 HRS, on 27/11/2024.

In case the date of opening of tenders is declared as a holiday, the tenders will be opened on the next working day at the same time.

The Bank does not bind itself to accept the lowest or any tender and reserves to itself the right to accept or reject any or all tenders, either in whole or in part, without assigning any reason for doing so.

Thank you.

Yours Faithfully,

कृते पंजाब एण्ड सिंध बैंक  
For Zonal Manager, PUNJAB & SIND BANK

सुधीश बाजपेयी / Sudhish Bajpai  
ऑचलिक प्रबन्धक, जयपुर / Zonal Manager, JAIPUR  
ऑचलिक कार्यालय, जयपुर / Zonal Office, JAIPUR



Bid are invited from empanelled interior and furnishers in 02 (two) separate sealed envelopes for furnishing of branch at Hanumangarh Town BOQ for captioned furnishing work and terms & conditions are mentioned below. Please deposit the BOQ filled up and terms & conditions duly accepted, on or before 5:00 P.M, 26/11/2024. The BOQ and terms & conditions received after the expiry date and time will not be entertained in any case. Two envelopes should contain the following:-

**Envelope 1: Filled BOQ and accepted terms & conditions. Envelope should be super scribed "Tender Document".**

**Envelope 2: EMD of Rs. 26,700.00 in form of demand draft favoring "Punjab & Sind Bank" payable at Jaipur. Envelope should be super scribed "Earnest Money"**

**Envelope 3: Financial Bid**

### **GENERAL TERMS & CONDITIONS**

1. The contractor will strictly adhere to the design/specifications of the bank as per lay out plan enclosed. Any detail classifications given by M/s. Chandiramani & Associates under whose supervision the work shall be done.
2. Payment of 75% of amount will be made on receipt of bill duly measured, verified and recommended by the Officer-in-charge of the bank and the Architect.
3. Penalties will be imposed in case of infringement / delinquencies / defaults / misconduct / misdemeanors which may also include permanent ban on issue of tenders and removal from the bank's empanelled list.
4. Income tax etc. shall be deducted as per rules.
5. No escalation in rates shall be admissible.
6. No advance payment shall be allowed.
7. After completion of work, submit your final bill, which should be accompanied by the certificate from architect regarding measurement and quality etc.
8. Rates quoted will be exclusive of GST.
9. No subletting of work shall be allowed.
10. No dubious words such as negotiable or discount/concession etc will be used in the tender documents. Use of such words will lead to disqualification.
11. The contractor who is awarded the work will have to retain/deposit 10% of the contract amount of furnishing work excluding the Air Conditioner work as security for one year.
12. TDS wherever applicable as per government rules will be deducted at source.
13. The work should be completed within **30 days** from the date of the work order issued to the contractor to commence the work.
14. The Contractor shall inform the Consultant/Bank in writing before initiating any stage of fabrication or finish whatsoever the case may be. If the contractor fails to complete the work within stipulated time or any extended time allowed by the Consultant/Bank, penalty for the sum of **Rs.5000/- per week** shall be imposed to the contractor, till the work is completed in all respect.



**ANNEXURE-II**  
**(AGREEMENTS SHOULD BE DRAWN ON RS.100 STAMP PAPER)**  
**ARTICLES OF AGREEMENT**

Agreement made at..... this.....day of.....between Punjab and Sind bank.....herein referred to as bank which expression shall include its heirs, executors administrators and assigns of the one part and .....herein referred to as the successful tenderer/contractor which expression shall include his heirs, executors, administrators and assigns) of the other part WHEREAS Bank is desirous of carrying out the work..... and has cost specifications etc. describing the work to be done as per schedule of quantities, along with the general conditions of the contract, special conditions, additional conditions etc. and whereas the contractor has agreed to execute the work described in set once schedule of quantities, general conditions of contract special conditions, additional conditions at the respective rates mentioned in the price schedule of quantities attached.

NOW IT IS HEREBY AGREED AS FOLLOWS:

1. In the consideration of the payment to be made to the contractor as herein provided he shall upon and subject to the said condition execute and complete the works as per the said conditions and price schedule of quantities
2. The bank shall pay the contractor such sums as shall become payable here under at the times at in manner specified in the conditions.
3. The said conditions shall be read and form part of the Agreement and the parties hereto will respectively abide by and submit themselves to the conditions and stipulations and perform the agreement on their parts respectively on such conditions contained
4. All disputes arising out of in any way connected with this Agreement shall be deemed to have arisen in Jaipur and only the Court/Arbitrator in Jaipur shall have jurisdiction to determine the same.
5. The several parts of this contract have been read to us and fully understood by us. The following documents shall be deemed to form and to read construed as part of this agreement, viz
6. The following documents shall be deemed to form and to read construed as part of this agreement, viz
  - a)
  - b)
  - c)
  - d)

(WITNESS)

(BANK)

(CONTRACTOR)





**Annexure III**  
**Bid Securing Declaration Form**

**Zonal manager**  
**Punjab & Sind Bank**  
**Zonal Office, 30-31 Mohan Tower,**  
**Vidhuynagar, Ajmer Road, Jaipur**  
**Pin Code-302021**

**Dear Sir**

**Reg: Furnishing, Electrical and Air Conditioning work for Punjab and Sind Bank, BO: Hanumangarh Town (Rajasthan).**

I/We the undersigned, declare that:

I/We understand that, according to your conditions, bids must be supported by a Bid Securing Declaration.

I/We accept that I/We may be disqualified from bidding for any contract with you for a period of one year from the date of notification if I am We are in a breach of any obligation under the bid conditions, because I/We

- a) have withdrawn/modified/amended, impairs or derogates from the tender, my/our Bid during the period of bid validity specified in the form of Bid, or
- b) Having been notified of the acceptance of our Bid by the purchaser during the period of bid validity (i) fail or reuse to execute the contract, if required, or (i) fail or refuse to furnish the Performance Security, in accordance with the Instructions to Bidders.

I/We understand this Bid Securing Declaration shall cease to be valid if I am/we are not the successful Bidder, upon the earlier of (1) the receipt of your notification of the name of the successful Bidder, or (6) thirty days after the expiration of the validity of my/our Bid.

Signed: (insert signature of person whose name and capacity are shown)

in the capacity of (insert legal capacity of person signing the Bid Securing Declaration)

Name: (insert complete name of person signing he Bid Securing Declaration)

Duly authorized to sign the bid for an on behalf of (insert complete name of Bidder)

Dated on.....day of.....(insert date of signing)

Corporate Seal (where appropriate).



**GENERAL CONDITIONS  
ANNEXURE IV**

1. Sealed tenders should be addressed to Punjab and Sind Bank Zonal Office Jaipur and super scribed "Interior Famishing, Electrical and Air Conditioning Works for Punjab and Sind Bank of BO: Hanumangarh Town (Rajasthan)" and should reach the bank before 05.00 PM on 26.11.2024.
2. No tender will be received after 05.00 PM on 26.11.2024, and the lenders will be opened on 27.11.2024, at 3.30 PM unless otherwise informed
3. The tenders will remain valid for a period of 90 days from the date of opening of tenders. Bank reserves the right to accept or reject any or all the tenders without assigning any reason to do so.
4. The tenderers should quote the rates in figures as well as in words.
5. All erasures and alterations made while filling the tender must be attested by initials of tenderer Overwriting of the figures is not permitted.
6. At the time of submission, every tender must be accompanied by a Demand Draft of Rs.26,700/- In favor of Punjab and Sind Bank, Jaipur as Earnest Money Deposit. No interest will be paid on earnest money. Any tender which is not accompanied by the earnest money shall be summarily rejected.
7. The Bank reserves the right to reject any or all the tenders, accept part of any tender or entrust the entire work to any contractor or divide the work to more than one contractor (item wise) without assigning any reason or giving any explanation. The rates quoted by the contractor will hold good for this bifurcation and no compensation will be paid on this account
8. On receipt of intimation from the Bank of the acceptance of his tender, the tenderer within 3 days should submit his acceptance of the work order. If the successful tenderer fails to undertake the work the earnest money deposited by him will be forfeited and the acceptance of his tender may be withdrawn
9. The rates quoted in the tender shall include all charges of scaffolding, lift, any tools and plants, railway freight, labour conditions and fluctuations in the rates, excise duty, all taxes including, octroi and any other charges or expenditure for carrying out the work. GST shall be paid as per Bank's guidelines, if applicable.
10. Water and electricity shall be provided by the bank for completing the work free of cost at one point.
11. No escalations in rates will be allowed under any circumstances.



12. The successful tenderer is bound to carry out entire work within the period stipulated in the appendix. The tenderer will have to pay liquidated damages for non-completion of job within stipulated period penalty for the sum of Rs.5000/- per week after expiry of period of completion.
13. The liquidated damages as mentioned above may not be enforced if the Contractor applies for extension of time mentioning the reasons for extension. Extension of time in days will be granted by the Bank if it is proved that Contractor is not at fault for extending the work beyond stipulated date of completion.
14. The successful tenderer is bound to carry out items of work necessary for completion of job even though the same are not included in the schedule of quantity. Rates of extra items will be derived from the tender. In case the rates do not exist in the tender and extra item is not similar to tender item, then the rates will be worked out on the prevailing market cost of material and labour including wastage plus 15% towards tax and Contractor's profit.
15. The Contractor must co-operate with other contractors appointed by the bank so that entire work shall proceed smoothly with least possible delay and to the satisfaction of the bank.
16. The Contractor shall remove all malba etc, wash and clean the floors at his own cost and handover the site in proper manner on the completion of work.
17. The tenderer shall acquaint himself with the site conditions, making his own arrangement for storing of material at site, lift, cartage etc.
18. Eight percent of the value of work done shall be deducted as security deposit from the running bills of the Contractor and will be retained for defects liability period (as mentioned in the Appendix) and shall be released after the defects liability period, provided no defects are noticed during the period. The security deposit includes earnest money deposited by the Contractor with the tender.
19. The contractor will attend to all defects noticed during defect liability period. If the contractor fails to attend the defects, these defects will be rectified by the Bank and the expenditure incurred on this account will be recovered from security deposit.
20. The contractor shall make adequate arrangement for watch and ward of his material and shall ensure the safety, breakage and any theft of material fixed or unfixed by him or other sub-contractors.
21. The work executed should be got approved by the Bank and contractor shall rectify any bad workmanship pointed out at any stage and remove from site all the rejected materials immediately.



22. The contractor shall be responsible for application of labour laws, compensation for injury and accident to person, whether employed by him or by his sub-contractor.
23. The contractor will take necessary precautions for carrying out the work avoiding any damage to structures/decorative parts of the property. The contractor will rectify any damage done at his cost.
24. The contractor shall ensure that workmen employed by him for execution of work are suitably covered against Workmen's Compensation Act and that all liabilities arising out of Workmen's Compensation Act, ESIS and other legislative enactments applicable to such works and workmen shall be to the contractor's account.
25. Furnishing works will be carried out as per bank's standard drawings/specifications and to the entire satisfaction of the Bank.
26. The contractor shall give due notice to the bank to check measurements of any work which is likely to be hidden before covering the same.
27. The contractor will submit running bills for the value of work done not less than interim payment (as mentioned in the Appendix) mentioning full nomenclatures of items, rates, amount, measurements sheets reasons for part rates claimed, if any.
28. In case of non-completion or delay in completion of work or removal of defects in time, the bank shall be free to appoint another agency to get the job done at contractor's risk and cost.
29. For fixed as well as loose furniture rates quoted by the contraction will be inclusive of all taxes, including sales tax, octrot, transportation etc. and no extra amount will be paid on this account.
30. Income-tax, Work Contract Tax and any other tax as applicable will be deducted at source from the contractor's bill and will be deposited with the ITO./Sales Tax Department as per rules.
31. The bank may delay the progress of work without, in any way, vitiating the contract and grant such extension of time for the commencement completion of the contract as it may think proper and sufficient in consequence of such delay and the contractor shall not make claim for compensation or damage in relation thereof.
32. The contractor will not execute any extra item without Bank's permission in writing.
33. The quantities mentioned in the schedule of quantities are approximate. Payment will be made on actual work done by the contractor However, the contractor should not deviate the quantity without Bank's permission.
34. A conditional tender quoted by the tenderer is liable to be rejected.



35. The Bank has a right to alter the nature of work and to add or omit any item of work or to have the option of the same carried out departmentally or otherwise and such alterations or variations shall be carried out without prejudice to this contract.
36. The Bank has right to terminate the contract, if the contractor abandons the work, or fails to commence and complete the work in time, or fails to abide by the contract conditions.
37. **Variation / Deviation in Tender Quantities:** The price of all such additional items/non-tendered items will be worked out on the basis of rates quoted for similar terms in the contract wherever existing or on engineering rate analysis based on prevalent fair price of labour, material and other components as required. The tender rates shall hold good for any increase or decrease in the tendered quantities up to variation of 25%. For variation beyond 25%, the rate for the respective item will be arrived based on the market rate.
38. **Substitution:** Should the contractor desire to substitute any materials and workmanship, he/they must obtain the approval of the Employer Architects in writing for any such substitution well in advance. Materials designated in this specification indefinitely by such term as "Equal" or "Other approved" etc. specific approval of the Employer/Architects has to be obtained in writing.
39. **Concealed Work:** The contractor shall give due notice to the Employer whenever any work is to be buried in the earth, concrete or in the bodies of walls or otherwise, becoming inaccessible later on, in order that the work may be inspected and correct dimensions taken before such burial, in default whereof the same shall, at the opinion of the Employer be either opened up for measurement at the contractor's expense or no payment may be made for such materials, should any dispute or difference arise after the execution of any work as to measurements etc or other matters which cannot be conveniently tested or checked, the notes of the employer shall be accepted as correct and binding on the contractor
40. **Advance Payment and Secured Advance:** Advance payment for works actually executed but not measured and billed for, should not be made generally. Payment should only be made after the detailed measurements of the work are taken and recorded and the contractor's bill for the same is approved by the Competent Authority. However, advance payments on the running bills to the extent of 75 % of the Architect certified amount may be made wherever found necessary. In such cases it shall be ensured that the test checking of the measurements & scrutiny of bills are completed before payment of the next running bill. Secured advances against the security of materials brought to site may be made to the contractors whose contract is for finished work in such cases, the Competent Authority may sanction advances up to an amount not exceeding 75% of the value (invoiced/assessed value) of such materials, provided that they are of a durable/non-fragile nature and that an Indemnity Bond is drawn up with the, contractor under which the Bank secures a lien on the materials and is safeguarded against losses due to the contractor postponing the execution of the work or to the shortage or misuse of the materials, and against the expense entailed, if any, for their proper watch and safe custody. Recoveries of advances so made should not be postponed until the whole of the



work entrusted to the contractor is completed. They should be made from his bills for works done as the material are used, the necessary deductions being made whenever the item of work in which they are used are billed for Secured advances against the security of material brought to site will be made for works having value more than Rs.10 lacs and the stipulated time of completion is more than one month.

41. **Arbitration:** In case of any dispute between Bank and Contractor, the decision taken by the Arbitrator who will be appointed by the bank will be final.



**ANNEXURE-V**  
**APPENDIX REFERRED TO IN THE GENERAL CONDITIONS**

1. Defects liability period (DLP): 1 year
2. Date of commencement: Next day from date of issue of award letter
3. Stipulated period for completion: 10 from date of issue of award letter
4. Minimum value of work done for interim payment: 75 % of the contract amount
5. Retention Deposit: 10% of all running Bill
6. Security deposit: 33,300/-
7. Liquidated damages for non-completion of : 5000/- per week work within stipulated period
8. The Security Deposit shall be refunded after the completion of defects liability period. The Security money shall not carry any interest and shall be retained interest free by the Bank





### **SPECIAL CONDITIONS OF CONTRACT**

**(To be modified while inviting tender as per the site requirement/nature of work)**

1. Intending tenders shall visit the site and get acquainted with site conditions and activities during the working hours before quoting the rates.
2. All measurements shall be made as per CPWD norms.
3. Site should be cleaned every day and all the unusable material/melba shall be removed from the site and usable material shall be stocked properly so that there is no hindrance for staff and public failing which bank will remove the same at their level and suitable amount shall be recovered.
4. The contractor should shift office furniture / cabinets etc. required during execution of work and rearrange the same in the desired position after completion of the work as per the direction of the bank.
5. The work should be carried out as per latest CPWD specification and as per the standard engineering practice.
6. The contractor will take all necessary precautions for carrying out the work avoiding any damage to the structure. Partition, panelling etc. before execution of job. If any damage is occurred during the execution, the contractor will rectify the damages done at his cost.
7. The contractor shall employ competent supervisor for the work who shall be available (by turn) throughout the working hours to receive and comply with instruction of the employer.
8. The work permit shall be issued for 24 hours, however, being the restricted / controlled area most of the work is to be carried out after working hours and holidays for completion of work within the stipulated time. If the contractor works during office hours the contractor should ensure that no hindrance or inconvenience to the Bank



## PREAMBLE TO BILL OF QUANTITIES

### RATES TO INCLUDE:

Rates quoted shall be for the items completed in all respect at all foams/heights/levels including all taxes, octroi and the cost of all material, fittings, fixtures, all labours and for all the operations as detailed in the specifications and contract conditions. Apart from other factors mentioned in the specifications and contract conditions, rates quoted for the items in this schedule shall also include the following

### **GENERAL:**

1. Whether mentioned or not in the Bill of Quantities, all works are to be craned out as per the drawings, designs, catalogues and or instructions of the Bank Nothing extra shall be paid over the quoted rates for not understanding the designs etc. beforehand.
2. Sample of all works/items shall be got approved from the Bank before taking the mass production in hand and nothing shall be paid for the cost of samples.
3. Any incidental work required to complete the item and not specifically covered in the item as mentioned in Bill Quantities shall be completed at no extra cost.
4. Unless otherwise specified all exposed surfaces of wood/wooden mouldings and plywood of loose furniture/items of tops shall be finished in at least two coats of melamine polish, including staining to match the shades of laminates etc.
5. Unless otherwise specified, all inner surfaces, sides and under sides of furniture items, drawers/cabinets shall polished/Painted flat oil painted as directed by Bank
6. All exposed edges of plywood/block boards /particle board shall be finished with teak wood lipping's of 5 mm thick of profile as per detail and Melamine polished unless otherwise specified and no extra cost shall be paid.
7. All furniture items shall be delivered at site packed in polythene sheets.
8. All finished work must be truly vertical and horizontal or in any other plane as shown and required true to lines and levels. The tenderers must inspect the various existing surfaces and areas on which they have work on and take whatever measures necessary to achieve the objective and include the cost of the same in his rate as no extra will be payable for this purpose.
9. The contractor shall be required to produce the manufacturer's certificate for the material supplied by them if asked by the bank notwithstanding the manufacturer's certificate, employer can ask for testing of materials in the approved test labor at ones. The result shall satisfy the requirement of the relevant IS standards



### **WOOD WORKS:**

1. Wherever ply is mentioned it will mean ply wood
2. All teak wood will mean C P teak.

### **HARDWARE:**

1. Necessary handles, tower bolts, ball catchers, stoppers, hinges, brass/GI screws, nails, locks, siding rails, nut and bolts etc. shall be provided by the Contractor which shall be out of the approved make of these materials annexed in the technical specifications/approved by Bank.

### **PAINTING AND POLISHING:**

1. All finishes, shade of colours, texture of fabrics including all surfaces of finishes like POP, painting, lamination, panelling, stitching joints in upholstery, all polishing shall be as per the satisfaction of the Bank.
2. Thoroughly brushing the surface to be finished, free from mortar dropping and other foreign matter including preparing the surface and sand papering to give an even surface.
3. For painting and polishing items-on all kinds of wood and wood based surfaces.
4. All painting work to be completed with at least one coat of the primer along with two coats of the paint as per the Technical Specification, Manufacturer's specification and to the satisfaction of the Bank.
5. All the polishing works to be completed with at least two coats of the polish of the approved make as per the list of approved manufacturers and to the full satisfaction of the Bank.

### **GLASS WORKS:**

1. The edges of glass tops for tables wherever shown shall be beveled as per approval of the Bank

### **FALSE CEILING:**

1. Rates should include materials/materials required to suspend the false ceiling with dash fasteners from the reinforcement of the slab and repainting the portion without affecting the structural strength of the slab, also with provision of strip hangers MS flats and hinged through nuts and bolts of adequate size (Raw plug shall not be applied). The channels and hangers shall be as per the instructions of the Bank.
2. Cut-outs and openings as required by Bank for provision of lights, switches, AC grills and diffusers, sprinklers and providing of trap doors etc and other fittings in false ceilings and holes and cut-outs as required for running conduits in frame work of panelling including cut-outs for switches and fittings in the panelling will be made by the



Contractor. He will also provide necessary frame work support for foxing of lights AC diffusers grills and fixtures etc. All these above will be made/provided by him at no extra cost and will be deemed to be included in the rates of the items quoted by him.

**PARTITIONS AND PANELING:**

1. Quoted rate shall include lab our materials required to fox the sub-frame to the wall with MS flats (LU") shape clamp with adequate screws and repairing the portion damaged while putting the gutties etc and making good the same.
2. Quoted rate shall be inclusive of making provisions for electrical conduits and switch boxes and time required while coordinating with other Contractors for the final finishing of the work.
3. The partition frame work shall be provided upto the RCC slabs at top but measurement for payment shall be partition up to false ceiling and frame /support of partition above false ceiling shall be carried out within the quoted rate for which no extra shall be paid.
4. All electrical Data & AC works shall be got craned out through licensed Electrical Contractor having experience of similar work and duly approved by Bank. The work shall be executed as per specifications and strictly in keeping with relevant IS code and rules and regulations of authorities.
5. All work/materials will be as per good engineering practice
6. Wherever glass is mentioned it will be clear float glass.



**GENERAL MATERIAL SPECIFICATIONS**  
(For Interior Furnishing Tenders)

S.No	Materials	Manufacturers
1	Flush Door Shutters	Century/ Green / Kitply
2	Particle Boards /Block Boards /ply	Century, Kitply, Green, Archid, formica
3	Glass (Plain / Pin Headed) and Glass Tinted	Modi Float / Asahi / Saint Gobain
4	Hardware/fitings	Classic / Shalimar /Earl Bihari (EBCO),
5	Brass Mortice Locks & Latches	Godrej, Dorma, 4-C ACME,
6	Hydraulic door closer /Floor spring	Everite / Hypper / Hemco
7	Aluminum door, window and ventilator sections.	Jindal / Indal / Hindalco
8	Synthetic Enamel Paint	Jenson & Nicholsan / Asian / Nerolac / Berger
9	Oil Bound Distemper	Jenson & Nicholsan / Asian / Burger / Nerolac
10	Plastic Paint	Asian / Burger / Nerolac / Jenson & Nicholsan
11	Panelled Doors	National / Century / Swastik / Kitply
12	P.V.C. Doors	Sintex / Mihir / Fixopan
13	Screws	GKM/mettle fold
14	Brass Hinges	Reliance/Punit heavy duty
15	Drawer sliding fitting	Shalimar /Earl Bihari/EBCO
16	Drawer Shutter Lock	Godrej (3 set of keys)
17	Ball Catch	Magnetic (M-2) / Brass
18	Lamination	Formica, Greenlam / Marino / Century / Archid/ AICA
19	Beadings	MP, Burma T W , Half round, Quarter round.
20	Veneer	Kitply / Uro / Durian / Century
21	Adhesive	Fevicol (SH)
22	Polish	French/Zinc Oxide / Melamine (Asian)
23	Wood Preservative	Asian paint / British paint
24	Sun control film	Garware /3M
25	MDF Board	Green, Action Tesa,



<b>LIST OF APPROVED MAKES FOR ELECTRICAL ITEMS &amp; MATERIALS</b>		
<b>Sl. No.</b>	<b>ITEM</b>	<b>EQUILENT MAKES TO BE USED ONLY AFTER TAKING PRIOR CONSENT</b>
	Copper wires/ Telephone/ TV Cable	POLYCAB/ RR KABLE/ FINOLEX
	M.C.B. / DB / ELCB	SCHENIEDER / LEGRAND/Havells
	MCCB / ACB	SCHENIEDER / LEGRAND/Havells
	PVC Conduits and accessories	BEC / AKG /Jindel
	Light Fixtures	WIPRO /PHILIPS/ BAJAJ/ CROMPTON / HAVELLS
	UPVC Conduits and accessories	FINOLEX / SUPREME
	Contacter	TELEMECANIQUE / GE
	Ceiling Lights	PHILIPS /WIPRO/ HAVELLS/ CROMPTON
	MV Panels	TRICOLITE/ POWER SEVER/ ENGINEER & ENGINEER
	HT XLPE Cable	HAVELLS / KEI
	LT Cable	POLYCAB/ RR KABLE/ FINOLEX
	Cable Glands	DOWELL'S/ GRIPWELL/ MASTER-SEAL
	Cable joints	MAHINDRA/ MASTER-SEAL
	Thimbles and Lugs	DOWELL'S/ MARUTI
	Switches and Sockets outlets (Modular type)	MK / SCHENIEDER
	Cat-6 UTP Data Cable	D-LINK
	Information outlet Cat-6	D-LINK
	Industrial Plug & Socket	ANCHOR / SCHENIEDER
	Indoor & Outdoor Lights	WIPRO /PHILIPS/ BAJAJ
	3 Phase Digital Energy Meters	SECURE / GENUS
	Fresh Air Fans	CROMPTON / HAVELLS
	Switch Fuse Units With HRC fuses	HAVELLS / L&T / ABB
	Current Transformer / Meters / Voltage Transformers / Relays / Starters / Contactors /	L & T / SIEMENS / AUTOMATIC ELECTRIC / CONTROL & SWITCH GEARS / ABB

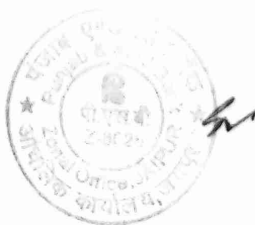

	Selector Switch / Indicating Lamps	
	Change Over Switches	GE / L&T / HAVELLS
	Switches and Sockets outlets (Conventional piano type)	ANCHOR/ LEGRAND/MK
	MS Conduits and Accessoires	B.E.C./AKG/MK
	Hpmv/hpsv/ halogen Lamp	PHILIPS / WIPRO
	Ceiling Fans / Wall Fans	CROMPTON / BAJAJ / USHA
	Ceiling Rose holders	ANCHOR/ MK / SCHENIEDER
	Buzzers/Bell Push bell	ANCHOR/ MK / SCHENIEDER
	HRC Switch Fuse nits	SIEMENS ABB/GE/L&T
	Electronic Regulator	MK/ANCHOR ROMA/DEGRAND/MDS
	Geysers/water/heater	SPHERE HOT /RACOLD/USHA
	UPS	EMERSON / POWERWARE / TATA LIBERT
	Smoke Detector	HONEYWELL /COOPER / SYSTEM SENSOR
	Electronic Hooter	HONEYWELL /COOPER / ASE
	CTV Camera	SAMSUNG/ SONY
	Speakers	BOSCH/ JVG/ AHUJA
	EPABX	ALCATE/ SIEMENS/CCL
	Air-Conditioners	(Hitachi/ Daiken/ Mitsubishi/ O-General/ Blue Star

**NOTE :**

Sr. No.	Description
1.	The choice of the final makes shall be made by the owner/ consultant
2.	The samples or Cat. No. of all type of switches & light fittings should be approved before execution.





INTERIOR FURNISHING, ELECTRICAL & AIR-CONDITIONING WORK ESTIMATE OF PUNJAB & SIND BANK BRANCH/OFFICE AT HANUMANGARH TOWN.					
<b>A</b>	<b>INTERIOR/FURNISHING WORK</b>				
S.No	DESCRIPTION	Qty	Unit	Rate	Amount
<b>1</b>	<b>WOODEN PARTITION</b>				
(a)	Full Height Partition				
	Wooden partition system using an internal frame work of anti termite treated pine wood section of clear size 2" X 1.5" at 2'.0" c/c both ways with both ways a covering of 8mm commercial ply covered by combination of as per designed pattern laminate 1.0mm thick in approved shade- Formica/Green/ or equiv. approved make with bands and combination with grooves etc. as per details. 3" x 1" chowkhats for doors, including provision of windows as per size with 6 mm thick etched as/design glass and beading 30 mm wide for fixing the window glass and covering the joints between partition and chowkhats etc. 1.25"X1.25" T.W. moulding / second colour band as designed at skirting and at junction of false ceiling level. As per drawing and design in drawing. Same pattern door to be fixed in the partition with all hardware, tower bolts, stoppers, Mortise lock with SS Handles etc. Complete fine finish as per instructions of the Architects.	620.00	Sq.ft		
(b)	low height Partition Same as full height partition but edges covered with 2½"x1½" teak wood moulding complete with 1'-6" height 12mm float glass with etching as per detail.	136.00	Sq.ft		
<b>2</b>	<b>SIDE RACKS :-</b>				
	1'-4" wide top filling racks 1.0 mm laminated top as approved lower 19mm block board box 1'-4" deep (clear size) and drawers and shutters at designated places and all visible sides in approved style laminate, all hardware in brass, godrej locksets handles etc. as per instructions of the architects/ bank and details complete fine finish. Drawer should slide on telescopic channels.	20	Sq.ft		
<b>3</b>	<b>CASH COUNTER:</b>				
	P/F 4'-6"x2'6" cash counter in double height level. Counter top & vertical supports to be made in 19 mm thick commercial board of approved make. 15" high 12mm thick vertical glass above 2'6" ht., with 12" wide 12mm thick glass placed horizontally as writing top. 12 mm thick glass above writing top with 6"x6" opening, as per drawing. Providing 4 nos. of 16" wide lockable drawer units on the working side of the counter. All exposed surfaces to be finished in 1mm laminate of approved shade & make. Duly polished TW moulding to be provided as per requirement. All internal surfaced to be painted /primer coated as specified.	4.50	R.ft		
<b>4</b>	<b>TOUGHENED GLASS DOOR</b>				
	Providing & fixing in position 12 mm clear flat toughened glass for naked glass partition & door. The work to				



	include making all the necessary holes, cuts etc. & the toughening the same. The cost to include all hardware required of approved make including floor spring with its accessories, top pivot centre lock, 900 mm glass door handle etc. along with 3m privacy film to be pasted as per design & drawing the approximate size of each glass will be 1000 mm to 1200 mm x 2400 mm as per site condition, with patch filling the rate is for a finished item of work etc. complete as directed.				
	a) Fixed Portion	55	Sq.ft.		
	b) Door	63	Sq.ft..		
5	<b>OFFICER COUNTERS:-</b>				
	Providing and fixing counter as per approved design 750 mm high and 750 mm wide, made with 19 mm thick commercial board and 12mm thick commercial ply on back finished with 1 mm thick laminate on all exposed surfaces. Each work station made separately and joint with the partition with following provisions.	28.00	R.ft		
(a)	Metal Keyboard tray with telescopic channel complete.				
(b)	A Platform to be made inside table for CPU of 19mm comm. Board with 1.0 mm laminate on top and teak wood footrest of size 3"x 1½".				
(c)	Necessary hole to be made in counter for cable manager with plastic cable manager.				
(d)	A Drawer unit is to be made from 12mm thick wood members side with 19mm thick fascia of comm. Board with 1.0mm thick laminate top. One drawer to run on telescope channel with auto lock / multipurpose lock etc.				
(e)	All exposed surfaces without laminates to be finished with oil paint inside complete.				
(f)	All exposed edges to be provided with stream beach wood moulding, complete as per design.				
6	<b>WOODEN STORAGE (Low ht./Full ht./over head)</b>				
	1'-6" wide top filling racks 1.0 mm laminated top as approved lower 19mm commercial board box 1'-4" deep (clear size) and drawers and shutters at designated places and all visible sides in approved style laminate, all hardware in brass, godrej locksets handles etc. as per instructions of the architects/ bank and details complete fine finish. Drawer should slide on telescopic channels.	400	Sq.ft		
7	<b>TABLES</b>				
	Computer compatible, laminated front, top, sides and drawer/cabinet fascia table workstations. 19mm commercial board fabrication as per design & details and specifications and plan with writing top height 2'6" as per design and details. 1.5" x 1.5" TW moulding all around the top as per design. Front fascia as designed in drawing with bands and grooves. TW lipping at all board edges TW moulding as approved on the front and internal sides, drawers, keyboard trays, hardware, making provision for electrical points, all inner surfaces to be painted in enamel paint of approved shade. All other				



	sides laminated of approved thickness details and specifications in drawing. All drawers and keyboard trays should slide on telescopic channels and all drawers lockable by separate lock of godrej lock, with 1 Nos. drawers and two shelf with shutter on one side space for CPU placement with footrest T.W 3"x1'6" and plastic wire manager cut out cap. Complete as per detail & drawings				
(a)	BM Table ( 6'- 0" ' 2'-6" x 2'-6")	1	Nos.		
<b>8</b>	<b>FALSE CEILING"-</b>				
(a)	P&F false ceiling with Gypsum Board 12.5mm thick fixed to a metal frame comprised of ceiling channel of size 80mm X 26mm X 0.5mm @ every 450 cms centres, inter channel 45mm X 15mm X 0.9mm @ every 1220mm centres, peri- meter channel 20mm X 26mm all along the wall, strap hanger suspendeds 25mm X 0 5mm with nuts and bolts 6.4mm x 12.7mm, connecting clip 2.64mm thick, dry walls screw 25mm long , soffit cleat. 27mm X 37mm X 25mm X 1.6mm thick and dash fastener/ rawl plug 12.5mm dia X 35mm long with 6mm dia bolt. The joint of gypsum board to be taped 3 times and sealed with jointed compound. Cut-out are provided to accommodate luminaries, air conditioning grills and fire warming dectors if any. Surface of the ceiling to be painted with 3 coats white plastic emulsion paint as directed.Soffit surface of the false ceiling will be measurement for payment. Rates includes providing & fixing G.I. pipes to support channels of false ceiling @4'- 0" c/c horizontal fixed in walls and beams at 6" depth in case of stone slab roof with complete fine and finish of the walls and beams through plaste, putty, paint, etc. complete in all respect.	625	Sq.ft		
(b)	In combination of P&F suspended false ceiling with Armstrong make 15 mm thick fixed to metal frame AMF ceiling panel : ARMSTRONG				
	BLACK T JUNCTION				
	Surface finish : Pinhole				
	Surface pattern : Mineral				
	Grid size : 600 X 600mm				
	Thickness of panels : 15 mm				
	Edge detail : SK				
	Width of exposed grid : 24 mm				
	The suspension grid consist of main runners and cross tees. Main runners to be supported by suspension wire, slotted hangers, adjustable hangers or galvanised angle at 1250 mm centres.Perimeters to be finished with angle trims or shadow edge trims plugged and screwed to the wall at 450 mm c/c	320	Sq.ft		
<b>12</b>	<b>WALL PANELLING:-</b>				
	Providing & Fixing Wall paneling (Low/Full height panelling) with 8mm thik comm. ply and finished with 1.0	500	Sq.ft		



	mm laminate in two or more colours fixed on 50x25 kail wood frame at 600 centre to centre both sides. The paneling to have 25x60 mm teak moulding on top. Complete with melamine polish.				
<b>13</b>	<b>GLASS FOR TABLE TOP</b>				
	P/F 10mm glass over tables top complete with grinding polish & on round edges making hole cutting including.	18.00	Sq.ft		
<b>14</b>	<b>FLUSH DOOR</b>				
	Providing & fixing flush doors 35mm thick with 1.0mm laminates on both sides. The item includes Teakwood chaukhat made from 75x50 teakwood. The door to have 12mm teak wood lipping on edges. The door is to be complete with Cylindrical door Lock (Godrej make) 200mm SS/Brass handles, brass Stopper, Tower bolts, 119mm Brass/SS hinges etc. all Teakwood surface to be melamine polished complete to the satisfaction of Architect/ Employersize 750x2100	35	Sq.ft		
<b>15</b>	<b>Front Glass of counter</b>				
	P/F 12mm thick clear glass in front of officer counter with teak wood beading of approved size including a cutout of 6"x4" with grinding polish and round edges as per design and details complete. Actual glass will be measured for payment.	56.00	Sq.ft		
<b>16</b>	<b>Pin up boards</b> Supplying and fixing in position pin up boards, fabricated with 6mm ply covered with 12 mm soft board, padding and upholstered with fabric costing Rs. 150/- per mtr. The edges of soft wood to have Teak wood moulding, melamine polished	12	Sq.ft.		
<b>17</b>	<b>COVER FOR ELECTRICAL PANEL:</b> P/f cover for electrical panel as a box made in 19mm board with shutter Lock (Godrej make) 200mm SS/Brass handles, tower bolts, 119mm Brass/SS hinges, 9"x18" Air louvers etc.,as per size & drawing. The shutters shall be front opening. Duly polished TW moulding to be given on all exposed edges. All internal surfaces to be fixd 6.0mm thick Bison board with paint. Note:- Only front elevation to be considered for area calculation.	36	Sq.ft		
<b>18</b>	<b>Shutter Boxing</b>				
	P & F 19mm water proof board boxing to shutter and base to facia signage with internal supporting framework of hardwood section complete laminated 1.0mm thick. 2'.0" high with openable hinged cover for shutter servicing at the bottom complete fine finish	55	Sq ft.		
<b>19</b>	<b>SLIP COUNTER:-</b> Providing & fixing a 12mm Toughened glass top with	1	Nos		



	grinding polish & on round edges. slip counter 4'0"x1'0"x4'0" with shelf and pigeon holes to keep slip at top 12"wt. with 19 mm thick termite & water proof Board divisions & leafs of block board below with three internal division in height to create boxes for Cheque Drop Box, Suggestion Box, Complained Box etc. as per design & 1mm thick lamination of approved shead & make. Complete in all respect.				
20	DRESSING TABLE Dressing Table complete 4'0" x 2'0" mirror covered by wooden frame as per design with cushioned 2'0" x 2'0" x 1'4" on castors stool in strong room.	1	Nos		
21	CENTRE/CORNER TABLE:				
A	Providing and fixing of centre table of rubber wood 1.5" x 3" size 2' x 4' , 12 mm glass top (as per detail drawing)	1	Nos.		
22	CHAIRS				
	Suppl y of Executive Revolving Chair, seat and back PU cushioned (moulded cushion in curvature), with single piece PU arms, polyurethane base with double pvc coated wheels of best quality (without threat push & tight type), mechanism for revolving and tilting duly powder coated complete in all respect as per approved model of Godrej. (BRAVO SERIES)				
	i) Executive Hiback Revolving Chair (B.m) 9U01R	1	Nos		
	ii) Officer Chair Revolving Chair 9U02R	8	Nos		
	iii) Visitor chair 9U12R	3	Nos		
	iv) S.S. Nano Parch Chair	1	Set		
25	<b>REMOVING, SHIFTING, STACKING, DISPOSAL, ETC. WORK :-</b> Removing, shifting, stacking, disposal, etc. work of the existing furniture, electric wiring & fixtures, down lighters, Tube lights, ceiling fan, wall fan, exhaust fan, power points, S.B., UPS point, data point, telephone point, DB's, etc.] complete in all respects making the ceiling, floor, walls, roof, etc. fine & finish with the help of masonary, plaster, putty, paint, tiles, etc. complete as per direction of Bank/ Architect. The items includes caffolding & all work upto G+4 lvl.	1	Job		
	<b>TOTAL PART-A</b>				
B	<b>ELECTRICAL AND ALLIED WORKS</b>				
<b>S.No</b>	<b>DESCRIPTION OF WORKS</b>	<b>Qty.</b>	<b>Unit</b>	<b>Rate</b>	<b>Amount .</b>
1	POINT WIRING P & F light/ fan/ call bell points/ sockets etc. with 2x1.5 sq.mm pvc insulated 1100 v grade copper conductor wires and 1.0 sq.mm earth wire in concealed/ surface using PVC 2.0mm/25mm/ 32mm dia conduits,				



	accessories such as bends, tees, saddles, draw boxes, mounting boxes, inner plates, cover plates, ceiling rose etc. (wherever required) and plugs etc. no flexible conduits will be allowed The circuit wiring starting from DB to point control box/ switch box using 2x2.5 sqmm & 1x1.5 sqmm earthing pvc insulated wiring with colour code to be provided. Identification ferrules at both ends to be provided.				
	<b>NOTE:-</b>				
	All wires & cables shall be FRL only				
	All material shall be approved make of P&S Bank .				
	Color coding must be maintained				
	No flexible conduit & elbows will be allowed.				
	Each circuit shall have independent earth wire.				
	Each point must be seperately earthed.				
	Circuit wiring to be included in the point wiring rates.				
	Each S.B. must have one light indicator.				
	One S.B. can have max.8 switch including 6Amp.Socket.				
	a) One points controlled by one switch.	22	Nos.		
	b) Two points controlled by one switch.	8	Nos.		
	c) Wall fan point controlled by one 6Amp.Modular switch & switch board at SB level and 6 AMP.3 pin socket at designed.	10	Nos.		
	d) 6Amp. Socket with switch at switch board places.	6	Nos.		
	e) Call bell point with anchor make buzzer.	1	Nos.		
	f) Strong room point with 2x4.0 + 1x1.5Sq mm wiring in conduit including 25 amp. Double pole MCB. From DB to Strong Room. The cable have 16 Amp.3 pin plug at both ends having industries socket of 16 Amp. And outside and outside of strong room for light connection.	1	Nos.		
	g) Sign board point with 2x2.5 + 1x1.5Sq mm wiring in pvc conduit.	1	Nos.		
2	Same as serial no.1, but circuit wiring (Phesh, Neutral & Earth) independent starting from UPS DB to point control box/switch box. (For emergency light)				
	a) One points controlled by one switch.	5	Nos.		
3	<b>POWER POINTS</b>				
	Same as serial no.1, but Wiring for 16 Amp- 6-pin sockets by using 4sq.mm. PVC insulated copper conductor wire with independent 2.5sq.mm.earth wire from DB to first 1st. socket and 1 <sup>st</sup> socket to 2nd socket with 2.5 sq.mm.and 1.5sq.mm.earth wire including providing and fixing complete in all.				
	a) Power point with 4.0sq.mm. copper conductor wires	3	Nos.		
4	<b>A.C. POINTS</b>				





	i) A.C. point wiring 2x4 sq.mm copper conductor & 1x2.5 sq.mm copper conductor from AC DB to AC point in 16 swg GI conduit ac point including supplying and fixing of metal AC box with 3 pin metal clade top and 32/25 amp SPMCB "C" series.	4	Nos.		
<b>5</b>	<b><u>DISTRIBUTION BOARDS:</u></b>				
	P & F sheet metal distribution boards of approved make double door type and making necessary connection etc. complete.				
	ALL MCB'S must be 'C' series , 10 KA Legrand DX3, C&S (win- Brake)				
	a) TPN 4 WAY DB Incomer module:63Amp. 4-P MCB, OUT GOING: 10Amp SP MCB-12Nos, (FOR Lighting )	1	Nos.		
	b) TPN 4 WAY DB Incomer module:100Amp. 4-P MCB. OUT GOING: 32Amp SP MCB-6Nos, 16 Amp SP MCB-6Nos. (FOR Power and AC)	1	Nos.		
	c) S&F 12way SPN DB 1x 40 Amp.DP MCB controlling to 10nos, 10-16Amp.SPMCB (For UPS O/P)	1	Nos.		
	d) S&F 4way SPN DB 2x 40 Amp.DP MCB (For UPS 1/P)	2	Nos.		
<b>6</b>	<b><u>LIGHT &amp; FAN FIXTURES</u></b>				
	P& F light fixtures & accessories as per the following details and making connection, testing & installation with 3 years warranty.				
	Dealer authorization certificate with invoice detail required.				
	a) Philips RC 380B LED Full glow 24" X 24" (6500K)/BAJAJ/OSRAM/HAVELLS	12	Nos.		
	b) Full glow 24" X 24" surface mount LED panel 30W leight (BAJAJ/OSRAM/HAVELLS)	3	Nos.		
	c) Philips Green LEDi 15 Watt DN 194 B (6500K) /BAJAJ/OSRAM/HAVELLS/HPL	10	Nos.		
	d) Wall fans - Crompton/ Bajaj/ Usha WM 400 SDX 120	8	Nos.		
	e)Philips LED Tube lights 18 W/ 22 W (6500K) /BAJAJ/OSRAM/HAVELLS/HPL	5	Nos.		
	f) Exhaust Fans - 300mm dia with frame complete - Crompton/ Bajaj/ Usha	2	Nos.		
<b>8</b>	<b><u>CABLES WIRES:-</u></b>				
	P & F heavy duty armored cable in conduit pipe internally and GI pipe externally with all bends, junction etc. on saddles wherever exposed and crimping the relevant connection ends with aluminum lugs /gland complete.				
	XLPE Cable				
	a) 3.5Core, 35 sq.mm aluminum armored cable (meter to panel)	20	Rmt		





	b) 4x16 sq.mm. AL.armoured cable with 1x8 SWG copper wire in PVC conduit for earthing included cables termination with gland, Al. lugs properly crimped of required size. (Power DB)	30	Rmt		
	c) 4x10 sq.mm. AL.armoured cable with 1x8 SWG copper wire in PVC conduit for earthing included cables termination with gland, Al. lugs properly crimped of required size. ( Panel to UPS, Light DB)	80	Rmt		
	f) 2x6 sq.mm.Cu.wire +2.5 sq.mm. earth wire for UPS O/P including termination with gland, Al. lugs properly crimped of required size.	20	Rmt		
<b>9</b>	<b>UPS POINTS &amp; CIRCUIT:-</b>				
i	P & F ups point in 2mm thick PVC conduit with 2x 2.5 sq.mm. insulated copper wire along with 1x1.5 sq.mm PVC insulated wire for earthing including bends, nipples, junction, M.S. switch boxes each to have 3 nos. 6A5 pin modular socket 1x 6A indicator controlled by 1x6 A modular type switch complete fine finish incl. making necessary connection & start of equipment as per details & drawings. (1 Nos 16 A 5 pin modular socket, 1x 6 A indicator controlled by 1x16A switch near Data Rack.)				
	a) 1st direct point	7	Nos.		
	b) Loop point from first point.	4	Nos.		
<b>10</b>	<b><u>EARTHING</u></b>				
	a) Supplying & installation of pipr-in-pipe technology Gel (Chemical) copper Earth Electrode earthing system. Model T-39 with outer diameter of 80 mm, length 2000mm embedded in the soil with masonry inspection pit along with cover etc. complete in all respect. Each Earth pit installation test certificate to be submitted after measurement of earth resistance as per the provision in IS3043.( ups out DB earthing) .The inspection pit should be visible and at a proper place.	2	Nos.		
	c) P&l 2x8 SWG copper earth wire at designated place in M.S. conduit inside the building.	50	Mtrs.		
<b>11</b>	<b><u>MAIN PANEL</u></b>				
	Designing, manufacturing, installation, testing and commissioning of cubical type MAIN PANEL made from 16 SWG CRCA sheet steel, "I" type base M.S. channel for grouting on floor complete with MCCBs, MCBs, meters, C.T., Etc. complete in all respect, insulates Bus Bar with heat shrinkable PVC sleeve in suitable bus bar chamber, wiring, name plates, danger plates etc and comprising of compartment with hinged doors and rubber	1	Nos.		



	gasket, bus-bar chamber with bolted door and rubber gasket etc. The Panel being of dust and vermin proof construction and to be painted with primer and smoke gray paint ( minimum two coats) to look attractive. The panel should be comprising with the following : ( Degree of protection IP-54) <b>Note: To be procured from CPRI approved manufactures only. The contractor has to submit a copy of CPRI approval of the manufactures. All feeders shall have separate opening / closing door. Panel Should have Earth Bus Bar All MCCB/MCB shall be 'C' Series.</b>				
	<b>A) incomer:</b>				
	125Amp TP MCCB -1 No. (25ka)				
	0-500V CTs -3 Nos.				
	3 Nos. including lamps with fuses -1 set				
	200 Amp 4P copper bus bar - 1 set				
	<b>B) Outgoing :</b>				
	63 Amp 4P Changeover switch -1 Nos.				
	100A 4P MCB - 1Nos.				
	63A 4P MCB - 3Nos.				
	63A DP MCB - 3Nos.				
<b>12</b>	<b>TELEPHONE/ EPABX POINTS</b>				
1	Providing and laying telephone sockets with 2 pair / 4 core telephone cable in 3/4" PVC conduit including all necessary accessories with telephone sockets RJ- 11, boxes base plates etc. complete.	8	No.		
2	S/I/T/C main telephone cable from BSNL DB to EPABX machine (8/10 pair)	25.00	Rmt.		
3	S/I/T/C EPABX machine for 3-main trunk line and 8-extension Telephone intercom system.(CCL, Telesoft, Diplomat)	1	No.		
4	Providing and fixing 20 Pairs TAG box With KRONE connector DOT approved.	1	No.		
<b>13</b>	<b>COMPUTER NETWORKING :</b>				
a	Supply, Laying, Testing & Commissioning of enhanced CAT 6 LAN cable (L & T/D Link/ Siemens sheilded make) in PVC conduit & termination.	480	Rmt.		
b	S/I/T/C of RJ 45 Connector with computer socket outlets of AMP/D-LINK make.	16	No.		
c	Supply and installation of patch cord 1 m lenth	9	No.		
d	Supply and installation of patch cord 2 m lenth	16	No.		
e	SITC of 24 port Jack panel suitable for Cat 6E cable	1	Each		
f	Removing, shifting, servicing, fixing & testing of existing 9U rack & Jack panel	1	JOB		
	<b>TOTAL PART-B</b>				



<b>PART -C : AIR CONDITIONING WORK</b>					
S. No.	ITEM	QTY.	UNIT	RATE (RS.)	AMOUNT (RS.)
1	Supply, installation, testing and commissioning of Supply and handling over of following equipment as per specification Schedule and Drawing at least 3 STAR RATED HIGH WALL MOUNTED INVERTOR SPLIT AC (Hitachi/ Daiken/ Mitsubishi/ O-General/ Blue Star make) unit, each comprising of an out door and single hi-wall mounted indoor unit. Condensing unit shall be complete with hermetically sealed rotary compressor & aircooled condensor with fan evaporating unit shall consist of a fan section with dynamically balanced centrifugal fan driven by FHP motor, multi rows deep cooling coil of copper tubes with aluminium fins, thermostatic expansion valve etc. the evaporating unit shall be equipped with synthetic fiber filter, insulated drain pan safety controls thermostate all complete in a unit Single phase unit with 3 mtr copper pipe. (Machine should be design in 45°C ambient.				
	<u>SPLIT A.C.</u>				
	i) supply of 1.0 TR SPLIT A.C.	2	No.		
2	Providing and fixing Stabilisers for AC 4/5 KVA with 3 step relay and TDR with input voltage range of 140-280 and output to be 230 V.	2	No.		
3	P&F electrical wiring 3core 4sq mm FRLS (Polycab, KEI, Finolex) and refrigerant copper piping duly insulated with elastomeric nitrile rubber tubular insulation (9mm) between each set of indoor/outdoor unit.	80	Rmt.		
4	condensate drain water piping 1" dia p.v.c. duly insulated to nearest drain trap to be laid concealed.	50	Rmt.		
5	Supplying and erection on wall / floor/rooftop and MS stand and cage fixing with minimum six or, more dash fasteners of required size and dia for installation of outdoor condensing units of 50x50x6mm angle frame or as per size of the units. The outdoor units should be fixed with antivibration mounting pads. CAPACITY OF A.C. i. 1.0/1.5/2.0 TR Split outdoor Unit	2	No.		
6	Sifting, installation, testing and gas charging of existing split AC indoor & outdoor units. (for 2.0Tr., 1.5 & 1.0 Tr. Split A/C)	2	No.		
<b>TOTAL (PART-C)</b>					



**SUMMARY OF WORKS**

PART-A :	INTERIOR FURNISHING WORK	
PART-B :-	ELECTRICAL WORK	
PART-C :-	AIR CONDITINING WORK	
	TOTAL AMOUNT OF WORK	



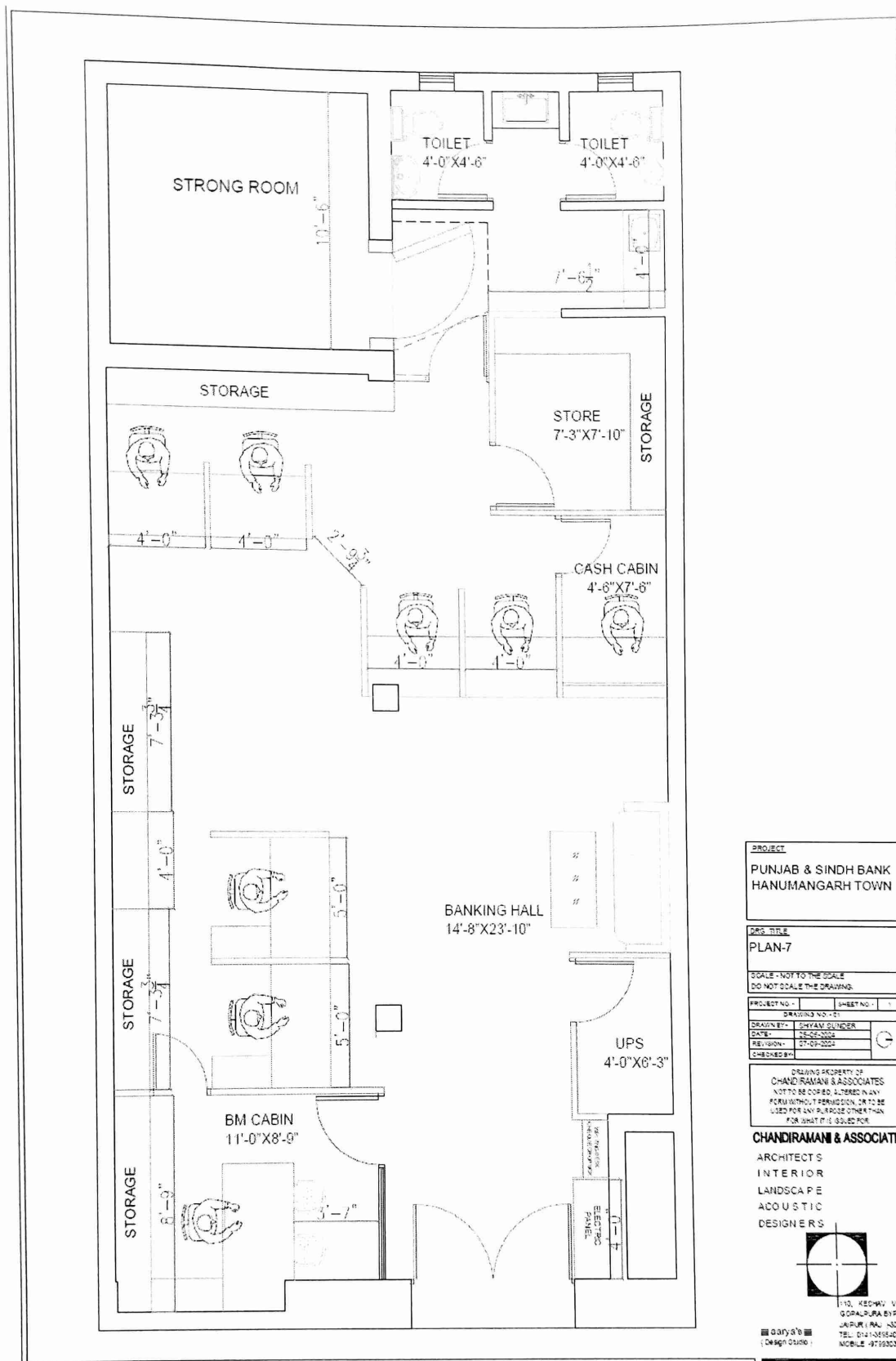

**PROJECT**  
PUNJAB & SINDH BANK  
HANUMANGARH TOWN

**DRG. TITLE**  
PLAN-7

SCALE - NOT TO THE SCALE  
DO NOT SCALE THE DRAWING

PROJECT NO. -	SHEET NO. -
DRAWING NO. -	
DRAWN BY -	CHANDRAMANI
DATE -	28-08-2024
REVISION -	07-09-2024
CHECKED BY -	

DRAWING PROPERTY OF  
CHANDRAMANI & ASSOCIATES  
NOT TO BE COPIED, ALTERED IN ANY  
FORM WITHOUT PERMISSION, OR TO BE  
USED FOR ANY PURPOSE OTHER THAN  
FOR WHAT IT IS ISSUED FOR.

**CHANDRAMANI & ASSOCIATES**

ARCHITECTS  
INTERIOR  
LANDSCAPE  
ACOUSTIC  
DESIGNERS



110, KESHWI VPO  
GOPALPURA BYPASS  
JALPURI (RAJ) - 302  
TEL: 0141-3655402  
MOBILE: 979930371

