

LOW HEIGHT PARTITION	
FULL HEIGHT PARTITION BOTH SIDE MICA	
FULL HEIGHT PARTITION ONE SIDE MICA OTHER SIDE HDHMR CNC CUT	

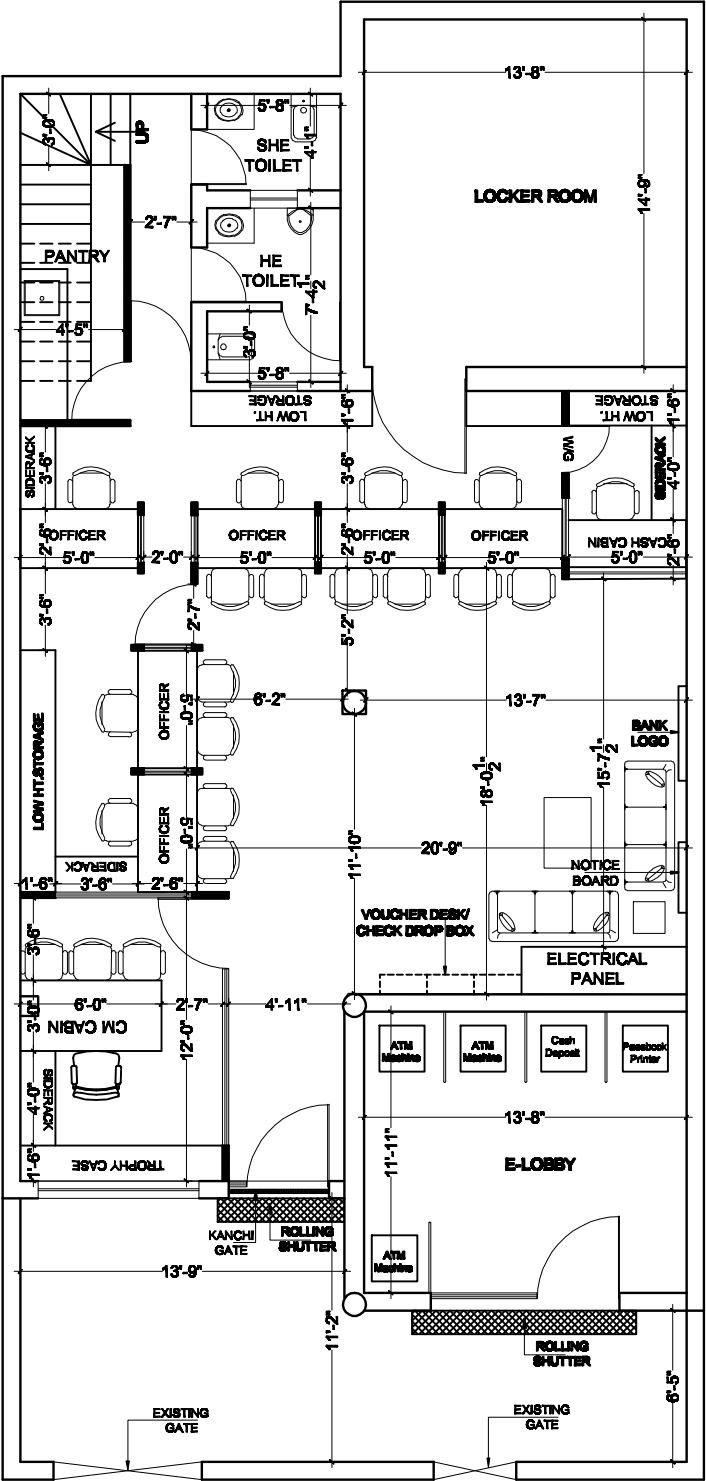

PROPOSED PLAN OF  
PUNJAB AND SIND  
BANK BRANCH AT  
GTB NAGAR,  
JALANDHAR

- ☐ FOR TENDER  
☒ FOR PROPOSAL  
☐ FOR EXECUTION

This drawing is the property of THAPAR ASSOCIATES and shall not be reproduced, copied, loaned, used in any way, or otherwise used for any purpose other than for which it was made.

Note:  
1. Dimensions on the drawing are to be read, not scaled.  
2. Any discrepancy found in the drawing to be immediately clarified with the architect.  
3. All drawings are inter-related and shall be read in conjunction with other drawings

DRAWING NAME  
  
GROUND FLOOR LAYOUT

DEALT:	DIMPLE THAKUR
CHECKED:	SAURASH THAPAR
DATE:	15-10-2024
SCALE:	NTS
LOCATION:	
DRG. NO.	AR-01

PRINCIPAL ARCHITECT  
  
ARL SAURASH THAPAR  
  
ARCHITECTS  
THAPAR ASSOCIATES  
ARCHITECTS, ENGINEERS  
LANDSCAPE ARCHITECTS  
H.NO. 504, PHASE-104,  
GURUPURAN - 151001  
G-75B-00001, 25-000000