



Request for Proposal For

**E-TENDER FOR INTERIOR FURNISHING (ALLIED WORKS) OF
GUWAHATI ZONAL OFFICE ON 4TH FLOOR OF SETHI TRUST
BUILDING AT BHANGAGARH, G.S ROAD GUWAHATI, ASSAM.**

E-TENDER REFERENCE NO: - PSB/ZO/GHY/PREMISES/TENDER/03/2024-25

Date of issue of E-Tender	04.02.2025
Bid Submission Start Date	05.02.2025 after 11:00 AM
Bid Submission End Date	24.02.2025 up to 03:00 PM
Pre- Bid Meeting Date	13.02.2024 at 4.00 PM
Technical bid opening date	24.02.2025 at 03:30 PM
Financial Bid Opening date	Will be informed subsequently to technically qualified bidders.

**Zonal Office: Punjab and Sind Bank, Guwahati,
42 M.G. Road, River Side, Uzan Bazar,
Guwahati-781001, Assam**

ARCHITECT: -

**ARCHIVENTIONS- ARCHITECTS & ENGINEERS,
House No 95 Ground Floor , Lachit Nagar Main Road , Opp. Hari Namghar , Lachit
Nagar Guwahati – 781007 , Assam
Mob: 98540-62928/ 9436017122
Email:-debojyoti@archiventions.com**

E-Tender Document : **INTERIOR FURNISHING (ALLIED WORKS) OF BANK'S GUWAHATI ZONAL OFFICE ON 4TH FLOOR OF SETHI TRUST BUILDING AT BHANGAGARH, G.S ROAD, GUWAHATI-05, ASSAM**

Bid Submission Start Date : **05.02.2025 by 11:00 AM**

Last date of Submission of Tender : **24.02.2025 up to 03:00**

PM Technical bid opening date : **24.02.2025 at 03:30 PM**

Pre- Bid Meeting : **13.02.2024 at 4.00 PM**

Financial Bid Opening date : **Will be informed subsequently to technically Qualified bidders.**

Time of Completion of the Project : **45 days**

The information provided by the bidders in response to this RFP Document will become the property of the Bank and will not be returned. The Bank reserves the right to amend, rescind or reissue this RFP Document and all amendments will be advised to the bidders and such amendments will be binding on them. The Bank also reserves its right to accept or reject any or all the responses to this RFP Document without assigning any reason whatsoever and without any cost or compensation therefor.

This document is prepared by Punjab and Sind Bank for Interior Furnishing (Allied Works) of its Zonal Office on 4th Floor of Sethi trust Building at Bhangagarh, G.S Road, Guwahati, Assam. It should not be reused or copied or used either partially or fully in any form.

Disclaimer

While the document has been prepared in good faith, no representation or warranty, express or implied, is or will be made, and no responsibility or liability will be accepted by Punjab and Sind Bank or any of its employees, in relation to the accuracy or completeness of this document and any liability thereof expressly disclaimed. The RFP is not an offer by Punjab and Sind Bank, but an invitation for bidder's responses. No contractual obligation on behalf of Punjab and Sind Bank, whatsoever, shall arise from the offer process unless and until a formal contract is signed and executed by duly authorized officials of Punjab and Sind Bank and the selected Bidder.

**INTERIOR FURNISHING (ALLIED WORKS) OF GUWAHATI ZONAL OFFICE ON 4TH FLOOR
OF SETHI TRUST BUILDING AT BHANGAGARH, G.S ROAD GUWAHATI, ASSAM**

E-Tender Reference No.	PSB/ZO/GHY/PREMISES/TENDER/03/2024-25
Date of issue of RFP (Request for Proposal)	04.02.2025
Earnest money deposit	<p>Earnest Money Deposit of Rs.60,000.00/- (EMD (Refundable) in the Account Name: - Punjab and Sind Bank Account No.: 80195040070003 IFSC Code: - PSIB0008019</p> <p>#All MSEs having registration as per provisions of the Public Procurement Policy for Micro and Small Enterprises i.e. District Industries Centre (DIC) or Khadi and Village Industries Commission (KVIC) or Khadi and Industries Board (KVIB) or Coir Board or National Small Industries Commission (NSIC) or directorate of Handicrafts and Handlooms or Udyog Aadhaar Memorandum or any other body specified by Ministry of MSME and Start-ups (recognized by DIPP) are exempted from submission of Tender Fee and Bid security declaration only. Relevant certificates should be submitted by the bidder in this regard to avail exemption.</p>
Last date & time of receipts of tender bids	24.02.2025 up to 05:00 p.m.
Opening of Commercial/price bid	Only Eligible Tenderer shall be informed separately
Address of communication	Zonal Office:- Punjab & Sind bank, Guwahati, 42 M.G. Road, River Side, Uzan Bazar, Guwahati Assam-781001
Email address	zo.guwahati@psb.co.in & sumit.kamalapuri@psb.co.in
Contact Telephone	Mr. Sumit Kamalapuri (Manager- Premises Deptt) Mob. 7896536440
Bids to be submitted	https://psb.eproc.in (Bidder has to submit the bid electronically)
Bid Validity Period	6 Months
Estimated Cost	57.50 Lac

Information for online participation

This Tender will follow e-tendering process which will be conducted by bank's authorized e-tendering services provider M/s C1 India Pvt. Ltd. through website: <https://psb.eproc.in>

Following activities will be conducted online through the above website:

1. Procurement of RFP documents including all Annexure
2. Addendums to the RFP
3. Submission of technical bid & indicative commercial bid by the Bidder
3. Opening of technical bid & Indicative commercial bid by the bank
4. Announcement of result if any

Instructions:

1. Bidders who wish to participate will have to register with the website. (<https://psb.eproc.in>). Bidders will be required to create login id & password on their own in registration process.
2. Bidder who wish to participate in this tender need to procure Class-III Digital Signature Certificate (With Both DSC Components, i.e. Signing & Encryption) from any of the licensed Certifying Agency. Bidders can view the list of licensed CA.s from www.cca.gov.in.
3. In case of any clarification/ queries regarding online registration/ participation, Bidders may reach out to: Email: psbsupport@c1india.com
Ph.: 0124-4302033/36/37.
4. It is suggested that the prospective Bidders shall monitor the <https://psb.eproc.in> website constantly for any changes / updates.

Note:

- 1) Bank expects the interested Bidders to download the copy of the complete RFP document along with all Annexures & Appendices either through Bank's website <http://punjabandsindbank.co.in> or <https://psb.eproc.in>

Earnest money deposit of **Rs. 60,000.00/-** EMD (Refundable) should be deposited in the
Account Name: - Punjab and Sind Bank
Account No.: 80195040070003
IFSC Code: - PSIB0008019

- 2) Bank expects the interested Bidders to download the copy of the complete RFP document along with all Annexure & Appendices either through Bank's website <http://punjabandsindbank.co.in> or <https://psb.eproc.in>

NOTICE INVITING E-TENDER OF INTERIOR FURNISHING (ALLIED WORKS) OF BANK'S GUWAHATI ZONAL OFFICE ON 4TH FLOOR OF SETHI TRUST BUILDING AT BHANGAGARH, G.S. ROAD, GUWAHATI-781005, ASSAM

Bank invites E-tenders in Two Bid Systems i.e. Technical Bid & Commercial Bid from **Interior furnishing (Allied Works) of Bank's Guwahati Zonal Office on 4th Floor of Sethi Trust Building at Bhangagarh, G.S Road, Guwahati-781005, Assam.**

In case of any queries, the Tenderer may contact following:

Punjab & Sind Bank: Mr. Sumit Kamalapuri (Manager – ZO Guwahati)

Contact No. : 7896536440

1. INTRODUCTION

Bank invites E-tenders in Two Bid Systems i.e. Technical Bid & Commercial Bid from **Interior Furnishing (Allied Works) of its Zonal Office on 4th Floor of Sethi Trust Building at Bhangagarh, G.S Road, Guwahati-781005, Assam**

2. ELIGIBILITY CRITERIA

The invitation of bids is open to all service providers, provided they fulfil the following eligibility criteria:

CRITERIA	DOCUMENTS REQUIRED AND TO BE UPLOADED
a) The bidder should have at least 5 years satisfactory experience in providing similar works in Scheduled Commercial Banks, Central/State Govt, PSU and Listed Companies. Similar work means interior furnishing/renovation works of same nature/magnitude involving furnishing, electrification, air conditioning works. Contractor should have a registered office in Assam or any NE states for last 5 years	Work order and satisfactory completion certificate (on the letter head of service recipient with complete address and telephone no.) in having executed similar category contract/s (in the city under consideration only) during the last 5 years (minimum) ending day before the invitation of this tender should be provided. The scope of works carried out, period of contract, Staff employed and value of work should be clearly defined. <u>Evidences in form of Few Work Order confirming the firm having the experience of similar nature of works for last 5 or more years</u> <u>Copy of Trade License, Registered/ Notarized Office Rent Agreement as documentary proof for office establishment in Assam or any NE States from last 5 years</u>
b) The bidder should have the following experience for having executed similar works during last five years ending 31.12.2024:- 1. At least One (1) work of value of Rs.46.39 Lakhs 2. Two (2) works of value Rs.Rs.29.00 Lakhs or 3. Three (3) works of value Rs.Rs.23.20 Lakhs and Out of which one work of similar nature of minimum amount of Rs. Rs.23.20 Lakhs should have been executed in Assam or NE States	Work completion certificate should be provided on the letter head of the Organisation where the work has been executed. With Stamp & Sign of the competent authority. Qualifying Work Orders also needs to be submitted along with. Completion Certificate should clearly mention the exact Completion Amount (Base Value) without GST for exact evaluation .
c) The bidder must have an average Annual Turnover of Rs.60.00 Lakhs by way of providing services during the last 5 years in similar contracts ending 30.12.2024.	1. Audited CA certified Profit & Loss statement for financial year 2019-2020, 2020-2021, 2021-2022, 2022-2023 and 2023-2024. 2. Balance Sheet for financial year 2019- 2020, 2020-2021, 2021-2022, 2022-2023 and 2023-2024.
d) The bidder should not be declared by any Public Organization, to be ineligible to participate for corrupt, fraudulent or any other unethical business practice and Blacklisted by Public Organization.	A Self-declaration certificate that the bidder has not been declared by any Public Organization to be ineligible to participate for corrupt, fraudulent or any other unethical business practice and Blacklisted by Public Organization.
	Page 7 of 54

e) The bidder should be registered with the following statutory authorities: - Income Tax, GSTIN.	Photocopies of valid registrations/ license and latest challans should be furnished with the Tender.
f) Bidder should have sufficient resources namely manpower & equipment to execute the subject work.	Full list of sub-contractors/employees viz. Name, Age, employee code, designation, experience in the field etc and also the list of equipment proposed to be deployed as per Annexure D
g) To ensure transparency, equity, and competitiveness in compliance with the CVC guidelines, this tender shall be covered under the Integrity Pact (IP) policy of the Bank. The pact essentially envisages an agreement between the prospective bidders/vendors and the Bank committing the persons/officials of both the parties, not to exercise any corrupt influence on any aspect of the contract.	The IP agreement enclosed at annexure must be Sealed and signed. <i>Any vendor/bidder not signed the document or refusing to sign shall be disqualified in the bidding process.</i>

***Amount mentioned above are excluding GST.**

3. SCOPE OF WORK

The Contractor shall carry out and complete the said furnishing works comprising of wooden partition, paneling false ceiling including miscellaneous, electrical works and modification/addition to existing provision. Provision and Furniture, furnishing etc. complete in every respect in accordance with Contract and with the directions of and to the satisfaction of the Architects and the Bank. The Architects may in their absolute discretion and from time to time, issue further drawings and/or written instructions, details, directions and explanations which are hereafter collectively referred to as "Architect's Instructions" in regard to:

- a) The variations or modifications of the design quality or quantity of works or the addition or omission or substitution of any work.
- b) Any discrepancy in the drawings or between the Schedule of Quantities and/or drawings and/or Specifications.
- c) The removal and / or re-execution or any works executed by the Contractor.
- d) The removal from the site of any material brought there on by the contractor and the substitution of any other material there from.
- e) The dismissal from the works of any person / persons employed thereupon.
- f) The opening up for inspection of any work covered up.
- g) The amending and making good of any defects under clause "Removal of Improper Work and Material".

The Contractor shall forthwith comply and fully execute any work comprised in such Architect's Instructions provided always that verbal instruction, Directions and explanations given to the Contractor or his representative upon the works by the Architects shall, if involving a variation, be confirmed in writing by the Contractor within 3 days and if not dissented from in writing within further 3 days by the Architect. Such shall be deemed to be the Architect's instructions within the scope of the contract. If compliance with the Architect's instructions as aforesaid involved work and/or expense

and/or loss beyond that contemplated by the Contract. Then unless the same were issued owing to some breach of this contract by the Contractors. The Bank shall pay to the Contractor on the Architect's Certificate, the price of the said work (as an extra to be valued as herein after provided) and/or expense and/or loss.

4. TENDER AND BID SUBMISSION

- a) Bids are invited from **Civil & Interior Furnishers/Contractors across India with Registered office / Branch in Assam or any NE States from last 5 Years** and who are eligible to do business in India under relevant Indian Laws as in force at the time of bidding.
- b) Bidders who wish to participate will have to register with the website (<https://psb.eproc.in>). Bidders will be required to create login id & password on their own in registration process.
- c) The bidder will be given permission to inspect the site, with prior appointment and up to one day prior to the last date of submission of the tender.
- d) The Bank shall not consider any request for date-extension for bid-submission on account of late receiving / downloading of Tender by any prospective service provider.
- e) The Bank also reserves the right to amend the tender prior to the last date for bid- submission.
- f) The Bank may at its discretion, extend the last date for bid-submission on any justified ground.
- g) The Bidder shall bear all the costs associated with the preparation and submission of bid and Punjab & Sind Bank will in no case be responsible or liable for these costs, regardless of the conduct or outcome of the bidding process.
- h) The BOQ/ Financial Offer must be filled in Hindi / English and all entries must be made by hand and written in ink. The rate and amount should be in figures and words. If any of the documents is missing or unsigned, the tender may be considered invalid by the Bank Representative in its discretion.
- i) Rates should be quoted both in figures and in words in columns specified. All erasures and alterations made while filling the tender must be attested by initials of the tenderer. Overwriting of figures is not permitted and failure to comply with either of these conditions will render the tender void at the Bank's option. No advice of any change in rate or conditions after the opening of the tender will be entertained.
- j) Each of the Tender documents should be signed by the person or persons submitting the tender in token of his/their having acquainted himself/themselves with the General Conditions of Contract, General Specifications, Special Conditions etc., as laid down. Any tender with any of the documents not so signed will be rejected.
- k) The tenderer must obtain for himself on his own responsibility and at his own expense all the information which may be necessary for the purpose of making a tender and for entering into a contract and must examine the Drawings, inspect the site of the work, acquaint himself with all local conditions, means of access of the work, nature of the work and all matters pertaining thereof.
- l) The rates quoted in the tender shall include all charges for clearing of site before commencement as well as after completion, water, electric consumption, meters, double scaffolding, cantering, boxing,

staging, planking, timbering and pumping out water including bailing, fencing, hoarding, plant and equipment, storage sheds, watching and lighting, by night as well as day including Sundays and Holidays, temporary plumbing and electric supply, protection of the public and safety of adjacent roads, streets. The rates quoted shall be deemed to be for the finished work to be measured at site. The rates shall also be firm and shall not be subject to exchange variations, Labour conditions, fluctuations in railway freights or any conditions whatsoever. **The quoted rates shall not include applicable GST, which shall be paid by Bank in addition to the quoted rates.**

- m) The Contractor should note that unless otherwise stated the tender is strictly on item rate basis and his attention is drawn to the fact that rates for each and every item should be correct, workable and self-supporting. The quantities in the Schedule of Quantities approximately indicate the total extent of work but may vary to any extent and may even be omitted thus altering the aggregate value of the Contract.

5. AUTHORITY TO SUBMIT BIDS

- a) Only authorized personnel of the firm or organization shall sign the Bid.
- b) The proposal must be accompanied with an undertaking letter duly signed by the designated personnel providing a Bid commitment. The letter should also indicate the complete name and designation of the personnel.
- c) In case the principal service providers authorize their business partners to bid on their behalf, a separate authorization letter as per format (Letter of Authorization to bid) enclosed, along with a commitment to fulfil the terms of tender should be submitted.
- d) The certified photocopy of Resolutions/Authority/ Power of Attorney having authority to authorize the person to submit Bid documents on behalf of the company shall be enclosed.

6. BID CONTENTS

6.1 TECHNICAL OFFER TO BE UPLOADED:

- a) The Technical Offer (T.O.) should be completed in all respects and contain full information required in the documents.
- b) It should not contain any price information. It is mandatory to submit the technical details in the prescribed format duly filled in along with the offer.
- c) In case of non-submission or partial submission of technical details, the Bank at its discretion may not evaluate the offer.
- d) The T.O. must be submitted in an organized and structured manner.

6.2 COMMERCIAL OFFER TO BE UPLOADED

- a) The Price quoted should be only in Indian Rupees.
- b) The rates quoted in the Bid shall be inclusive of all labour charges, delivery & cost of material at site tools & equipment, insurance premium covering any risk to labour etc. and taxes except GST
- c) GST shall be paid as per actual
- d) The Bids with correction and or overwriting, if not authenticated, will be liable for rejection.
- e) No claim for rate enhancement/price revision should be considered during the pendency of the contract.
- f) The BOQ/ Financial Offer must be filled in Hindi / English and all entries must be made by hand and written in ink. The rate and amount should be in figures and words. If any of the documents is missing or unsigned, the tender may be considered invalid by the Bank Representative in its discretion.

6.3 EARNEST MONEY (TENDER FEE and EMD):

- a) Earnest Money Deposit of **Rs. 60,000.00/-** EMD (Refundable) should be deposited in the Account Name: - Punjab and Sind Bank
Account No.: 80195040070003
IFSC Code: - PSIB0008019
- b) No interest would be payable on the earnest money deposit amount.
- c) This amount would be forfeited if the bidder withdraws his bids during the period of bid validity.
- d) The earnest money must be submitted along with technical offers.
- e) In the event of non-submission of earnest money deposit, the proposal would be rejected.
- f) EMD would be released to the unsuccessful bidders after signing of the contract agreement by the L1 bidder.
- g) EMD of the successful bidder shall be released after submission of the Performance Bank Guarantee of 5% of Bid Value in the form of FDR/BG/RTGS/NEFT to be deposited to Bank.
- h) MSE bidders are exempted from payment of Earnest Money Deposit (EMD).

7. BID FEATURES

- a) All bids and supporting documentation shall be submitted in English only.
- b) All costs and charges related to the bid shall be expressed in Indian Rupees (in INR) only.
- c) The bids shall be valid for a period of 03 months from the date of submission of bids. A bid valid for a shorter period shall be rejected by the Bank as non-responsive.
- d) The file uploaded on the portal should have the name of document submitted in it.

8. BID ESSENTIALS - CONTENTS OF DOCUMENT TO BE SUBMITTED ELECTRONICALLY

The bidder shall submit the following:

- a) The Bank in case of non-adherence to the Format or partial submission of bid will not evaluate the bid.
- b) Each page of it shall be serially numbered, signed and duly stamped by the bidder or a duly authorized person to sign on behalf of the Service provider,
- c) Any interlineations, erasure or overwriting shall be valid only if these are initialed by the person(s) signing the bid.

APPENDIX TO GENERAL CONDITIONS OF CONTRACT

A	Mobilization Period	7 days from the date of Work Order
B	Date of Commencement of work on site	7 days after the date of Work order
C	Completion Period	45 days from date of commencement
D	Earnest Money Deposit	Rs.60,000.00
E	Performance Bank Guarantee	@ 5% of contract value refundable on virtual completion
F	Retention Money	5% of the payment
G	Defects Liability Period	12 Months from date of Virtual Completion
H	Liquidated Damages for Delay	1% per week up to max. of 10% of Contract value
I	Period of Final Measurement	1 month
J	Period of honouring Interim Certificate	7 working days from receipt of certification of Architect

Signature of Contractors:

Date:

Witness:

INSTRUCTIONS TO BIDDERS

1. Invitation of Bids:

This Request for Proposal (RFP) is to invite proposals from eligible bidders desirous of taking up the project for **Interior Furnishing (Allied Works) of its Zonal Office on 4th Floor of Sethi Trust Building at Bhangagarh, G.S Road, Guwahati-781005, Assam** Sealed offers/Bids (Bid) prepared in accordance with this RFP should be submitted as per details given in the Key Information sheet. The criteria and the actual process of evaluation of the responses to this RFP and subsequent selection of the successful bidder will be entirely at Bank's discretion.

2. Due Diligence:

The Bidder is expected to examine all instructions, forms, terms and specifications in this RFP and study the RFP document carefully. Bid shall be deemed to have been submitted after careful study and examination of this RFP with full understanding of its implications. The Bid should be precise, complete and in the prescribed format as per the requirement of this RFP. Failure to furnish all information required by this RFP or submission of a Bid not responsive to this RFP in each and every respect will be at the Bidder's own risk and may result in rejection of the Bid and for which Punjab and Sind Bank shall not be held responsible.

Photocopies of relevant documents/ certificates duly stamped and signed by authorized person, must be submitted as proof in support of the claims made. The Bank reserves the right to verify/ evaluate the claims made by the Bidder independently. The decision of the Bank in this regard shall be final, conclusive, and binding upon the Bidder.

TECHNICAL BID TO BE UPLOADED:

- a) Service Provider's Profile (Annexure A) to be uploaded.
- b) All pages of bid document must be signed and stamped.
- c) Earnest Money Deposit (EMD) of Rs.60,000.00/-
- d) Copy of satisfactory performance certificate of min. amount of below mentioned work on letter head of organization where the work has been executed duly signed and stamped by the competent authority –
 - i. At least One (1) work of value of Rs.46.39 Lakhs or
 - ii. Two (2) works of value Rs.Rs.29.00 Lakhs or
 - iii. Three (3) works of value Rs.Rs.23.20 Lakhs

Out of which one work of similar nature of minimum amount of Rs.Rs.23.20 Lakhs should have been executed in Assam.

***Amount mentioned above are excluding GST.**

- e) Audited Profit and Loss Account and Balance sheet for the financial year ending on 2019-2020, 2020-2021, 2021-2022, 2022-2023 and 2023-2024.
- f) Letter of Authorization to Bid.
- g) Power of Attorney (if any).
- h) List of contracts executed during last 5 years. (Annexure B).
- i) Past Performance (Annexure C).

- j) Organizational Setup - Details of key skilled, semi-skilled and unskilled workers employed (Annexure D)
- k) Details of Litigation/Arbitration (Annexure E)
- l) Latest I.T.R. of FY 2023-24
- m) Copy of Certificate of Incorporation (If Applicable)
- n) Copy of Memorandum of Association & Articles of Association (If Applicable)
- o) Copy of GST Certificate
- p) Copy of PAN Card
- q) Copy of PF Registration (If Applicable)
- r) Copy of ESI Registration (If Applicable)
- s) A Self-declaration certificate that the bidder has not been declared by any Public Organization to be ineligible to participate for corrupt, fraudulent or any other unethical business practice and Blacklisted by Public Organization.
- t) Other information - Any other relevant information, which is necessary to be furnished, must be provided.

3. BID EVALUATION

- a) The tenders received within the due date and time only will be considered for evaluation.
- b) The Technical bids shall be opened and the bid/s received will be scrutinized to determine whether they are complete in all respects as per the requirement of tender and subsequent clarifications, whether the documents have been properly signed and whether items are offered as per these tender requirements.
- c) The Bank will examine the bids to determine whether they are complete, whether any computational errors have been made, whether required information have been provided as underlined in the bid document, whether the documents have been properly signed, and whether bids are generally in order.
- d) Technical bids of the service providers meeting the minimum pre-qualification criteria will be evaluated for compliance of other terms and conditions.
- e) Based on the evaluation results, the bank will shortlist the bidders who are considered to be suitable. The decision of the Bank regarding the short-listing of the bidders shall be final and binding on the bidder.
- f) The commercial bids of only the successfully qualified bidders whose Technical bids are found acceptable will be opened subsequently on the date that will be conveyed to them.
- g) Arithmetical errors will be rectified on the following basis. If there is a discrepancy between unit price and the total price that is obtained by multiplying the unit price and quantity, the unit price shall prevail and total price shall be corrected. If the supplier does not accept the correction of the errors, its bid will be rejected.
- h) If there is discrepancy between words and figures, the amount in the words will prevail.
- i) The L1 bidder will be determined on the basis of the evaluation method as detailed in the next clause.
- j) **No discount should be given while submitting the price bid. Discount offered if any shall be liable for rejection of that bid.**

Any incomplete or ambiguous terms/conditions/quotes will disqualify the offer.

4. CLARIFICATIONS OF BIDS

To assist in the examination, evaluation and comparison of bids the Bank may at its discretion ask the bidder for clarification and response shall be in writing and no change in the price or substances of the bid shall be sought, offered or permitted.

5. NOTIFICATION OF AWARD

The acceptance of a tender, subject to contract, commercial considerations & compliance with all the terms and conditions will be communicated in writing by means of placing order at the address supplied by the bidder in the tender response. Any change of address of the Service provider, should therefore be promptly notified to The Zonal Manager, Punjab & Sind Bank, Zonal Office Guwahati, 42 M.G. Road, River Side, Uzan Bazar, Guwahati-781001 and written confirmation of such notification obtained.

6. SIGNING OF CONTRACT

The successful bidder shall be required to enter into a contract with PSB within 7 days of the award of the tender/Letter of Intent or within such extended period as may be specified by The Zonal Manager, Punjab & Sind Bank, Zonal Office Guwahati, 42 M.G. Road, River Side, Uzan Bazar, Guwahati-781001.

TERMS AND CONDITIONS OF TENDER

DIRECTIONS REGARDING PROCEDURES

In construing these conditions, specifications and Contract Agreement, the following words shall have the meaning here in assigned to them except where the subject or context otherwise requires:

- (a) **"Bank"** Shall mean **Zonal Office-Punjab & Sind Bank, 42 M.G. Road, Riverside, Uzan Bazar, Guwahati, Assam -781001** and shall include his (their) legal representative/s assign/s or authorized officer.
- (b) **"Contractor/Builder"** Shall mean the individual or firm or company, whether incorporated or not, undertaking the work and shall include legal personal representatives of such individual or the persons comprising such firm or company or the successors of such individual or firm or company and the permitted assignee of such individual or such individual or firm or company.
- (c) **"Architect"** Shall mean _____ whose registered office is situated at _____ (and shall include his authorized representative) or in the event of his death or termination of his services by the Bank in his sole and unqualified discretion, such other person/persons as shall be provided always that no person subsequently appointed to be Architect under this contract shall be entitled to disregard or over rule any previous decision or direction given or expressed by the Architect specified here in unless otherwise approved by the Bank.
- (d) **"Contract"** Means the documents forming the tender and acceptance thereof and the formal agreement executed between the competent authority on behalf of **The Zonal Manager, Punjab & Sind Bank, Zonal Office Guwahati, 42 M.G. Road, River Side, Uzan Bazar, Guwahati, Assam-781001** and the Contractor, together with the documents referred to there in including these conditions, the specifications, designs, drawings and instructions issued from time to time by the Engineer-in-Charge and all these documents taken together, shall be deemed to form one contract and shall be complementary to one another.

The expression **works** or **work** shall, unless there be something either in the subject or context repugnant to such construction, be construed and taken to mean the works by or by virtue of the contract contracted to be executed whether temporary or permanent, and whether original, altered, substituted or additional.

1. GENERAL

- i. The **site** shall mean the land/or other places on, into or through which work is to be executed under the contract or any adjacent land, path or street through which work is to be executed under the contract or any adjacent land, path or street which may be allotted or used for the purpose of carrying out the contract.
- ii. **Schedule(s)** referred to in these conditions shall mean the relevant schedule(s).
- iii. **Tendered Value** means the value of the entire work as stipulated in the letter of award of work.

The work shall be carried out strictly in accordance with the drawings amplified by the specifications of materials and workmanship given hereunder. The drawings and specifications shall be taken together and shall complement each other. In case of any discrepancy, the following order of preference shall be followed:

- a) Particular Specifications.
- b) Drawings.
- c) CPWD Specifications & DSR 2023.
- d) National Building Code and Relevant IS Provisions.

In case there are no specifications for items shown on the drawings or where items are not exhaustively described, the general specifications of CPWD shall be followed for which nothing extra shall be paid. However, the specification should be got approved from the Architect before commencement of work.

2. DRAWINGS AND SPECIFICATIONS

- a) After signing the Contract, the contractor will be given free of charge three prints of all working drawings. The contractor shall make at his own expense any additional copies he requires. One copy of the drawing furnished to the contractor as aforesaid shall be kept by the contractor at site and the same shall at all reasonable times be available for inspection and use by the Architect and his representatives any by any other person authorized by him in writing.
- b) Such further drawings and instructions including revisions, as the Architect may furnish to the Contractor shall form part of this contract.
- c) Only figured dimensions and detailed drawings shall be followed. The Contractor shall verify all dimensions in the field before any work is started and obtain instructions of the Architect in case of any discrepancy.
- d) The Architect with approval of the **The Zonal Manager, Punjab & Sind Bank, Zonal Office Guwahati, 42 M.G. Road, River Side, Uzan Bazar, Guwahati, Assam-781001** shall have power and authority to supply to the Contractor from time to time during the progress of the work, such further drawings and instructions as shall be necessary for the purpose of proper and adequate execution and maintenance of work and the Contractor shall carry out and be bound by the same.

3. SCHEDULE OF QUANTITIES:

The Schedule of Quantities unless otherwise stated shall be deemed to have been prepared in accordance with the method of measurements specified in the particular specifications and shall be considered to be approximate. The Bank does not undertake to carry out the whole of work as shown in the drawings and taken in the schedule of quantities and reserves the right to modify the same or any part thereof. The Contractor shall not be allowed any compensations or damages for the work so omitted or cancelled by the Bank. Each tender item should be filled in with the rates and amounts in separate columns and all the sections should be totaled up in order to show the aggregate value of the entire tender. The rates should be filled both in figures and words for each item and in case of discrepancy the rates filled in words shall be considered as correct for the evaluation of tender amount. The initials of the tenderers shall duly attest all corrections in the tender Schedule. Corrections, which are not attested, may entail the rejection of tender.

4. ARCHITECTS STATUS AND DECISIONS

(a) Status:

The Architects shall have general supervision and direction of the work. He has authority on behalf of the Bank to stop the work whenever such stoppage may be necessary to ensure the proper execution of the work. The architect shall be the interpreter of the conditions of contract and the judge of its performance.

(b) Decisions:

The Architect shall, within a reasonable time, make decisions on all claims of the contractor and on all other matter relating to the execution & progress of the work or the interpretation of the contract documents. The decisions, opinion or direction of the Architects with respect to all or any of the following matters shall be referred to The Zonal Manager , Punjab and Sind Bank, Zonal Office Guwahati and decision so taken shall be final & binding to the contractor.

Variation or modifications of the design:

- i. The quality or quantity of works or the additions/alterations or omissions or substitutions of any work.
- ii. Any discrepancy in the drawings or between the drawings and or specifications.
- iii. The removal and/or re-execution of any work by the contractor.
- iv. The dismissal from the work of any persons employed therein.
- v. The opening up for inspection of any work covered up.
- vi. The amending the making good of any defects under defects liability period.
- vii. Approval of materials and workmanship.
- viii. The contractor to provide everything necessary for the proper execution of the work.

(c) Dismissal:

The contractor shall on the report of the architects immediately dismiss from the works within 24 hours any person employed by him for the above work, who may, in the opinion of Architects be incompetent or misconducts himself and such person shall not be re-employed on the works without the permission of the Architects.

5. EXTENT OF CONTRACT

The contractor shall supply at his own cost all material implements, ladders, cordage, tackle, scaffolding and temporary works required for the proper execution of the work whether original, altered or substituted and whether included in the specifications or other documents forming part of the contract or referred to in these conditions or not and which may be necessary for the purpose of satisfying of conditions he is entitled to be satisfied which he is entitled to require together with carriage therefore to and from the work. The contractor shall also supply survey instruments and other materials necessary for the purpose of setting out works, and counting weighing and assisting to the measurement or examinations at the any time and from time to time of the work material, failing his so doing the same may be provided by the engineer-in-charge at the expense of the contractor and the expenses may be deducted from any money due to the contractor under the contract from his security deposit or the proceeds of sale thereof. The contractor shall also provide a sufficient portion of fencing and lights required to protect the public from accident, and shall be bound to bear the expenses of defence brought by any person for injury sustained owing to neglect of the above precautions and to pay any damage and costs which may be awarded in any such suit, action or proceedings to any such person or which may with the consent of the contractor be paid to compromise any claim by any such person. In no case, the Bank shall be a party to any such claim/claims and the contractor shall indemnify the Bank against any claim for any person on this account.

6. ASSIGNMENT OR SUB LETTING OF CONTRACT

The contractor shall not assign the contract or any part thereof or any benefit or interest therein or there under or any claim arising out of the contract to any other party without the prior written consent of the Bank.

7. CONTRACTORS OFFICE AND STORES

All offices, sheds and stores required by the contractor shall be enacted at his own cost with the prior approval of the Bank or its representative and shall be dismantled and removed upon the completion of the work if so directed within 7 (seven) days of the issue of such intimation.

8. DIRECTION FOR EXECUTION OF WORK

8.1 Setting Out

The contractor shall be responsible for the true and proper setting out of the works in relation to the original points, lines and levels of reference given by the architect in writing and for correctness subject as above mentioned of all the positions, levels dimensions and alignments of all parts of the work and for the provision of all necessary instruments, appliances and labour in connection there-with. If at any time during the progress of the work any error shall appear or arises in any part of the work, the contractor on being required to do so by The Zonal Manager, Zonal Office Guwahati shall at once inform the architect or their representatives. The checking of the work by the architect/representative shall not in any way relieve the contractor from his responsibilities of carrying out the work as per the best practices of construction.

8.2 Engagement of Labour

- a) The contractor shall be solely responsible for the labour/ personnel employed and that the personnel provided by the contractor shall and will not make any claim to become employees of the Bank and that there will be no Employee and Bank relationship between the personnel engaged by the Contractor and the Bank.
- b) The contractor shall employ labour in sufficient numbers either directly or through subcontractors, where such subletting is permitted to maintain the required rate of specified in the contract and to the satisfaction of the architect. The contractor shall not employ in connection with the works any person who has not completed his fifteen years of age.
- c) The contractor shall comply with the provisions of the payment of Wages Act, 1936; Minimum Wages Act, 1948; Maternity Benefit Act, 1961 and Mines Act, 1938, Labour Contract (Regulations & Abolishing) Act, 1970 or Rules, or any modifications thereof and any other law relating thereto and rules made there under time to time.
- d) The Contractor shall be fully responsible for timely monthly payment of wages and any other dues to the personnel deployed by the Contractor. Further the Contractor shall solely be responsible for having made the payments towards ESI and EPF amount (both Banks and employee's contribution) in the respective account of the worker for the period for which bill is raised.
- e) The contractor shall indemnify the Bank against any payment to be made under and for observance of the Regulation aforesaid without prejudice to his right to claim indemnity from his sub-contractors.
- f) The contractor shall provide and maintain at his own expenses all rights, guards, fencing and watching when and where necessary or required by the Resident Engineer for the protection of the works or for the safety and convenience of those employed on works or the public.

8.3 Sampling

- a) The contractor shall submit the samples of various materials for the approval of the Architect & Bank. The contractor shall use the material only after the approval of the Architect/ Bank. The verification of the material shall be done on random base during the progress of the work in either the following manner:
- b) Random samples would be picked up during execution of work from site & if decided by the Architect/ Bank, it would be sent to one of the approved laboratories for test & quality check. The cost of such tests would be borne by the client.
- c) The Architect/Bank may direct the contractor to submit the challan of delivery of the material brought at site. It would be on Random based. The Architect may also direct the contractor to submit the copy of the test/verification certificate provided by the manufacturer of that particular material.

8.4 Inspection of work

All work under or in course of execution or executed in pursuance of the contract shall at all times be open to inspection and supervision of the Architect or his representative and to the personnel and the representatives of the Bank and the contractor shall at all times with reasonable notice or the intention of the Architect or his representatives to visit work shall have been given to the contractor, either himself be present to receive orders and instructions, or have responsible agent duly accredited

in writing present for that purpose. Orders to the contractor's agent shall be deemed to have been given to the contractor himself.

8.5 Suspension of Work

The contractor shall on the written order of the Architect/Bank suspend the progress of the work or any part thereof for such time or time and in such a manner as the Architect/ Bank may consider necessary and shall during such suspension properly protect and secure the work as considered necessary in the opinion of the Architect/ Bank or their representative-in-charge of the work. No compensation shall be payable to the contractor on what so ever account for the suspension of work.

8.6 Extension of time for completion

Time is the essence of the contract. The owner and the contractor in consultation with the Architects shall agree upon the work progress chart. The chart shall be prepared in direct relation to the time stated in the contract or the works order for completion of the individual items thereof and/or the contract or works order as a whole. It shall indicate the forecast of the dates of commencement and completion of the various trade processes or sections of the work and shall be amended as may be required by agreement between the architects and the Contractor within the limitations of time imposed in the contract. If the works be delayed:

- a. By force majeure, or
- b. By reasons of abnormally and bad weather
- c. By reason of serious loss or damage by fire or
- d. By reason of civil accommodation local combination of workmen or strike or lockout effecting any of the trades employed on the work or
- e. By reason of delay on the part of contractor or trade men engaged by the owner in executing works not forming part of the contract or
- f. By reason of proceeding taken threatened by or dispute with adjoining or neighboring owners or public authorities arising otherwise, then through the Contractor's own default, or
- g. By reason of any other cause which in the absolute discretion of Owner is beyond contractor's control then in any such case the owner may make fair and reasonable extension after obtaining Architect's advice in the completion dates of individual items or groups of items of work for which separate periods of completion are mentioned in the contractor or works order as applicable.
- h. Upon the happening of any such event causing delay, the contractor shall immediately give the notice thereof in writing to the architects with a copy to Bank but shall nevertheless use constantly his best Endeavour to prevent or make good the delay and shall do all that may reasonably be required to the satisfaction of the Architect/Bank to proceed with the works
Extension of time shall be granted.

8.7 Defacement

If the contractor or his work people, or servants shall break, deface, injure, or destroy any part of a building, or interiors, then the contractor has to rectify the same part at his own expenses to the satisfaction of the Architect/ Bank's in charge engineer.

8.8 Approval of Materials

The contractor would bring samples of necessary materials as per the directions & would get them approved prior to execution of work from Architect.

9. LIQUIDATED DAMAGES FOR DELAY

The times and date stipulated in the contract for the completion of the work or any part or stage thereof shall be deemed to be the essence of the contract. The work shall, throughout the stipulated period of the contract, be carried out with all diligence. If the contractor fails to complete the work within the time prescribed or within the extended time under the contract, he shall pay to the Bank on demand amount without prejudice to other rights and remedies the Bank may have against the contractor, **1% of contract price per week** or part thereof as liquidated damages for such fault, if the work remain unfinished after the stipulated date of completion provided that the total liquidated damages payable shall not exceed 10% of the accepted contract price. The Bank may, without prejudice to any other method of recovery, deduct the amount of such damages from any money due or which become due to the contractor. The recovery or deduction of such damages shall not relieve the contractor from any obligations and liabilities under the contract.

10. DEFECTS LIABILITY PERIOD

The contractor shall be responsible to make good and remedy at his own expense within such period as may be stipulated by the Bank any defect which may develop or may be noticed before the expiry of 12 (twelve) calendar months from the date of completion and intimation of which has been sent to the contractor within seven days of the expiry of the said period. Total of 5% of the contract value shall be retained by the bank up to the completion of defect liability period. In case the contractor fails to respond to the bank notification in sufficient time for repair (if any) the above retention money shall be utilized by the bank for such repairs under intimation to the contractor.

11. SECURITY DEPOSIT

- a) The Bank will, at the time of making any payment to the contractor for work done or supply made under the contract deduct 5% of Gross value of each bill up to 5% of contract value.
- b) All compensations or other sums of money payable by the contractor to the Bank in terms of this contract may be deducted from, or paid by, the sale of a sufficient part of his security deposit, or from any sums which may become due to the contractor by the Bank on any account whatsoever, and in the event of his security deposit being reduced by reason of any such deduction or sale as aforesaid, the contractor shall within ten days. Thereafter make good in demand draft, endorsed in favour of the Bank as aforesaid any sum or sums which may have been deducted from, or raised by sale of his security deposit or any part thereof.
- c) The above said security deposit shall be liable to forfeiture wholly or in part at the sole discretion of the Architect & Bank, if the contractor fails to carry out the work or perform or observe any of the conditions of the contract.
- d) No interest would be payable by the Bank to the contractor on the security held in deposit.

12. BILL PAYMENT

- a. Final bill supported with consolidated measurement of the full work executed shall be submitted by the contractor within 30 days from the date of issue of certificate of virtual completion.
- b. Architect/Bank or his representative shall verify the requisite measurement for the purpose of having the same verified for the claim as far as admissible.

- c. All measurements to be taken in duplicate and all bills shall be submitted in triplicate along with a contractor's copy of each.
- d. When the final bill has been verified and corrected, the architect will give seven days' notice to the contractor to countersign the bill in token of acceptance, the contractor shall counter-sign the bill within the above seven days or intimate in writing his intention to dispute.
- e. If the contractor fails to take appropriate action as above within the period prescribed, the bill finalized by the architect or his representative shall be final and binding on the contractor and the contractor shall have no right to dispute the same.

13. CLAIM FOR INTEREST

No claim for interest will be entertained by the Bank with respect to any moneys or balances which may be in its hands owing to a dispute between itself and the contractor or with respect of any delay on the part of the Bank in making interim or final payments or otherwise.

14. RATES FOR EXTRA ADDITIONAL, ALTERED OR SUBSTITUTED WORK

The rates for additional, altered or substituted work shall be worked out in accordance with the following provisions in their respective order

- a. If the rates for similar additional, altered or substituted work and directly available in the contract for the work, the contractor is bound to carry out the work at the same rates as are available in the contract for the work.
- b. If the rates for additional, altered or substituted work are not directly available in the contract for the work the rates will be derived from the rates for a similar class of work as are specified in the contract for the work.
- c. If the rates for the altered, additional or substituted work cannot be determined in the manner specified in sub-clause (i) to (ii) above, then the contractor shall within three days of the date of receipt of order to carry out the work, inform the Architect of the rate which it is intending to charge for such works supported by analysis of the rate or rates claimed (CPWD analysis). Rates finalized and approved by the Architect on the basis of these details will be final and binding. However, the architect by notice in writing will be at liberty to cancel his order to execute such work and arrange to carry it out in such a manner as he may deem advisable, but under no circumstances shall the contractor suspend the work once ordered in writing on the plea of non-settlement of rate.
- d. In case of furniture items, the minor changes and modifications in the design shall not be considered as deviation, and no price adjustment shall be made against the rates agreed to as per the Schedule of Quantities of the contract. For major change in the design of any item of the furniture, the deviation shall be priced by the Architects as Extra, as per above however the decision of the Architects whether the charge / modification in the design of furniture items is minor or major, shall be final and binding on the contractor.

14.1 REIMBURSEMENT OF VARIATION IN PRICE

Prices and rates quoted by the Tenderers shall be considered as confirmed for the complete work and entire duration of the contract. No claim for extra payment due to any rise in rates of raw material and labour or due to whatsoever reasons shall be considered, not even for extended period of completion.

15. GUARANTEES

15.1 Quality of Work

- a. The contractor shall guarantee that the materials and workmanship are the best of their respective kinds for the service intended and that all items of work will be free from all inherent defects in workmanship and materials. He shall also guarantee that the works will not fail in any respect due to quality of materials, workmanship and methods of construction.
- b. The specifications assume a proper degree of skill on the part of contractor and workmen employed. The contractor shall consult the Architect or his representative, whenever in his judgment variation in the methods of construction or in the quality of material would be beneficial or necessary to fulfil the guarantee is called for. Such variations may be made by the contractor only when authorized by the architect.

15.2 Rejection

If during the "Period of Guarantee", any work or material shall fail in any respect to meet the above guarantee, the contractor shall replace such work or material in a condition which will meet the above guarantee, immediately.

15.3 Cost of Execution of work or repair etc.

All work of repair shall be carried out by the contractor at his own expense if the necessity thereof shall in the opinion of the Architect be due to the use of materials or workmanship not in accordance with the contract or on account of neglect or failure on the part of the contractor to comply with any obligation expressed or implied on the contractor's part under the contract.

15.4 Remedy on Contractor's failure to carry out the work required:

If the contractor shall fail to do any such work as aforesaid required by the architect the Bank shall be entitled to carry out such work from/through other person, at the contractor's own cost. The Bank shall be entitled to recover from the contractor the cost thereof or may deduct the same from any money due or that may be come due to the contractor.

16. CERTIFICATE OF COMPLETION OF WORKS

On completion of the work, the Contractor shall be furnished with a certificate, but no such certificate be given nor shall the work be considered to have been completed until the contractor shall have removed from the area of the premises (to be distinctly marked by the Architect) in the site plan which, the work shall be executed) all scaffolding, surplus materials and rubbish and clean the dirt from all wood work, doors, windows, walls, floors or other parts of any building, in or upon which the work is to be executed, or of which he may have had in possession for the purpose of the execution hereof. If the contractor shall fail to comply with the requirements of the clause as to the removal of scaffolding, surplus materials and rubbish and cleaning off dirt on or before the date fixed for the completion of the work, the architect may at the expense of the contractor remove such scaffolding, surplus materials, and the contractor shall forthwith pay the amount of all expense so incurred, and shall have no claim in respect of any such scaffolding or surplus materials aforesaid, except for any sum actually realized by the sale thereof.

17. TERMINATION OF THE CONTRACT

- a. If at any time after the commencement of the work the Bank for any reason whatsoever does not require the whole or part thereof as specified in the tender to be carried out, the Bank shall have the right to terminate this Agreement and The PSB shall communicate the termination by giving a notice in writing to the contractor.
- b. The contractor shall have no claim to any payment or compensation whatsoever on account of any profit or advantage, which would have derived from the execution of the work in full, but which he did not derive in consequences the full amount of the work not having been carried out.
- c. The Contractor shall not have any claim or compensation by reason of any alterations having been made in the original specification, or the designs and instruction on which shall involve any containment of the work originally contemplated. However, in case of part cancellation, the Contractor shall be paid such amount as is commensurate to the actual work done by him till such termination notice is received.

18. JURISDICTION & GOVERNING LAW

The contractor and its operation shall be governed by the law of India for the time being in force, irrespective of the place of delivery of materials the place of execution of work or place of payment under this contract shall be deemed to have been entered into New Delhi.

19. BYE-LAWS OF LOCAL AUTHORITIES

The contractor shall conform to the provisions of all applicable Government Acts which relate to works and to the regulations and bye laws of any local authorities. The Contractor shall give all such notices required by the said Act or Laws, etc., and pay all fees payable to such authorities and allow for these contingencies in his tendered rates including fees for encroachment, stacking charges, costs of restorations, etc., and all other fees payable to the local authorities. The Contractor shall keep the Bank indemnified against all penalties and liabilities for every breach of any such Act, Rules, Regulations or Bye-laws.

Further the Contractor shall specifically ensure compliance of various Labour Laws/Acts including but not limited to with the following and their re-enactments/amendments/modifications while dealing with the employment of labour such as:

- i) The Payment of Wages Act, 1936
- ii) The Minimum Wages Act, 1948
- iii) The Workmen Compensation Act, 1923
- iv) The Contract Labour (Regulations & Abolishing) Act, 1970.
- v) Industrial Dispute Act, 1938
- vi) Maternity Benefit Act, 1961
- vii) The Employees State Insurance Act, 1948

Safety code, labour welfare Act or rules or any modification thereof any other laws and regulations framed by the Competent Legislative Authorities from time to time.

20. LIASONING & CO-ORDINATION WITH LOCAL MUNICIPAL AUTHORITIES

The contractor has to liaison and takes any clearance from local authorities Fire/ Police or any other authorities for approval to start renovation and during renovation of work including Defect Liability Period if needed. Only statutory fees will be reimbursed by PSB.

21. TAXES/ DUTIES/ INSURANCE/ PATENT/INDEMNITY

1. Compliance with Statutes, regulations etc.

The contractor shall conform to in all respects with the provisions of any such statute, ordinance or law as aforesaid and the regulation or Bye - laws of any local or other duly constituted authority prevailing , which may be applicable to the works or to any Temporary works and with such rules and regulations of public bodies and companies as aforesaid and shall keep the Employer indemnified against all penalties and liability of every kind for breach of any such statute , ordinance or law , regulation or bye-law. Provided always that the Employer will repay or allow to the contractor all such sums as the Architect shall certify to have been properly payable and paid by the contractor in respect of such fees, after due verification of the documents.

2. Patents Rights & Royalties

The contractor shall save harmless and indemnify the Bank from and against all claims and proceedings for or on account of infringement of any patent rights , design trade mark or name or other protected rights in respect of any constructional plant , machine work or material used for or in connection with the works or temporary works or any of them and from against all claims , demand, proceedings , damages , costs, charges and expenses whatsoever in respect thereof or in relation thereto. The contractor shall pay all tonnage and other royalties , rent and other payments or compensation (if any) for getting stones, sand gravel, clay or other materials required for the works or Temporary works or any of them.

3. Taxes, Works contract Tax for works etc.

The contractor shall pay and be responsible for payment of all taxes, duties, levies, fees or charges in respect of the works including, Tax on works contract, and Octroi, payable in respect of materials, equipments, plant and other things required for the contract. All of the aforesaid taxes, duties, levies, fees and charges shall be paid by the contractor's account and Employer shall not be required to pay any additional or extra amount on this account. Variation of the taxes, duties, levies, fees etc. if any till completion of the work, shall be deemed to be included in the accepted rates excluding GST and no extra claim on this account will in any case be entertained.

4. Taxes on Profit

The contractor will be required to pay all taxes levied by the central and / or state Bank on such part of his profit in respect of the contract as is chargeable therewith under the laws for the time being in force.

5. Indemnifying Bank from any claims/actions

The contractor shall fully indemnify and keep indemnified the Bank against any action, claim or proceeding relating to infringement or use of any patent or design or any alleged patent or design rights and shall pay any royalties which may be payable in respect of any article or part thereof included in the contract. In the event of any claims made under or action brought against Bank in respect of any such matters as aforesaid , the contractor shall be notified within a reasonable time hereof and the contractor shall, at his own expense to settle any dispute or to conduct any litigation that may arise there from.

6. DAMAGE TO PERSONS AND PROPERTY, INSURANCE, ETC.

The Contractor shall be responsible for all injury to the work or workmen persons, animals or things and for all damages to the structural and/or decorative part of property which may arise from the operation or neglect of himself or of any sub-Contractor or of any of his or a sub-Contractor's employees, whether such injury or damage arise from carelessness, accident or any other cause whatsoever in any way connected with the carrying out of this contract. The clause shall be held to include entirely, any damage to buildings whether immediately adjacent or otherwise, and any damage to roads, streets, foot-paths or pathways as well as damage caused to the buildings and the work forming the subject of this contract by rain, wind or other inclemency of the weather. The Contractor shall indemnify the Employer and hold them harmless in respect of all and any expenses arising from any such injury or damages to persons or property as aforesaid and also in respect of any claim made in respect of injury or damage under any acts of compensation or damage consequent upon such claim the Contractor shall reinstate all damage of every sort mentioned in this clause, so as to deliver the whole of the contract work complete and perfect in every respect and so as to make good or otherwise satisfy all claims for damages to the property of third parties.

The Contractor shall obtain a policy covering under Workmen compensation Act, a third party insurance as well as any other insurance and indemnify the employer entirely from all responsibilities in this respect. The insurance must be placed with a company approved by the Employer and must be effected jointly in the name of the Contractor and the Employer and the policy lodged with the latter. The scope of insurance is to include damage or loss to the contract itself till this is made over in complete state.

Insurance is compulsory and must be affected from the very initial stage. The Contractor shall also be responsible for anything which may be excluded from damage to any property arising out of incidents, negligence or defective carrying out of the Contractor.

7. INSURANCES

Unless otherwise instructed the Contractor shall insure the entire work including all materials, etc. to the full value of the contract, and keep the same insured until the virtual completion of the contract against loss or damage by fire and/or earthquake, flood or damages from whatever cause.

The insurance is to be at the Contractor's own cost & must be placed with a company approved by the employer, in the joint names of the Employer and the Contractor for such amount. If any further insurance, over and above what is stated above is called to be made by the employer, the premium of such further sum shall be allowed to the Contractor as an authorized extra.

The Contractor shall deposit the policy and receipt for premium paid with the Employer within 10 (ten) days from the date of issue of work order unless otherwise instructed. In default of the Contractor insuring as provided above, the Employer on his behalf may so insure and may deduct the premier paid from any money due, or which may become due to the Contractor. The Contractor shall, as soon as the claim under the policy is settled or the work reinstated by the Insurance company should they elect to do so, proceed with due diligence with the completion of work in the same manner as though the incident had not occurred at all.

The Contractor in case of rebuilding or reinstatement after fire, and any other risk or risks mentioned in the above paragraph shall be entitled to extension of time for completion as the Employer may deem fit.

8. Insurance against third party risks:

On commencement of the work, the contractor shall take out and submit to the Employers a suitable insurance policy against third party risks. The limits of liability of this insurance shall be as follows:

- a) Contractor's All Risk 'CAR' policy for the value of contract price and necessary workmen compensation policy valued for the duration of work.
- b) Rs.25 Lakhs in respect of any one accident or series of accidents arising out of one event.
- c) Contractor shall take out third party insurance for 3 no. of such accidents with Rs.10,00,000/- (Ten lakhs) in respect of any person.

SPECIAL CONDITIONS OF THE CONTRACT

1. INSURANCE FOR WORKS

- a) The contractor at the time of signing the contract or before commencing the execution of work, without limiting his obligations and responsibilities shall insure the works at his own cost and keep them insured until the virtual completion of the contract against all acts of God including Fire, Theft, Riots, War, Floods etc. with a Nationalized Insurance company in the joint names of the Bank and the contractor (the name of the former being placed first in the policy) for the full amount of the contract. Such policy shall cover the property of the Bank and fees for assessing the claim and in connection with the services generally therein and shall not cover any property of the Contractor or of any sub-contractor or employee.
- b) The contractor shall deposit the policy and receipt for the premiums with the Bank within seven (7) days, from the date of signing of the contract/commencement of the execution of the work or unless otherwise instructed by the Bank. In default of the contractor insuring as provided above, the Bank on his behalf may so insure and may deduct the premiums paid from any moneys due on which may become due to the contractor. The contractor shall as soon any claim under the policy is settled on the work reinstated by the Insurance office should elect to do so, proceed with all due diligence with, the completion of the works in the same manner as through the misfortune/accident had not occurred and in all respects under the same conditions of the contract. The contractor in case of rebuilding or reimbursement after accident shall be entitled to such extension of time for completion, as the Bank deems fit.

2. INSURANCE IN RESPECT OF DAMAGE TO PERSONS AND PROPERTY

- a) The contractor shall be responsible for all injury to persons, animals or things and for all structural and decorative damage to property which may arise from the operation or neglect of himself or of any approved sub-contractor's or employees, whether such injury or damage arise from carelessness, accident or any other cause whatsoever in any way connected with the carrying out of this contract. The clause shall be held to include any damage to buildings, whether immediately adjacent or otherwise, and any damage to roads, streets, foot paths, bridges and works forming the subject of this contract by frost or other inclemency of the weather. The contractor shall indemnify the Bank and hold him harmless damage to persons or property as aforesaid and also respect of any claims made in respect of injury or damage under any Acts of Government or otherwise and also in respect of any award of compensation of damages consequent upon such claims.
- b) The contractor shall reinstate all damages of every sort mentioned in this clause, so as to deliver up the whole of the contract works complete and perfect in every respect and so as to make good or otherwise satisfy all claims for damage to the property of third parties.
- c) The contractor shall indemnify the Bank against all claims which may be made against the Bank by any member of the public or other third party in respect of works in consequence thereof and shall at his own expense arrange to effect and maintain, until the virtual completion of the contract, with any Nationalized Insurance company in the joint name of the Bank and the contractor against such

risks and deposit such policy or policies with the Bank from time to time during the currency of this contract. The contractor shall similarly indemnify the Bank against all claims which may be made upon the Bank whether under the Workman's Compensation Act or any other statute in force during the currency of this contract or at common law in respect of any employee of the contractor or any sub-contractor and shall at his own expenses effect and maintain with an approved office a policy of Insurance in the joint names of the Bank and the contractor against such risks and deposit such policy of policies with the Bank and the contractor against such risks and deposit such policy or policies with the Bank from time to time during the currency of the contract. The contractor shall be responsible for anything which may be excluded from the insurance policies above referred to and also for all other damages to any property arising out of and incidental to the negligent or defective carrying out of this contract. He shall also indemnify the Bank in respect of any costs, charges or expenses arising out of any claim or proceedings and also in respect of any award of or compensation of damages arising there from.

- d) The Bank shall be at liberty and is empowered to deduct the amount of any damages, compensation costs, charges and expenses arising or occurring from or in respect of any such claim or damage from any sum or sums due to or become due to the contractor including the security deposit.
- e) If the contractor fails to comply with the terms of these conditions, the Bank may insure the works and may deduct the amount of the premiums paid from any moneys that may be or become payable to the contractor or may at the option, not release running payment to the contractor until the contractor shall have complied with the terms of this condition.
- f) Such insurance whether affected by the Bank or the contractor will not limit or bar the liability and obligation of the contractor to deliver the works to the Bank completed in all respects according to the contract. In case of loss or damage due to any of the aforesaid clause, the moneys payable under any such insurance shall be received and retained by the Bank until the works are finally completed and such moneys shall then be credited to the contractor in final settlement of accounts.
- g) The works shall be executed in close co-ordination with the progress of other work. This being absence of the contract, no claim for idles labour will be entertained.

3. TYPOGRAPHIC OR CLERICAL ERRORS:

The Architect's/Engineer-in-Charge's clarifications regarding partially omitted particulars or typographical or clerical errors shall be final and binding on the Contractor.

4. ACCEPTANCE OF TENDER: - On acceptance of tender, the Bank shall issue a Letter of Intent (LOI) and shall enter into an agreement with 7 days from the issue of LOI. On the contrary, Bank has a right to cancel the order and for fit the EMD.

5. Time shall be regarded as the essence of the contract. The work should be taken up immediately and completed within (as per terms and conditions attached) 45 days from the date of issue of work order.

6. Contractor will be permitted to work normally during the regular working hours i.e. 9 a.m. to 6.00 pm. If the Contractor is required to work at night in order to complete the work within the Time Schedule, the Contractor shall seek written permission from the Bank for the same. Further, the

contractor is liable provide and maintain at his own cost sufficient lights to enable the work to proceed satisfactorily without danger. Approaches to the site also shall be sufficiently lighted by the Contractor. No extra payments will be made for night work. Prior intimation and approval should also be taken from Architect/Consultant. However, no work shall be done on national holidays that may be notified by the Bank without the specific sanction in writing of the Bank.

7. Contractor to coordinate and assist the Architect in obtaining all Statutory approvals including MMC, CFO and any other State and Central rules in force. Any expenses incurred in obtaining such approvals are deemed included in the rates quoted by the Contractors.
8. **MEASUREMENTS OF ALL CONCEALED ITEMS:** Measurements of all concealed items of work and extra item if any, shall be got recorded by the Bank's Architect / Engineer before they are checked up.
9. **CLEANING DURING THE WORK:** The rates quoted shall include cleaning of ceiling roses, electric switches, boards, window panes etc. after the repairing leaving the site neat and tidy from time to time.
10. The contractor shall note that they should bring to the notice of the Architect/Engineer any breakage in glass window before starting work. However, if any glass window is found to be broken during the repairing work, the contractor at his own cost shall replace the same.
11. **ABANDONMENT OF WORK:** If in any case the work required to be abandoned, the contractor shall not be entitled for any claims and he will be paid as per the actual work done till that period.
12. **For water proofing works** on traces, bathroom, WC, Chhajja, work has to be executed through the agency specialized in waterproofing. Contractor will have to submit a guarantee of 10 years on stamp papers as per the format to be prescribed by the Bank.
13. **RECORDS & MEASUREMENTS:** Measurements shall be taken jointly by Bank's Architect / Engineer and contractor and shall without extra charges provide assistance with appliance; labour and other things necessary for the work and measurements will be signed and dated by both the parties on completion of measurements.
14. **SUPERVISION:** The contractor is required to have on site during all working hours a competent supervisor (acceptable to Bank) who will be responsible for the conduct of worker and who has authority to receive and act on such instructions issued by the Architect / Engineer of Bank.

Contractor shall follow all rules / regulations in force and should possess the license for employing labour and also follow all safety measures, labour bye law and shall be responsible for any lapse.

15. **SAFETY:** The contractor shall carry out the entire work in a workman like manner having full regard for the safety of the men working at site. All safe practices as per CPWD norms shall be strictly adhered to by the workmen of the contractor like wearing helmets, safety belts when working at heights, gloves when handling sharp objects and reinforcement, eye shields during welding, safety shoes, etc. The contractor shall protect sides of openings in floor slabs, edges of slabs, stairs, stairwells etc. with barricades, warning signs / lights and educate all his workmen regarding

following safe working Practices. He shall provide first aid boxes at site. In spite of following safe methods, in case of any unfortunate accident, the contractor shall indemnify the employer against any expenses or claims towards treatment or compensation.

- 16. DAILY DIARY REGISTER:** A daily diary register (with cement and steel stock statement) will be kept in the Engineer's Office or the site office. Details of work for the day proceeding and the diary will be written up every day and jointly signed by the Engineer and the Contractor or their representatives in token of its correctness thereof.
- 17. SITE VISITS:** - The Architect/Consultant /Bank shall visit the site from time to time at their discretion, or when expressly called upon to do so, to co-ordinate various activities and/or to answer such queries that may be posed at site on interior drawings.
- 18. CERTIFICATE OF VIRTUAL COMPLETION:** As soon as the work is completed, the contractor shall in- form in writing such completion to the Bank's Architect/Engineer who will inspect the work and if satisfied will issue the certificate that the work has been virtually completed and the defects liability period shall commence from the date of such certificate.
- 19.** When the work has been virtually completed and Bank's Architect/Engineer has certified in writing that the work has been completed on the basis of detailed measurements and has made a final scrutiny and that there is no dispute items, rates, add quantities, the contractor shall be entitled to the payment of the final bill in accordance with the final certificate which will be honoured within the period specified in the Appendix as period of honouring final certificate.
- 20.** During the pendency of the contract, Bank reserves the right to cancel a part or whole of the order without assigning any reason, on 3 days' notice without any cancellation charges.
- 21.** Site must be cleaned and free from debris before payment of bills.
- 22.** Any loss/damage sustained to the Bank due to any act or omission on the part of the contractor or his men will have to be made good to the Bank by the contractor.

23. FORCE MAJEURE

The contractor shall not be liable for forfeiture of its performance security, liquidated damages or termination for default, if and to the extent that delay in performance or other failure to perform its obligations under the contract is the result of an event of Force Majeure. For purposes of this Clause, "Force Majeure" means an event beyond the control of the contractor and not involving the contractor's fault or negligence and not foreseeable. Such events may include, but are not limited to, Acts of god or of public enemy, acts of Government of India in their sovereign capacity, acts of war, acts of Punjab & Sind Bank either in fires, floods, strikes, lock-outs and freight embargoes.

If a Force Majeure situation arises, the contractor shall promptly notify Punjab & Sind Bank in writing of such conditions and the cause thereof within **15 days**. Unless otherwise directed by Punjab & Sind Bank in writing, the contractor shall continue to perform its obligations under the Contract as far as it is reasonably practical, and shall seek all reasonable alternative means for performance not prevented by the Force Majeure event.

In such a case, the time for performance shall be extended by a period not less than the duration of delay. If the duration of delay continues beyond a period of three months Punjab & Sind Bank and the contractor shall hold consultations with each other in an endeavour to find a solution to the problem notwithstanding the above the decision of Punjab & Sind Bank shall be final and binding on the service provider.

24. RESOLUTION OF DISPUTE

Punjab & Sind Bank and the contractor shall make every effort to resolve amicably, by direct informal negotiation, any disagreement or dispute arising between them under or in connection with the contract. If after 45 days from the commencement of such informal negotiations, Punjab & Sind Bank and the contractor is unable to resolve amicably a contract dispute; either party may require that the dispute be referred for resolution by formal arbitration.

All disputes, differences, claims and questions whatsoever arising from this Agreement between the parties and/or their respective representatives touching these presents or any clause or thing contained therein or otherwise in any manner relating to or arising from these presents shall be referred to the sole arbitrator who shall be mutually appointed by both the parties. Any party desirous of making a reference to the Arbitrator shall give fifteen days Registered Acknowledgement Due notice of his intention to do so to the other party at his usual place of business or residence or of the place of their last notified address and the notice shall be deemed to have been served when it would ordinarily have been served when it would ordinarily have been sent by post. The notice sent by the arbitrator to the parties by Registered Post at the addresses mentioned in the Agreement will be considered sufficient service on the parties whether such notice is received by them or not is refused, or is returned undelivered.

It is further agreed that:

- a) The place of arbitration will be Guwahati.
- b) The arbitration proceedings will be governed by the Arbitration and Conciliation Act, 2021 and future amendments (if any).
- c) The arbitration proceedings will be in the English language.
- d) The award will be recorded in writing, along with the reasons therefor.
- e) The Parties shall equally share the costs of the arbitrators' fees.

CONFIDENTIALITY:

This tender document is confidential and is not to be disclosed, reproduced, transmitted, or made available by the Recipient to any other person. The Bank may update or revise the tender document or any part of it. The Recipient accepts that any such revised or amended document will be subject to the same obligation of confidentiality.

- All Punjab & Sind Bank product and process details, documents, data, applications, software, systems, papers, statements and business/customer information which may be communicated to or come to the knowledge of the selected bidder or its employees during the course of discharging their obligations shall be treated as absolutely confidential and the selected bidder irrevocably agrees and undertakes and ensures that the selected bidder and its employees shall keep the same secret and confidential and not disclose the same, in whole or in part to any third party without the prior written permission of Punjab & Sind Bank nor shall use or allow to be used any information other than as may be necessary

for the due performance by the selected bidder of its obligations hereunder.

- The selected bidder shall not make or retain any copies or record of any Confidential Information submitted by Punjab & Sind Bank other than as may be required for the performance of the selected bidder obligation under this Agreement. The selected bidder shall notify Punjab & Sind Bank promptly of any unauthorized or improper use or disclosure of the Confidential Information.
- The selected bidder shall return all the Confidential Information that is in its custody, upon termination/ expiry of this Agreement. Also, so far as it is practicable, the selected bidder shall immediately expunge any Confidential Information relating to the projects from any computer, word processor or other device in possession or in the custody and control by selected bidder or its affiliates.
- The selected bidder shall extent practicable, immediately furnish a certificate signed by its director or other responsible representative confirming that to the best of his/her knowledge, information and belief, having made all proper enquiries and these requirements have been fully complied with.
- The selected bidder hereby unconditionally agrees and undertakes that it and its employees shall not disclose the terms and conditions of this Agreement or disclose the information submitted by Punjab & Sind Bank under this Agreement to any third party unless such disclosure is required by law or for the purpose of performing any of its obligations under this Agreement.
- It shall be the incumbent duty of the selected bidder to undertake not to disclose any business related information of Punjab & Sind Bank to any third person and the selected bidder shall keep all knowledge of the business activities and affairs of Punjab & Sind Bank strictly confidential and also to ensure that neither the selected bidder nor any of its officers, employees directly or indirectly assist any third person with the promotion of activities which may be prejudicial to the interest or in competition to the activities of Punjab & Sind Bank.
- However, the confidential information will not be limited to the information mentioned above but not include the following as confidential information:
 - Without breach of these presents, has already become or becomes and/or hereinafter will become part of the public domain;
 - Prior to the disclosure by Punjab & Sind Bank was known to or in the possession of the selected bidder at the time of disclosure;
 - Was disclosed or parted with the prior consent of Punjab & Sind Bank;
 - Was acquired by the selected bidder from any third party under the conditions such that it does not know or have reason to know that such third party acquired directly or indirectly from Punjab & Sind Bank.
- The selected bidder agrees to take all necessary action to protect the Confidential Information against misuse, loss, destruction, deletion and/or alteration. It shall neither misuse or permit misuse directly or indirectly, nor commercially exploit the Confidential Information for economic or other benefit. Notwithstanding above Punjab & Sind Bank shall take all the reasonable care to protect all the confidential information of consultant while performing of the services.
- The provisions of this Clause shall survive the termination of contractual agreement.

Non-Disclosure Agreement (NDA) - The selected bidder shall execute Non-Disclosure agreement in the format provided by the Bank within one month from the date of acceptance of letter of empanelment or signing of work order/SLA the NDA shall be executed by the authorized signatory of the successful Applicant. The date of letter of empanelment shall be treated as date of empanelment and the time-line for empanelment shall be worked out with reference to this date.

TENDER FORM

The Zonal Manager

Zonal Office

Punjab & Sind Bank,

42, M.G. Road, Riverside,

Uzan Bazar, Guwahati

Assam-781001

Dear Sir,

Having visited the site and examined the conditions of contract, Specifications and Schedule of Quantities for the above named works, I/We offer to undertake and complete the whole of the subject work in conformity with the said conditions of Contract, Specifications and Schedule of Quantities for the sum stated in Schedule of Quantities of this Tender Document or such other sum as may be ascertained in accordance with the said conditions of contract.

I/We undertake to complete and deliver the whole of the work comprised in the contract within **45 days**. We have independently considered the amount of liquidated damages, Contractors All Risk (CAR) insurance policy and Fire Insurance. The Contractors All Risk (CAR) and Fire insurance policy shall be obtained for the tender value in the joint names of Punjab & Sind Bank and Contractor from an approved Insurance Company for a Suitable period and the policy will be deposited with of Punjab & Sind Bank. Should this tender be accepted, I/We hereby agree to abide by and fulfil the terms and conditions of the said contract annexed here to so far as they are applicable or in case of default will pay to bank the amount mentioned in the said conditions. I/We agree to abide by this Tender till the Period of completion from the date fixed for receiving the same or agreed extended period and it shall re- main binding upon us and may be accepted at any time before the expiry of the period. Unless and until a formal Agreement is prepared and executed, this tender together with your written acceptance thereof shall constitute a binding contract between us. I/We understand that if our tender is accepted, I/We are to be jointly and severally responsible for the due performance of the Contract.

I/We deposited a sum of _____ As
earnest money in the form of Demand draft bearing no. _____ dated

of _____ drawn in favour of **Punjab & Sind Bank, Zonal Office Guwahati, 42 M.G. Road, River Side, Uzan Bazar, Guwahati** which is not to bear any interest. Should I/We fail to execute the contract (as per banks Performa in non – judicial stamp paper) when called upon to do so, the EMD may be forfeited by of **Punjab & Sind Bank**. I/We understand that you are not bound to accept the lowest or any Tender you receive.

Our Bankers are:-

The name of our firm partners are: -

BIDDER: -

Seal & Signature: -

Name: -

WITNESS:

Signature:

Name: -

DEED OF INDEMNITY
(to be executed on Rs.100 stamp paper)

This Deed of Indemnity executed at Guwahati on the _____ day of _____ by (hereinafter referred to as “**the Obligor**” which expression shall unless it be repugnant to the context, subject or meaning thereof, shall be deemed to mean and include successors and permitted assigns);

IN FAVOUR OF PUNJAB & SIND BANK, a body Corporate constituted under the Banking Companies (Acquisition and Transfer of Undertaking) Act of 1980 having its Corporate Office at Punjab & Sind Bank, Plate-B, Block-3, NBCC Tower, East Kidwai Nagar, New Delhi (hereinafter referred to as “Punjab & Sind Bank” which expression shall, unless it be repugnant to the subject or context or meaning thereof, be deemed to mean and include its successors and assigns)

WHEREAS Punjab & Sind Bank vide its Tender No [-----] dated [] (Tender) had invited Bids from the eligible Bidders for **Interior Furnishing (Allied Works) of its Zonal Office on 4th Floor of Sethi Trust Building at Bhangagarh, G.S Road, Guwahati-781005, Assam**

WHEREAS

- 1) The Obligor has
 - a) Offered to Punjab & Sind Bank the service(s) as stated under Scope of Work of Tender;
 - b) represented and warranted that it has all permissions, consents, approvals and license from all authorities, both regulatory / statutory and non-regulatory, for executing the services as stated in the Contract dated... /Tender;
 - c) Represented and warranted that the aforesaid services offered to Punjab & Sind Bank do not violate any provisions of the applicable laws, regulations or guidelines. In case there is any violation of any law, rules or regulation, which is capable of being remedied the same will be got remedied immediately during the implementation, maintenance and contract period to the satisfaction of Punjab & Sind Bank;
 - d) Represented and warranted that they are authorized and legally eligible and otherwise entitled and competent to enter into such Contract with Punjab & Sind Bank;
- 2) Punjab & Sind Bank, relying and based on the aforesaid representations and warranties of the Obligor, has agreed to avail the services from the Obligor on the terms and conditions contained in its Contract dated _____ (**the Contract**) with the Obligor;
- 3) One of the conditions of the aforesaid Contract/Tender is that the Obligor is required to furnish an indemnity in favour of Punjab & Sind Bank indemnifying the latter against any loss, damages or claims arising out of any violations of the applicable laws, regulations, guidelines during the execution and rendering/delivery of service(s) to Punjab & Sind Bank and/or due to breach of terms and conditions of the Contract by the Obligor and/or on account of misconduct, omission or negligence or otherwise by the Obligor.
- 4) In pursuance thereof, the Obligor has agreed to furnish an indemnity in the form and manner and to the satisfaction of Punjab & Sind Bank as hereinafter appearing;

NOW THIS DEED WITNESSETH AS UNDER: -

The words and expressions not specifically defined shall have the same meanings as are respectively assigned to them in the Tender/the Contract.

In consideration of Punjab & Sind Bank having agreed to award the Contract to the Obligor, the Obligor hereby unconditionally, absolutely and irrevocably agree and undertake that: -

- 1) The Obligor shall, at all times hereinafter, save and cause no harm and indemnified to Punjab Sind Bank, including its respective directors, officers, employees, agents and representatives and keep them indemnified from and against any claim, costs, charges, damages, demand, losses, liabilities or expenses of any nature and kind whatsoever and by whomsoever made in respect of the Contract and any loss or damage caused from and against all suits and other actions that may be instituted taken or preferred against Punjab & Sind Bank by whomsoever and all losses, damages, costs, charges and expenses that Punjab & Sind Bank may incur by reason of any claim made by any claimant for any reason whatsoever or by anybody claiming under them or otherwise for any losses, damages or claims arising out of all kinds of accidents, destruction, deliberate or otherwise, direct or indirect, from those arising out of violation of applicable laws and also from the environmental damages, if any, which may occur or result from the terms of the Contract.
- 2) The Obligor further agrees and undertakes that the Obligor shall, ensure that all the permissions, authorizations, consents and licenses are obtained and renewed from the local and/or municipal and/or governmental authorities, as may be required under the applicable laws, rules, regulations, guidelines, orders framed or issued by any appropriate authorities.
- 3) If any additional approval, consent or permission is required by the Obligor to execute and perform the Contract during the currency of the Contract, it shall procure the same and/or comply with the conditions stipulated by the concerned authorities without any delay.
- 4) The obligations of the Obligor herein are irrevocable, absolute and unconditional, in each case irrespective of the value, genuineness, validity, regularity or enforceability of the aforesaid Contract or other agreement, or the insolvency, bankruptcy, reorganization, dissolution, liquidation or change in ownership of Punjab & Sind Bank or Obligor or any other circumstance whatsoever which might otherwise constitute a discharge or defence of an indemnifier.
- 5) The obligations of the Obligor under this deed shall not be affected by any act, omission, matter or thing which, would reduce, release or prejudice the Obligor from any of the indemnified obligations under this indemnity or prejudice or diminish the indemnified obligations in whole or in part, including in law, equity or contract (whether or not known to it or to Punjab & Sind Bank).
- 6) This indemnity shall survive the Contract.
- 7) Any notice, request or other communication to be given or made under this indemnity shall be in writing addressed to either party at the address stated in the Contract and/or as stated above.
- 8) This indemnity and other non-contractual obligations arising out of this indemnity, shall be governed by, and construed in accordance with, the laws of India. The Obligor irrevocably and unconditionally agrees that any legal action, suit or proceedings arising out of or relating to this indemnity may be brought in the Courts/Tribunals at **Guwahati**. Final judgment against the Obligor in any such action, suit or proceeding shall be conclusive and may be end in any other jurisdiction, by suit on the judgment, a certified copy of which shall be conclusive evidence of the judgment, or in any other manner provided by law. By the execution of this indemnity, the Obligor irrevocably submits to the exclusive jurisdiction of such Court/Tribunal in any such action, suit or proceeding.

9) Punjab & Sind Bank may assign or transfer all or any part of its interest herein to any other person. Obligor shall not assign or transfer any of its rights or obligations under this indemnity, except with the prior written consent of Punjab & Sind Bank.

IN WITNESS WHEREOF the Obligor has signed these presents on the day, month and year first above written.

Signed, sealed and delivered by the said service provider, _____ to
_____(Name of the Bank) _____

AGREEMENT FORMAT (to be executed on Rs.100 stamp paper)

This agreement made on _____ day of the month _____ in the year 2024 BETWEEN _____(Name of the Bank) a body Corporate constituted and functioning under the Banking Companies (Acquisition and Transfer of undertaking Act) 1980 with its Zonal Office at....., represented by its duly constituted attorney Sri....., (name and designation), hereinafter referred to as "BANK", which expression shall unless exclude by or repugnant to the context mean and include its successors in interest and assignees on the one part and -----(Name of the Contractor), a company registered under Companies Act, 2013/ a firm registered under Partnership Act, 1932 having its registered office at..... represented by its (Authorized Signatory) Sri.....hereinafter referred to as the "SERVICE PROVIDER" on the other part; WHEREAS the Bank having agreed to engage the contractor for execution of Interior Furnishing (Allied Works) of its Zonal Office on 4th Floor of Sethi Trust Building at Bhangagarh, G.S Road, Guwahati-781005, Assam as per the specifications/requirements and the terms and conditions finalized between the contractor and the Bank,

NOW THIS AGREEMENT WITNESSETH as follows:

1. In this agreement words and expression shall have the same meanings as are respectively assigned to them in the conditions of contract hereinafter referred to.
2. The following documents not inconsistent with these presents shall be deemed to form and be read and construed as part of this agreement viz;
 - 2.1. The tender document with all Annexures and Commercial Bids
 - 2.2. The Tender, Letter of Acceptance, Letters from & to the Service provider, if any, leading to and prior to acceptance letter.
 - 2.3. Scope of work, Term and Conditions of the Tender. 2.4 Minutes of pre-bid meeting, if any.
 - 2.4. The details submitted in technical bid and such other documents.

In consideration of the payments to be made by the Bank to the contractor, the contractor hereby covenants and agrees with the Bank to render the service in conformity with and subject to all terms and conditions/rules as mentioned in the General Conditions as also in the aforesaid documents which shall form part of this agreement.

In witness whereof the parties hereto have here unto set their respective hands and seals the day and year first above written.

Signed, sealed and delivered by the said service provider, _____ to(Name of the Bank) _____ in the presence of:

Signature of Bidder (with seal)

Signature of Authorized representative of the Bank / Accepting Authority.

Witness (Signature, Name & Address):

- 1).
- 2).

UNDERTAKING FOR PRE-CONTRACT INTEGRITY PACT

The Zonal Manager,

Punjab and Sind Bank, Zonal
Office Guwahati, 42 M.G. Road,
River Side, Uzan Bazar,
Guwahati, Assam-781001

Dear Sir,

INTEGRITY PACT

Subject: E-Tender for Interior Furnishing (Allied Works) of its Zonal Office on 4th Floor of Sethi Trust Building at Bhangagarh, G.S Road, Guwahati-781005, Assam

I/We acknowledge that Punjab & Sind Bank is committed to follow the principle of transparency equity and competitiveness as enumerated in the Integrity Agreement enclosed with the tender/bid document.

I/We agree that the Notice Inviting Tender (NIT) is an invitation to offer made on the condition that I/We will sign the enclosed integrity Agreement, which is an integral part of tender documents, failing which I/We will stand disqualified from the tendering process. I/We acknowledge that **THE MAKING OF THE BID SHALL BE REGARDED AS AN UNCONDITIONAL AND ABSOLUTE ACCEPTANCE** of this condition of the NIT.

I/We confirm acceptance and compliance with the Integrity Agreement in letter and spirit and further agree that execution of the said Integrity Agreement shall be separate and distinct from the main contract, which will come into existence when tender/bid is finally accepted by Punjab & Sind Bank. I/We acknowledge and accept the duration of the Integrity Agreement, which shall be in the line with Article 6 of the enclosed Integrity Agreement.

I/We acknowledge that in the event of my/our failure to sign and accept the Integrity Agreement, while submitting the tender/bid, Punjab & Sind Bank shall have unqualified, absolute and unfettered right to disqualify the tenderer/bidder and reject the tender/bid in accordance with terms and conditions of the tender/bid.

Yours faithfully

(Duly authorized signatory of the Bidder)

To be signed by the bidder and same signatory competent / authorized to sign the relevant contract on behalf of Bidder.

PRE CONTRACT INTEGRITY PACT (On bidder's letterhead)

Between

Punjab & Sind Bank (PSB) hereinafter referred to as "**The Principal**",

And

_____ hereinafter referred to as "**The Bidder/ Contractor**"

Preamble

The Principal intends to award, under laid down organizational procedures, contract/ s for Interior Renovation & Re-Furnishing of Model Branch at R.G. Baruah Road, Chandmari, Guwahati, Assam.

The Principal values full compliance with all relevant laws of the land, rules, regulations, economic use of resources and of fairness / transparency in its relations with its Bidder(s) and /or Contractor(s).

In order to achieve these goals, the Principal has appointed Independent External Monitors (IEMs) who will monitor the tender process and the execution of the contract for compliance with the principles mentioned above.

Section 1 - Commitments of the Principal

- (1) The Principal commits itself to take all measures necessary to prevent corruption and to observe the following principles: -
 - a) No employee of the Principal, personally or through family members, will in connection with the tender for, or the execution of a contract, demand, take a promise for or accept, for self or third person, any material or immaterial benefit which the person is not legally entitled to.
 - b) The Principal will, during the tender process treat all Bidder(s) with equity and reason. The Principal will in particular, before and during the tender process, provide to all Bidder(s) the same information and will not provide to any Bidder(s) confidential / additional information through which the Bidder(s) could obtain an advantage in relation to the tender process or the contract execution.
 - c) The Principal will exclude from the process all known prejudiced persons.
- (2) If the Principal obtains information on the conduct of any of its employees which is a criminal offence under the IPC/PC Act, or if there be a substantive suspicion in this regard, the Principal will inform the Chief Vigilance Officer and in addition can initiate disciplinary actions.

Section 2 - Commitments of the Bidder(s)/ Contractor(s)

- (1) The Bidder(s)/ Contractor(s) commit themselves to take all measures necessary to prevent corruption. The Bidder(s)/ Contractor(s) commit themselves to observe the following principles during participation in the tender process and during the contract execution.
 - a) The Bidder(s)/ Contractor(s) will not, directly or through any other person or firm, offer, promise or give to any of the Principal's employees involved in the tender process or the execution of the contract or to any third person any material or other benefit which he/she is not legally entitled to, in order to obtain in exchange any advantage of any kind whatsoever during the tender process or during the execution of the contract.

- b) The Bidder(s)/ Contractor(s) will not enter with other Bidders into any undisclosed agreement or understanding, whether formal or informal. This applies in particular to prices, specifications, certifications, subsidiary contracts, submission or non-submission of bids or any other actions to restrict competitiveness or to introduce cartelization in the bidding process.
 - c) The Bidder(s)/ Contractor(s) will not commit any offence under the relevant IPC/PC Act; further the Bidder(s)/ Contractor(s) will not use improperly, for purposes of competition or personal gain, or pass on to others, any information or document provided by the Principal as part of the business relationship, regarding plans, technical proposals and business details, including information contained or transmitted electronically.
 - d) The Bidder(s)/Contractor(s) of foreign origin shall disclose the name and address of the Agents/representatives in India, if any similarly the Bidder(s)/Contractor(s) of Indian Nationality shall furnish the name and address of the foreign principals, if any. Further details as mentioned in the "Guidelines on Indian Agents of Foreign Suppliers" shall be disclosed by the Bidder(s)/Contractor(s). Further, as mentioned in the Guidelines all the payments made to the Indian agent/representative have to be in Indian Rupees only.
 - e) The Bidder(s)/ Contractor(s) will, when presenting their bid, disclose any and all payments made, is committed to or intends to make to agents, brokers or any other intermediaries in connection with the award of the contract.
 - f) Bidder(s) /Contractor(s) who have signed the Integrity Pact shall not approach the Courts while representing the matter to IEMs and shall wait for their decision in the matter.
- (2) The Bidder(s)/ Contractor(s) will not instigate third persons to commit offences outlined above or be an accessory to such offences.

Section 3 - Disqualification from tender process and exclusion from future contracts

If the Bidder(s)/Contractor(s), before award or during execution has committed a transgression through a violation of Section 2, above or in any other form such as to put their reliability or credibility in question, the Principal is entitled to disqualify the Bidder(s)/Contractor(s) from the tender process or take action as per the procedure mentioned in the "Guidelines on Banning of business dealings".

Section 4 - Compensation for Damages

- (1) If the Principal has disqualified the Bidder(s) from the tender process prior to the award according to Section 3, the Principal is entitled to demand and recover the damages equivalent to Earnest Money Deposit/ Bid Security.
- (2) If the Principal has terminated the contract according to Section 3, or if the Principal is entitled to terminate the contract according to Section 3, the Principal shall be entitled to demand and recover from the Contractor liquidated damages of the Contract value or the amount equivalent to Performance Bank Guarantee.

Section 5 - Previous transgression

- (1) The Bidder declares that no previous transgressions occurred in the last three years with any other Company in any country conforming to the anti-corruption approach or with any Public Sector Enterprise in India that could justify his exclusion from the tender process.
- (2) If the Bidder makes incorrect statement on this subject, he can be disqualified from the tender process or action can be taken as per the procedure mentioned in "Guidelines on Banning of business dealings".

Section 6 - Equal treatment of all Bidders / Contractors / Subcontractors

- (1) In case of Sub-contracting, the Principal Contractor shall take the responsibility of the adoption of Integrity Pact by the Sub-contractor.
- (2) The Principal will enter into agreements with identical conditions as this one with all Bidders and Contractors.
- (3) The Principal will disqualify from the tender process all bidders who do not sign this Pact or violate its provisions.

Section 7 - Criminal Charges against Violating Bidder(s)/Contractor(s) /Subcontractor(s)

If the Principal obtains knowledge of conduct of a Bidder, Contractor or Subcontractor, or of an employee or a representative or an associate of a Bidder, Contractor or Subcontractor which constitutes corruption, or if the Principal has substantive suspicion in this regard, the Principal will inform the same to the Chief Vigilance Officer.

Section 8 - Independent External Monitor

The following Independent External Monitors (IEM) has been appointed by the Punjab & Sind Bank as per Central Vigilance Commission guidelines. Name and addresses of the Monitors are given below:

1. Sh. Debal Kumar Gayen , E-mail: - gayen.dk@gmail.com, Phone No.- 9831268698
2. Sh. Parmod Kuymar Garg, E-mail: - pkgarg.1957@gmail.com, Phone No.-9810778058

- (1) The task of IEM is to review independently and objectively, whether and to what extent the parties comply with the obligations under this agreement.
- (2) The IEM is not subject to instructions by the representatives of the parties and performs his/her functions neutrally and independently. The IEM would have access to all Contract documents, whenever required. It will be obligatory for him / her to treat the information and documents of the Bidders/Contractors as confidential. He/ she reports to the MD & CEO, Punjab & Sind Bank.
- (3) The Bidder(s)/Contractor(s) accepts that the IEM has the right to access without restriction to all Project documentation of the Principal including that provided by the Contractor. The Contractor will also grant the IEM, upon his/her request and demonstration of a valid interest, unrestricted and unconditional access to their project documentation. The same is applicable to Sub-contractors.
- (4) The Monitor is under contractual obligation to treat the information and documents of the Bidder(s)/ Contractor(s)/ Sub-contractor(s) with confidentiality. The Monitor has also signed declarations on 'Non-Disclosure of Confidential Information' and of 'Absence of Conflict of Interest'. In case of any conflict of interest arising at a later date, the IEM shall inform MD & CEO, Punjab & Sind Bank and recuse himself / herself from that case.
- (5) The Bank will provide to the IEM sufficient information about all meetings among the parties related to the Project provided such meetings could have an impact on the contractual relations between the Bank and the Contractor. The parties offer to the IEM the option to participate in such meetings.
- (6) As soon as the IEM notices, or believes to notice, a violation of this agreement, he/she will so inform the Management of the Bank and request the Management to discontinue or take corrective action, or to take other relevant action. The IEM can in this regard submit nonbinding recommendations. Beyond this, the IEM has no right to demand from the parties that they act in a specific manner, refrain from action or tolerate action.
- (7) The IEM will submit a written report to the MD & CEO, Punjab & Sind Bank within 8 to 10 weeks from the date of reference or intimation to him by the Bank and, should the occasion arise, submit

proposals for correcting problematic situations.

- (8) If the IEM has reported to the MD & CEO, Punjab & Sind Bank, a substantiated suspicion of an offence under relevant IPC/ PC Act, and the MD & CEO, Punjab & Sind Bank has not, within the reasonable time taken visible action to proceed against such offence or reported it to the Chief Vigilance Officer, the IEM may also transmit this information directly to the Central Vigilance Commissioner.
- (9) The word IEM would include both singular and plural.

Section 9- Pact Duration

This Pact begins when both parties have legally signed it. It expires for the Contractor 12 months after the last payment under the contract, and for all other Bidders 6 months after the contract has been awarded. Any violation of the same would entail disqualification of the bidders and exclusion from future business dealings.

If any claim is made / lodged during this time, the same shall be binding and continue to be valid despite the lapse of this pact as specified above, unless it is discharged / determined by the Competent Authority of the Punjab & Sind Bank.

Section 10 - Other provisions

- (1) This agreement is subject to Indian Law. Place of performance and jurisdiction is the Registered Office of the Principal, i.e. New Delhi.
- (2) Changes and supplements as well as termination notices need to be made in writing. Side agreements have not been made.
- (3) If the Contractor is a partnership or a consortium, this agreement must be signed by all partners or consortium members.
- (4) Should one or several provisions of this agreement turn out to be invalid, the remainder of this agreement remains valid. In this case, the parties will strive to come to an agreement to their original intentions.
- (5) Issues like Warranty / Guarantee etc. shall be outside the purview of IEMs.
- (6) In the event of any contradiction between the Integrity Pact and its Annexure, the Clause in the Integrity Pact will prevail.

(For & On behalf of the Bank)

(For & On behalf of Bidder/ Contractor)

(Office Seal)

(Office Seal)

Place: _____

Date: _____

Witness 1: _____

(Name &Address) _____

Witness 2: _____

(Name &Address) _____

ANNEXURE A
SERVICE PROVIDERS PROFILE

S.No.	Information regarding	Details to be furnished by the Bidder
1)	Name & Address of the firm	
2)	PAN No.	
3)	Type of organization & year of Incorporation.	
4)	Correspondence address with contact person, Name, telephone number, mobile number, E-mail etc.	
5)	Name & details of Directors/Partners/ Proprietor	
6)	Company Profile with year of establishment	
7)	Whether registered with Registrar of Companies, if so, number & date	
8)	Income Tax No.	
9)	GST No.	
10)	Names of the Bankers with address	1. 2. 3.
11)	Turnover of the company. Please provide the details for the last 5 years ending March 31, 2024. (Self-attested copies of audited Balance Sheet and Profit & Loss account statement to be enclosed) (in Lakhs) (in INR)	2023-2024: Rs. 2022-2023: Rs. 2021-2022: Rs. 2020-2021: Rs. 2019-2020: Rs.
12)	Details of the work executed by the firm during last 5 Financial years (only those works to be mentioned that qualify the prequalification criteria). Copies of satisfactory work certificate obtained from employers to be enclosed.	Annexure B to be filled up.

I/We confirm that to the best of our knowledge this information is authentic and accept that any deliberate concealment will amount to disqualification at any stage.

Seal and Signature of the Bidder/s.

Date:

Place:

ANNEXURE B

LIST OF CONTRACTS EXECUTED DURING LAST 5 YEARS

S. No.	Name and address of client/employer client/ employer	Supervising Authority under whom the work was carried out (Name and Designation)	Work Order Ref No & Date	Contract Period	Contract Value (In Rs Lakhs)	Copy of work order and Performance certificate enclosed	Remarks

Signature of the Bidder with Seal

**ANNEXURE C
PAST PERFORMANCE**

Names along with address and telephone numbers of two organization for whom work done in the past and who are in a position to certify the past performance of your firm

S.No.	Name of the employer	Address	Telephone Number/Mobile	Fax/E-mail

Signature of the Bidder with Seal

ANNEXURE D

ORGANIZATIONAL SET UP AND TRAINED MAN POWER AVAILABLE

S. No.	Name	Emp. Code	Qualification	Experience	Works done	Employed with your firm since

Signature of the Bidder with Seal

ANNEXURE E

Details of Litigation / Arbitration Cases resulting from the Contracts Executed by Your Firm in the Past or Currently under Execution

Year	Award for/Against Applicant	Name of Client	Cause of Litigation	Disputed Amount	Actual Award Amount

Signature of the Bidder with Seal

SPECIFICATIONS/BRAND NAMES OF CIVIL AND FURNISHING MATERIALS AND FINISHES

In case it is established that the brands specified below are not available in the market are subject to the approval of the alternative brand by the Architect

S. NO.	ITEM	COMPANY MAKE
1	REINFORCEMENT STEEL	TATA, SAIL, JINDAL, RATHI KAMDHENU
2	AAC BLOCK	BILT, MAGNA, ULTATECH OR LOCAL AVAILABLE
3	CEMENT	ORDINARY PORTLAND CEMENT 43 GRADE MANUFACTURED BY ACC/BINANI/JAYPEE/ ULTRA TECH/AMBUJA
4	POLYSULPHIDE SEALANT	PIDISEAL BY M/S PIDILITE INDUSTRIES LTD., FOSROC, SHALIMAR, ROFF
5	WATER PROOFING COMPOUND	CICO , FOSROC, DR FIXIT, ROFF
6	SHUTTERING PLYWOOD	GREEN, CENTURY, ARCHID
7	TOUGHENED GLASS	SAINT GOBIAN/ ASAHI/ MODI FLOAT/ TRUTUFF OR EQUIVALENT
8	GLASS/LACQUERED GLASS	MODI FLOAT. ST. GOBAIN., ASAHI
9	WIRED GLASS	6MM THK. WIRED GLASS MANUFACTURED BY HINDUSTAN SAFETY GLASS WORKS LTD. CALCUTTA, OR VALLABH GLASS WORKS GUJRAT./HARYANA SHEET GLASS.
10	WHITE CEMENT	J.K. WHITE CEMENT , BIRLA WHITE CEMENT
11	DISTEMPER, PAINT	ENAMEL, PLASTIC EMULSION MANUFACTURED BY BERGER PAINTS, ASIAN PAINTS, NEROLAC , SHALIMAR PAINT, ICI.
12	PLASTER OF PARIS	SHRIRAM, SAKARNI, BIRLA,J.K
13	PUTTY	ASIAN PAINTS., JK, BIRLA
14	EXPANSION BOLTS FOR FIXING	DASH FASTENERS OF APPROPRIATE SIZE BY HILTI OR EQUIVALENT
15	WINDOW HARDWARE	HETTICH, KAFF, EBCO OR HAFFLE
16	CERAMIC TILES	JOHNSON,SOMANY,KAJARIA, VARMORA,
17	VINYL FLOOR	ARMSTRONG/ RIKVIN , WONDER FLOOR.
18	VITRIFIED TILES	JOHNSON, SOMANY, KAJARIA , VARMORA , ORIENT BELL(WHITE BASE)
19	GLAZED TILES	JOHNSON , SOMANY, KAJARIA , VARMORA, ORIENT BELL
20	SPECIAL CERAMIC TILES	SARASWATI CERAMICS, OTHER APPROVED POTTERY IN DELHI / KHURJA
21	HINGES AND DRAWER SLIDE, KEYBOARD	KAFF, HETTICH, OZONE, HAFFLE, EBCO
22	LOCKS, HANDLES	GODREJ, DORSET, DORMA, ASPA
23	DOOR CLOSERS, FLOOR SPRING, DOOR STOPPER AND HARDWARE FITTING	DORMA, DORSET, OZONE, GODREJ
24	ALUM, TOWER BOLTS, MAGNETIC CATCHER HARDWARE FITTING,	EBCO, EVERITE, SIGMA ,HETTICH, NIKON

25	MS SCREW	NETTLE FOLD, CALIBER, ARASNA, SUPERMAX
26	M.S. PIPES (RAILING)	JINDAL , APOLLO
27	FLUSH DOORS	DURO, CENTURY, GREENPLY, ARCHID
28	HDMR BOARD	CENTURY/ ACTION/ GREEN/ MERINO
29	LAMINATE	GREENLAM, CENTURY, MERINO
30	PLYWOOD, BLOCK BOARD ,	DURO, CENTURY, GREEN, ARCHID
31	STRUCTURAL STEEL	SAIL, TISCO, JINDAL.
32	TEXTURE TILES FOR FALSE CEILINGS / FIBER CEMENT BOARD	ARMSTRONG, EVEREST INDUSTRIES LTD.
33	WOOD	TEAK WOOD FIRST CLASS OF CP OR BURMA
34	M.S. ALUMINIUM LINEAL CEILING	INTERARCH, VISTA.
35	VENETIAL BLINDS	TRAC, VISTA, MAC, HUNTER DOUGLAS
36	GYPBOARD CEILING	GYPSUM INDIA, LAFAARZ., ST. GOBAIN, KNAUFF
37	HEAT REFLECTIVE FILM	GARWARE, 3M, SUNBIRD, WISDOM
38	ADHESIVE	FEVICOL SH, CENTURY, VEMICOL, JIVANJOR
39	TILE ADHESIVE	UNITILE, ROFF CHEMICALS, KAJARIA.
40	MIRROR	ATUL, JOLLY, MODI GUARD, ASAHI
41	G.I.PPIPE AND FITTINGS	TATA, JINDAL, APOLLO, UNIK,
42	CENTRIFUGALLY CAST (SPUN) IRON SOIL WASTE & VENT PIPE & FITTINGS	JAYASWAL NECO (NAGPUR), C.I.A.L. (DURGAPUR)
43	WOOD PRESERVATIVE	WOOD GUARD OR APPROVED EQ/ICI.
44	ALUMINIUM COMPOSITE SHEET	ALUCOBOND, ALSTONE, EUROBOND.
45	ALUMINIUM SECTIONS	JINDAL, INDAL, HINDALCO.
46	C.I./R.W.P.	NECO, RIF, IIS OR EQ.
47	C.P BRASS FITTING	JAGUAR, PARKO ,PARRYWARE, GROHE, KOHLER
48	SANITARY WARE	HINDWARE, PARRYWARE, JAGUAR, GROHE, KOHLER
49	STAINLESS STEEL SINK	DIAMOND , NIRALI, JAYNA, NILKANTH,
50	SANITARY FITTINGS VISIBLE	JAGUAR, GROHE ,KOHLER, DURAVIT, EURONICS
51	PVC,U.P.V.C PIPE	SUPREME, PRINCE, ASTRAL, FINOLEX
52	CI BRASS LA PIPES	ELECTRO STEEL, KESORAM
53	STONE WARE PIPES	BHASKAR, ANAND,
54	R.C.C PIPES	ISI MARKED OF APPROVED QUALITY
55	LOFT TANK	SYNTAX, UNIPLAS, PLOYION
56	CI PIPES & WORK	NECO, RIF,SIF,BIS OR EQUIVALENT ISI MAKE
57	ANTI TERMITE	THIDDAN (35 E.C.), DURSBAN – 20 TC, TRISHUL
58	GATE VALVES	LEADER, ZOLOTO

59	PLASTIC W.C SEAT COVER	JAQUAR/ KOHLER/ DURAVIT
60	GUN METAL VALVE (FULL WAY CHECK & GLEBE VALVES)	LEADER, SANT, ZOLOTO
61	C.I VALVE (FULL WAY CHECK & GLEBE VALVES	KIRLOSKAR, LEADER, ZOLOTO
62	CPVC	PRINCE, ASTRAL, FINOLEX , SUPREME,
63	READY MIX CONCRETE	ACC, ULTRATECH, RMC INDIA ,LAFARGE
64	ACRYLIC SOILD SURFACE THERMOFORMED	DUPONT,LG, AVONITE
65	CHAIRS/SOFA	GODREJ, FEATHERLITE, WHIPRO

LIST OF APPROVED MANUFACTURERS FOR DIFFERENT ELECTRICAL MATERIALS

S. NO.	ITEM	COMPANY MAKE
1	MEDIUM VOLTAGE SWITCHGEAR	
a	MOULDED CASE CIRCUIT BREAKER	SCHNEIDER / LEGRAND/ SIEMENS, L&T HAGGAR, HAVELLS (MCCB)
b	SWITCH FUSE UNIT	HAVELLS / L & T/ EE/ CROMPTON / H HELCON
c	HRC FUSE	HAVELLS/ L & T/ EE/ H HELCON
d	CHANGE OVER SWITCH	HAVELLS/ L & T, SEIMENS
2	VRF/VRV AC System	DAIKIN /O GENERAL / HITACHI
2(a)	Split AC	DAIKIN /O GENERAL / HITACHI (5 Star INVERTER AC)
3	CENTRIFUGAL FANS	KRUGER/NICOTRA/ GREEN HECK/AIR FLOW
4	INLINE FANS	KRUGER/NICOTRA/ GREEN HECK/AIR FLOW
5	G.I. Sheets	SAIL/ TATA/JINDAL
6	FACTOR FABRICATED DUCTING	ROLASTAR/ZECO/DUCTOFAB
7	WELDING ROADS	ADVANI/L&T
8	DUCT SUPPORTS	HILTI/ WALRAVEN/GRIPPLE
9	ANCHOR/ FASTENER	HILTI/FISHER/STERLING
10	ALUMINIUM TAPE	JOHNSON/BIRLA/ 3M
11	GRILLS/DIFFUSERS/FIRE DAMPERS	GLENSTORMS/SYSTEMAIR/RUSKINTITUS
12	INSULATION/ACOUSTIC LINING FOR DUCTING	ARMACELL / UROBATEX /VIDOFLEX
13	INSULATION FOR REFRIGERENT FOR PIPE	ARMACELL / UROBATEX /VIDOFLEX
14	COPPER REFRIGENT PIPE	RAJCO/MANDEV/MAHFLOW
15	UPVC DRAIN PIPE	SUPREME/ASTRALS/FINOLEX
16	CANVAS CONNECTION	MAPRO/GLENSTORMS/ASTAR
17	PROPELLER TYPE EXHAUST FAN	KRUGER/ HAVELLS/ MARATHAN/ORIENT/USHA/BAJAJ
18	MCB/ELCB/DBS/MCCB	SCHNEIDER / LEGRAND/ SIEMENS, ,L&T HAGGAR, HAVELLS
19	ACB	SCHNEIDER (MG-NS SERIES)/ SIEMENS (3WT)/ L&T (D-SINE)
21	MV CONTRACTORS/TIMER/ STARTERS	L&T/ SIEMENS/LEGRAND
22	PROTECTIVE RELAYS	L&T/ SIEMENS, ALSTOM, ABB
23	ALL METERS	ENERCON/NEPTUNE/ SIEMENS
24	AMMETER/VOLTMETER	A.E/ INDOTECH OR APPROVED EQUIVALENT

25	INDICATION LAMPS/PUSH BUTTON	L&T/ SCHNEIDER/VASHINO,CONCORD,SIEMENS
26	CAPACITOR	L&T/ SIEMENS/ NEPTUNE
27	TERMINAL BLOCKS	ELMEX/WAGO/CONNECT-WELL
28	CURRENT TRANSFORMER	AEP/ KAPPA/ INDITECH
29	SELECTOR SWITCH	KAYCEE/L&T/BCH/AREVA/ABB
30	BUS BAR	JINDAL/ INDALCO/ CENTURY
31	LT CABLES/CONTROL CABLE	SKYTON/ FINOLEX/POLYCAB /GLOSTER ALL FRLS
32	SWITCH SOCKET/METAL CLAD SOCKET	LEGRAND (MYRIUS) , / ANCHOR ROMA , HAVELLS (CRABTREE)
33	CABLE TRAY	PILCO/ NEEDO, SLOTCO, VENUS,ERA CONTROL SYSTEM
34	HUNGS	DOWELS
35	CONNECTORS	ELMEC/DELACITY/WAYTEK
36	CABLE GLAND	STRIPWELL/ COMMET/ SIEMENS,GROMMET,POWER ENGG.
37	MV PANEL (TTA)	SIEMENS CPAN/ ABB R2K/ SCHNEIDER BLOCKSET
38	GI CONDUIT	BEC/ AKG/ STEEL CRAFT
39	MOTORS	SIEMENS/ ABB/ CROMPTON
40	PVC PIPE	FINOLEX/ PRINCE/ SUPREME
41	ELECTRICAL PANEL	KRYPTON/RISHA/KEPL, ERA CONTROL SYSTEM /SPT SWITCHGEARS /EVA` ENGINEERS
42	G.I PIPE	TATA/JINDAL/BHUSAN
43	EARTH LEAKAGE CIRCUIT	HAGER/ LEGRAND/ MERLIN GERIN
44	FIRE ALARM SYSTEM	SYSTEM SENSOR/ EDWARDS/APPOLO/AGNI
45	DATA COMPONENTS	AMP/ SYSTMATICS/LEGRAND
46	ACCESS CONTROL SYSTEM/ CCTV SYSTEM	BRIVO/HONEYWELL/DATS/LENEL/TYCO/SIEMENS
47	DOOR PHONE	PANASONIC/ZICOM/SOLUS(SECURE)
48	READER	BRIVO/HID
49	SMART PROXIMITY CARD	BRIVO/HID
50	CAPACITOR BANKS	L&T/ SIEMENS/ALSTOM
51	PVC INSULATED COPPER CONDUCTOR STRANDED	FINOLEX/ POLYCAB FRLS/HAVELLS
52	CONTROL WIRES OF 1100 V GRADE	
	COPPER LUGS HEAVY DUTY	DOWELLS
53	MEASURING METERS	AUTOMATIC ELECTRIC/KAPPA/ENERCON
54	DIGITAL METERS & KWH METERS	SECURE/L&T/ENERCON
55	PUSH BUTTONS	L & T/SIEMEN/ABB
56	WIRING CABLE	FINOLEX / POLYCAB / HAVELLS/RR CABLES ALL FRLS

57	M.S. CONDUITS AND ASSESSORIES	BEC /AKG /ESC
58	P.V.C. CONDUITS AND ACCESSORIES	BEC/ AKG/POLYPACK/ESC ALL FRLS
59	LIGHT FIXTURES	PHILIPS/HAVELLS/SYSKA/WIPRO
60	FAN	USHA/CROMPTON/HAVELLS
61	ANY OTHER ITEMS	SAMPLE TO BE APPROVED BY BANK/ARCHITECT

In the event of the materials of makes called for are not available and alternative makes are approved (by the consultant) for incorporation in the work, the rates quoted shall be suitably amended based on the price variation between the specified makes and alternative makes on the day the alternative makes are accepted.

**ON 4TH FLOOR OF SETHI TRUST BUILDING AT BHANGAGARH, G. S. ROAD, GUWAHATI,
ASSAM**

SUMMARY SHEET

SL. NO	ITEM DESCRIPTION	AMOUNT (RS.)
A	INTERIOR FURNISHING WORKS	
1	CARPENTRY & INTERIOR WORKS	
2	ELECTRICAL & OTHER RELATED WORKS	
A	TOTAL OF INTERIOR FURNISHING WORKS	
B	MISC. NON INTERIOR WORKS	
1	AIR CONDITIONING WORKS	
2	C C T V SYSTEM	
3	FIRE ALARM SYSTEM	
B	TOTAL OF MISC. NON-INTERIOR WORKS	
C	TOTAL OF INTERIOR & MISC. NON- INTERIOR WORKS (A+B)	
1.GST will be paid extra as per Applicable norms		
2.Strictly no additional items should be executed beyond the above tender		

ESTIMATED BOQ FOR CARPENTRY WORKS OF ZONAL OFFICE OF PUNJAB & SINDH BANK ON 4TH FLOOR OF SETHI TRUST BUILDING AT BHANGAGARH, GUWAHATI, ASSAM

PART A :- CARPENTRY WORKS					
SR.NO	DESCRIPTION	UNIT	QNTY	RATE	AMOUNT
	NOTES				
i	The rate shall be include of frame work above false ceiling level. Measurement should be taken up to false ceiling level and visible portion only.				
ii	Basic rate of Laminate shall be considered as Rs 35/SFT				
iv	Basic rate of Solid Surfaces (CORIAN) 6mm thk shall be 890/ sft, and for 12mm shall be 1550/ sft				
v	All hardware fittings and fixtures should strictly be of Ozone, Hettich, Dorma or Haffle make only				
A	PARTITION WORKS				
1	FULLY GLAZED PARTITION - WITH TOUGHENED GLASS				
	Providing and fixing of Fixed Glass partition with 10mm thick toughened glass using Standard fittings of above - mentioned makes at the top and grouting at the bottom & top with U - Shaped Aluminium rails and EPDM gaskets including cutting, making holes in glass and fixing the fittings in floors, false ceiling etc. and making the same good with necessary screw, sealent wherever required. The top U-shaped Aluminium rail alongwith other fittings should be fitted to the Wooden section fixed above the Gypsum board in the level of GI channels of False ceiling.				
a	USING OZONE / HAFFLE / YALE/ HETTICH MAKE FITTINGS	S.FT.	255		
2	FULL HEIGHT SOLID PARTITION FINISHED WITH PLY ON BOTH SIDES				
	Providing and fixing full height solid partition upto ceiling height consisting of G.I. frame and required board fixed on both sides . It shall including providing and fixing of frame work made of special section power pressed/ roll form G.I. sheet with zinc coating of 120 gms/ sqm(both side inclusive), consisting of floor and ceiling channel 50mm wide having equal flanges of 32 mm and 0.50 mm thick, fixed to the floor and ceiling at the spacing of 610 mm centre to centre with dash fastener of 12.5 mm dia meter 50 mm length or suitable anchor fastener or metal screws with nylon plugs and the studs 48 mm wide having one flange of 34 mm and other flange 36 mm and 0.50 mm thick fixed vertically within flanges of floor and ceiling channel and placed at a spacing of 610 mm centre to centre by 6 mm dia bolts and nuts, including fixing of studs along both ends of partition fixed flush to wall with suitable anchor fastener or metal screws with nylon plugs at spacing of 450 mm centre to centre, and fixing of boards to both side of frame work by 25 mm long dry wall screws on studs, floor and ceiling channels at the spacing of 300 mm centre to centre. The boards are to be fixed to the frame work with joints staggered to avoid through cracks, Galvanised M.S. fixing channel of 99 mm width (0.9 mm thick having two flanges of 9.5 mm each with zinc coating of 120 gms/sqm(both side inclusive)) to be provided at the horizontal joints of two boards, fixed to the studs using metal to metal flat head screws. The partition should be finished with 1.0mm thk Laminate/ 4.0mm thk Veneer finished in melamine polish. The shade of laminate / veneer and polishing finish to be got approved from the Architect.				
a	FINISHED WITH BOTH SIDE LAMINATE	S.FT.	1390		
b	FINISHED WITH BOTH SIDE PLY ABOVE FALSE CEILING TILL SLAB (FULLY PANELLED IN PLY & WITHOUT LAMINATE) (ONLY FOR CONFERENCE CABIN, ZM'S CABIN, ANTF ROOM & DZM'S CABIN)	S.FT.	210		
3	FULL HEIGHT UPS/ LAN - ONE SIDE FIBRE CEMENT BOARD HAVING FIRE RATING FOR MINIMUM 6 HOURS & OTHER SIDE PLY WITH LAMINATE) FOR UPS/ SERVER ROOM WITH DOOR	S.FT.	200		
	P/ F full height partitions made out of 16 gauge Aluminium Framing of 50 mm X 50 mm at 600 mm Centre to Centre both ways (vertically & horizontally). The frames must be rigidly fixed to the floor / walls & ceiling slabs. The 16 gauge aluminium angle cleats shall be used for joinery with aluminium metal screws. The aluminium framing then shall be covered with 6 mm thk MR ply of approved make finished in 1 mm thk laminate of approved make & shade on one side and 10mm thick Everest Fibre Cement board (Confirming to IS 14862; Type - B Category III) duly finished & painted (as per painting on wall specs) on the other side. Necessary cuttings for Electrical conduits & Electrical fittings as per the requirements shall be provided, as per design / drawings / instructions. The partition rate shall be inclusive of cost of the flush door including the door frame of size 4" X 2' 6", handle, door closure, Hinges and Tower bolts. The door will have peep window (1' x 1') at 5' level with 6mm thk glass. Note: For the measurements of Partitions, area up to the false ceiling height only shall be considered. (In case door frames are not provided suitable deduction will be done				
3	SEMI HT. SEMI GLAZED PARTITION IN LAMINATE				

	Specification same as Solid Partition above but of low ht as per the drawing. The partition shall be finished with 1.0mm thk laminate of approved shade and make over 8/9mm thk plywood fixed on both sides of the partition framing. All external surface and edges to be finish with 1mm thk laminate of approved shade & make. Providing and Fixing inserted Soft board / White boards / Glass maintaining the vertical surface lines and no extra measurements would be taken for the soft boards / white boards /				
a	WITH BOTH SIDE LAMINATE	S.FT.	120		
4	SEMI HT. SOLID PARTITION IN LAMINATE				
	Same as Semi Ht. Semi glazed partition but without any glass/ soft boar/ white board	S.FT.	270		
5	GLAZED DIVIDER PARTITIONS OVER WORKSATATIONS	S.FT.	68		
	Providing and fixing glazed partition 450mm (Max Height) as per approved design of 12mm thk frosted glass in "D" Shape as per approved pattern and design, mirror polished fixed with S S D-Clipsfixed to walls/partitions on one side and Table top on the other side				
B	PANELLING				
1	PANELLING ON WALLS/ COLUMNS - with or without frame				
	Providing and fixing of wall panelling directly on the wall surface with or without any framework with 12mm thick commercial grade ply and then finished with 1.0 mm thick. laminate/ with 4.0mm thk veneer in mellamine polish of approved shade. If the framework is required it shall be of aluminium hollow sections of 50mm x 50mm size 1.5mm thick of JINDAL / INDAL make as internal frame structure placed horizontally & vertically in 550 mm x 550 mm or 600mm x 600mm center to center or as directed by the Architect . All woodwork & laminate shall be finished with two or more coats of Melamine or PU polish over one coat of sealer; all complete as per the instructions of Architect. The rate shall be inclusive of provision of groove with 1.0 mm thick. laminate along all 3 sides of the groove in the panelling of size 12mm x 12mmx 18 mm ht. and as directed by the Architect. This item also includes scaffolding for maximum height upto 4.0 m from floor level.				
a	WITH LAMINATE FINISH	S.FT.	1130		
2	PANNELLING WITH 6 MM THK LECQUERED GLASS OF APPROVED SHADE	S.FT.			
	Providing and fixing of 6mm thick lacquer glass SGG Planilaque glass of approved color by architect/ Client with SGG Planifix silicon on perfectly leveled water proof non-conventional plywood (preferably marine plywood) of minimum 12mm thickness mounted on the BRICK or RCC wall/any other structure. The SGG Planilaque lacquered glass to be of 6mm thick highly durable, humid resistance, poly urethane lacquer glass. The Planilaque glass should be manufactured by industrial curtain coating process. It should meet quality standards as per BS EN 1036 1999 & confirms to PERSOZ hardness test of at least 220 oscillations. The substrate of the glass should conform to Standard BS EN 572 1995 parts 1 and 2: Glass in Building – Basic soda lime silicate glass products. Planilaque lacquered glass to be manufactured to right specifications, relating to consistency of color, opacity and homogeneity throughout production campaigns and also to the ageing properties, mechanical resistance, and resistance to humidity and to chemical agents of the lacquer. The color of the lacquer should remain stable when exposed to normal levels of ultraviolet light in interior applications.The rate shall be inclusive of levelling the surface with 9/12 mm thk plywood base panelling as required for fixing the glass.				
3	PANNELLING ON WALL & CEILINGS WITH WPC PANNELS OF OF APPROVED SHADE AND MAKE	S.FT.			
	Providing and fixing panelling on wall & ceilings with WPC (Wood PLYmer Composite) Fluted Panels of VOX/ PAREAlutuff / or Murrato make of approved shade in approved pattern as directed by the architect. Rates shall be inclusive of all hardware fittings and fixtures as required to fix the same on the wall and ceilings including corner beading and fastners				
4	PANELLING WITH CANE IN BAMBOO FINISH	S.FT.			
	Providing and fixing panelling on wall & columns with cane and finished with natural PU Polish . Rate shall include covering the edges/ gaps with so as to attain a finished surface				
5	PANELLING WITH WALL PAPER	S.FT.	196		
	Providing fixing and pasting Wall paper as per design & details. The item includes making POP base to get a uniform smooth surface. (base Price Rs. 100/ sqft.without taxes) The fixed area of wall paper shall be considered for payment and not the area of procured material.				
6	OUTSIDE PANELLING ON WALL/COLUMNS WITH 4MM THK ACP IN TIMBER SERIES	S.FT.	48		

	Providing and fixing panelling on wall with 3mm thick Aluminium Composite Panel (Timber Series) for cladding at walls/ partitions/ columns at places as directed by the EIC/ Architect, of ALU Decor / Aluco Bond / Alo Bond or approved equivalent make for Internal wall / column / partition cladding in combination with other colours , including all necessary frame work and complete weather sealing. The composite panel should consist of 2.5mm thermoplastic core of LDPE sandwiched between 2 skins of 0.25mm thick aluminium sheet (alloy designation 310S) making a total panel thickness of 3mm. The surface will be furnished with Lumiflon based flourcarbon coating on top sides and service coating on reverse side. Coatings shall conform to specifications of specifications of ECCA / AAMA and conforming to the mechanical properties of panel as per detailed technical specifications. the system shall be fixed using GI brackets and stainless steel bolts and nuts complete with spring washers and cap nuts and all other necessary accessories. The bracket support shall be designed as per manufactures specification and shall withstand a wind pressure of 150 kg / sqm. all hardware shall corrosion resistant frame out of anodised aluminium member. Rate shall be inclusive all hardware fittings and fixtures, adhesives, silicon etc. all complete				
10	NOTICE BOARD	SFT.	48		
	Providing and fixing notice board size as required/ directed (matching with the panel of the cabin) with openable shutter on the front. Made out of 19mm thick Steam beech veneered block board frame and outer frame in 2 1/2" x 1 1/2" Steam beech wood section , concealed hinges , locking arrangement , and glass of (5.5mm thick) with rear panel of SITATEX board , covered with fabric of approved shade. (Basic rate Rs.100/-per mtr , 48" width), fixed to back ply 6mm thick . All complete including melamine polish in stain of required shade. All complete as per approval of the Architect / employer				
11	COLOURED VINYL FILIM OVER WALLS/ PILLARS/ PARTITIONS	SFT	140		
	Supplying and Fixing coloured flex/ Wall paper/ Film of approved shade, pattern and design as approved by the architect (shades to be selected from shutterstock.com) on finished walls/ partitions/ceilings/pannelling, as directed by the architect with approved make of adhesive.				
14	10MM GLASS SHELVES- 250-300MM WIDE	RFT	44		
	Providing and fixing 12mm thk Clear Glass Shelves, 250-300MM WIDE in mirror polished edges as per design. The Glass selves should be fixed with the help of Stainless Steel F Type Glass Shelf Bracket Square 12 Inches, with screws to walls / partitions/ pannelling, at an interval of 24-30" as per design and as directed by the architect				
C	DOORS				
14	ENTRANCE DOORS - WITH TOUGHENED GLASS (PATCH FITTINGS)				
	Providing and fixing frameless fully glazed 12mm thk toughened float glass fixed with necessary patch fittings(Dorma make) including cutting, making holes, cutouts in the glass of required shape and size to acBWPodate fittings and fixing the fittings in floors, soffits, jams including necessary fixtures, screws, sealent wherever required and SS cover over patch fittings. Rate shall include necessary etching film / LOGO, approved patch fitting locking systems, 1 pair of 12" long S. S. (C Shape) Handles of approved make, floor springs, and any necessary hardware items.(ABOVE MENTIONED MAKES Top Pivot , Top Patch Fittings, Bottom Patch fittings , Floor Spring , Corner lock with strike plate and Euro Profile Cilinder, C Shape Handle 25mm dia X 300mm length)				
a.	DOORS - WITH OZONE / HAFFLE / HETTICH MAKE FITTINGS	S.FT.	96		
2	DOORS ON WOODEN PARTITION / BR. WALLS WITH OR WITHOUT VISION PANEL				
a	SOLID DOORS- IN LAMINATE FINISH (with hardware fittings MAKE EVERITE / GOLDEN /HARDWIN /EVEREST) (WITH OR WITH OUT VISION PANEL AS PER DIRECTION OF the ARCHITECT				
	Providing and fixing solid doors of sizes as shown in the drawing. The door shutter shall of 35 mm thick flush shutter of approved make and finished with 1mm thick approved laminate on both sides. The edges finished with steam beach lipping. A door frame of 3.5" x 2" steam beach section shall be provided finished in mellamine. Rate shall include Dead lock (Godrej Make), floor springs / door closure (as the case may be), door stopper, a pair of handles 12" SS Brushed finished, 5" hinges 4 Nos., buffers, tower bolts, etc with necessary hardware items and with or with out door frames as mentioned above				
i	With Door Closure	NOS	9		
ii	RE-MODELLING OF EXISTING DOOR SHUTTER & FINISHING WITH BOTH SIDE LAMINATE	NOS	1		
b	SOLID DOORS- IN VENEER FINISH (with hardware fittings MAKE EVERITE / GOLDEN /HARDWIN /EVEREST) (WITH OR WITH OUT VISION PANEL AS PER DIRECTION OF the ARCHITECT				
	Providing and fixing solid doors of sizes as shown in the drawing. The door shutter shall of 35 mm thick flush shutter of approved make and finished with Vineer finished with melamine polish on both sides. The edges finished with steam beach lipping. A door frame of 3.5" x 2" steam beach section shall be provided finished in mellamine. Rate shall include Dead lock (Godrej Make), floor springs / door closure (as the case may be), door stopper, a pair of handles 12" SS Brushed finished, 5" hinges 4 Nos., buffers, tower bolts, etc with necessary hardware items and with or with out door frames as mentioned above				

i	WITH DOOR CLOSER FINISHED ON BOTH SIDE WITH VEENER IN MELLAMINE POLISH	NOS	3		
ii	Same as above as 3 (b) but finished with one side laminate and one side veneer in mellamine polish with Door closer	NOS	1		
iii	RE-MODELLING OF EXISTING DOOR SHUTTER & FINISHING WITH BOTH SIDE VENEER	NOS	1		
	Repair & Remodelling of existing Flush Door by replacing/ fixing 1.0mm thk laminate of approved shade and make in approved pattern and fitting new hardwares including- Door Closer, Door Stopper, Mortice lever lock, S.S Hinges, etc all complete				
c	TOILET DOORS				
i	WPC DOOR FRAMES FOR TOILETS OF SIZE 100MM X 80MM	S.F.T			
	Providing and fixing factory made single extruded WPC (Wood Polymer Composite) solid door/window/Ceometry windows & other Frames/Chowkhat comprising of virgin PVC polymer of K value 58- 60 (Suspension Grade), calcium carbonate and natural fibers (wood powder/ rice husk/wheat husk) and non toxic additives (maximum toxicity index of 12 for 100 gms) fabricated with miter joints after applying PVC solvent cement and screwed with full body threaded star headed SS screws having minimum frame density of 750 kg/ cum, screw withdrawal strength of 2200 N (Face) & 1100 N (Edge), minimum compressive strength of 58 N/mm ² , modulus of elasticity 900 N/mm ² and resistance to spread of flame of Class A category with property of being termite/borer proof, water/moisture proof and fire retardant and fixed in position with M.S hold fast/lugs/SS dash fasteners of required dia and length complete as per direction of Engineer-In- Charge. (rate shall be inclusive of the cost of M.S hold fast/lugs or SS dash fasteners etc, all complete). Note: For WPC solid door/window frames, minus 5mm tolerance in dimensions i.e depth and width of profile shall be acceptable. Variation in profile dimensions on plus side shall be acceptable but no extra payment on this account shall be made. Frame size 65 x 125 mm, Make-ALSTONE or equivalent				
ii	WPC DOOR FOR TOILETS	S.F.T			
	Providing & Fixing factory made single extruded WPC (Wood Polymer Composite) solid decorative type flush door shutter of required size comprising of virgin polymer of K value 58-60 (Suspension Grade), calcium carbonate and natural fibre (wood powder, rice husk, wheat husk) and non toxic additives (Maximum Toxic level of 12 per 100 gms) having maximum density of 650 kg/ cum and screw withdrawel strength of 1800 n (Face) and 900 N (Edge), minimum compressive strength of 50N/mm ² , modulus of elascity 850 N/ mm ² and resistance to spread of flame of Class A category with propoerty of being termite / borer proof, water/ moisture proof and fire retardent. WPC to be laminated with PVC foil of minimum 14 microns thick of approved design pasted with hot melt adhesives on both faces of shutter and fixing with stainless steel butt hinges of required sizes with necessary full body threaded star headed counter sunk s s screws, all as per direction of Engineer-in-Charge.The door shutter shall then be finished with1.0mm thk laminate of approved shade ands make in approved pattern as directed by the architect. Note- Rate shall be inclusive of Stainless Steel butt hinges and screws, Tower Bolt, 6" S.S D Handle, etc. all complete. 30 mm thick, Make- ALSTONE or equivalent				
D	STORAGES				
i	LOW HT. STORAGES (1'-6" DEPTH X 2'-6" HT.) (BACK CREDENZA)				
	Providing and laying low ht. Storage units of sizes as mentioned above. They shall consist of a top of ¾" thk. BWP. Ply, ¾" thk. BWP. Ply sides and base, ¾" thk. Marine ply back, ¾" thk. BWP. Ply shutter with self closing higes of hafele make(full ovel open) & PVC lipping matching with approved laminate/Veneer on all the edges. All external surfaces to be finished in 1.0 mm laminate (suede finish)of approved make. Division of shutters shall be made equally according to the length of the storage. A ¾" thk. Fixed BWP. Ply shelf on battens shall be provided at 16" intervals from the base. Suitable wooden moulding (as per Architects design) with mellamine shall be provided to the edge of the storage top. All inner surfaces including shutters shall be finished with 0.80mm thk laminate of approved shade and colour. Rate shall be inclusive of all necessary approved fittings like hinges(Hafele make), locks(Godrej make/Vijayan), 3" long brushed finish handles(kich -neki make-CHR103),tower bolts and any miscellaneous hardware items.				
a	2'-6" / 4'-0" HIGH IN LAMINATE FINISH	S.F.T	248		
ii	FULL HT. STORAGE IN LAMINATE FINISH	S.F.T	510		

	Providing and fixing storage units of full height as per drwng. They shall consist of 18mm thk.BWP. ply top, sides,back, bottom, shelves and shutters. The bottom of the storages shall be at 3" from FFL. The top of storages shall touch the false ceiling level or 7'-0" ht. The shutter with box type higes of approved make & steam beach lipping finished with melamine with approved laminate on all the shutter edges. Division of the shutters shall be made equally according to the length of the storages (as approved by Bank/ architect). All the external surfaces shall be finished with 1.0mm thk. Laminate (suede finish) of approved make. 18mm thk. BWP. Ply shelves removable type supported on side steam beach wood battens on both sides at 16" interval (approximately / divided equally) shall be provided. All inner surfaces shall be finished with laminate including the shutters. Rate shall be inclusive of all necessary approved fittings like hinges, locks, 150mm long SS brushed finish handles,tower bolts, locks and any necessary hardware items. The top ply edge should be fitted with 19mm x 7mm size steam beach moulding finished with melamine.				
iii	OVERHEAD STORAGE IN LAMINATE FINISH	S.FT.	138		
	Providing and fixing over-head storages which consist of 18mm thk. BWP. ply shutter with box type higes of approved make & Steam beach lipping with approved laminate on all the edges. The shutter should be made of of 18mm thk. BWP. Ply top, sides, rear and bottom. All the external surfaces shall be finished with 1.0mm thk. Laminate (suede finish) of approved make. Division of the shutters shall be made equally according to the length of the storage. The edges of the shutters shall be provided with steam beach lipping. One Ply shelf of 18mm thick BWP.ply removable type supported on side steam beach wood battens on both sides (divided equally) shall be provided. All inner surfaces shall be finished with laminate including the shutters.. Rate shall be inclusive of all necessary approved fittings like box type hinges, locks, tower bolts, 100mm SS Brush finished handle etc.				
iv	SHUTTERS BELOW GRANITE COUNTERS IN PANTRY/ KITCHEN IN LAMINATE FINISH	S.FT.	19		
	Providing and fixing 19mm thk. BWR ply shutters with ply frame, skirting gap as shown in the drg. shall be maintained. Division of shutters shall be made equally according to the length of the counter. Shutters shall be hinged to the framework and finished with 1.0mm thk. Laminate (suede finish) of approved shade from outside, applied with approved oil paint from the inside and edges of shutters with steam beach lipping. Rate shall be inclusive of all necessary approved fittings like hinges, ball catch, handle, and any necessary hardware items.				
v	18'-24" PLYWOOD SHELVES	R.F.T	22		
	Providing and fixing 1'-6" to 2'-0" plywood shelves made with 19mm thk plywood/ block board and finished with 1.0mm thk laminate of outer surface and 0.80mm thk balancing laminate on the inner surfaces. The shelves to be supported on 25mm x25 mm T.W beading fixed to walls on available sides & back walls				
vi	KEY BOX	NOS	1		
	Providing and fixing key box of size 1' 6"x1' 6"x 6" with all sides and back with 18mm thick BWP. Ply wood and lockable glass shutters in 18mm ply , with 5 mm glass. Necessary hooks to be provided inside the box. All exposed areas and inside to be finished with 1 mm thick laminate of approved shade. The edges of shutter and box to be lipped with steam beach beeding polished with melamine. Rate shall be inclusive of all necessary approved fittings like hinges, locks, hooks etc. and any necessary hardware items.				
vii	SHUTTERS WITH FRAME FOR ELECTRICAL PANELS	S.FT.	32		
	Providing and fixing 18mm thk. Com ply shutters with same ply frame. Division of shutters shall be made equally according to the length. Shutters shall be hinged to the framework and finished with 1.0mm thk. Laminate of approved colour and shade on outer side and inside finised with 2 coats of enamel paint of app colour and shade. Rate shall be inclusive of all necessary approved fittings like hinges, ball catch,150 mm long SS Brush Finish handle, tower bolts, locks, Aluminium powder coated air vent grills and necessary hardware fitings complete, etc.,				
E	DESK, WORKSTATIONS & DRAWERS				
i	19 SEATER CONFERENCE ROOM TABLE - (22'6" x 5'-0") with Table Top as per Design	NOS.	1		
	Providing and making a table of over all size of top as mentioned above. It shall consist of 18mm thk. BWP. Ply top as per design finished with 1.0mm thk laminate of approved shade and colour, supported on 8-12 nos numbers of mullion boxes, as per design of size 18" x 10" made of 18mm thk. BWP finished with 1mm thk laminate of approved shade and Ply inter connected with boxing 10" x 6" (as approved by the architect) on top(below table top) and at bottom (on floor level), finished in laminate of approved shade. Table top to be finished with 6 mm thk Corian of Merino make- Hanex Solid Surface of approved shade and colour and other external surfaces with 1.0 mm thk laminate of approved shade.This supporting boxes shall be then covered with apron on all sides as per design with 19 mm thk plywood finished with approved shade of laminate. Additional legs/ supports in 19 mm thk BWP Ply and finished with approved shade of laminates to be provided at distances as mentioned in the detailed drawings and as per the direction of the architect/ Engineer-in- charge				

ii	ANGULAR RECEPTION DESK DESK - (2'9" X2'9") with Corian Top AND FRONT BOXING AS PER DESIGN	NOS.	1		
	Providing and making a table of over all size of top as mentioned above and as per design given. It shall consist of 18mm thk. BWP. Ply top finished with 6mm thk Corian of approved shade and make of MERINO Make with edge moulding and a 3 drawer unit with locks, handles etc. on the end of the table as shown in the drawing.(as approved by the architect). The drawer unit finished top should be at a lower level of 25mm below the finished counter top. The front modesty panel should be finished 18 mm BWP. ply with laminate (as approved colour / shade) with Metallic laminate. The customer side top should be at a height of 1 feet with 18/19mm thick ply and wrapped with 12mm thk Solid Surface (Corian) and taken down till half the length of the front apron of the table , of approved colour to be provided. The remaining part 15"-18" high of the front apron should be panelled with WPC louvers of approved shade and make in approved pattern. The inside of drawer units, and the tables should be finished with laminate of approved shade. All exposed surface should be finished with 1.0mm thk laminate wherever not mentioned and all the inner surfaces should be finished with 0.80mm thk laminate in frosty white colour & shade				
iii	LINEAR WORK STATION COUNTER 2'-0" WIDE WITH PEDESTAL	R.FT.	118		
	Providing and laying a linear Workstation counter with pedestal ,key board tray , Wire manager, CPU Trolley & Foot Rest at every 4'-6" length for 2'-0" over all size of top . It shall consist of 3/4" thk. Comm. Ply top as per design (double edge on the front and back with 1 1/2" thk half round moulding on the edges) supported on 3/4" thk. Comm. Ply verticals at every 4'-0" length. Suitable (as per Architects design) wooden moulding with mellamine shall be provided to the edge of the top. The top of the counter and all other external surfaces to be finished in 1.0 mm. thk. Laminate of approved shade & make. The Running Counter should also be provided with- 1no. Computer key board tray (either ready made / made to the order as per architects design using 3/4" thk comm ply base and 1" x 2" round edged moulding on the front fixed with telescopic/double(Hafele/ebco make) approved sliders) , 1no. pedestal(Modular Type) of size 392mm(L)x 450mm(D) x 680mm(H), either fixed or on castors . The pedestal/ drawer unit shall consist of two numbers of drawers and one filing box mounted on ebco/ haffle/ hettick make metal telescopic channel on either sides. It shall be provided with central lock mechanism with keys and handles of ebco/ haffle/ hettich make in the front to facilitate opening and closing of drawers .Drawers shall be made of 12mm ply finished with laminate outside & wood lipping, mounted on drawer slides. Rates should include all hardware like castors, brass hinges, ballcatches, fully extendable drawer slides, locks, handles etc., of approved make. All exposed edges to have wooden lipping stained to match the desk and melamine finished.				
iv	L-TYPE WORKSTATION WITH SIDE CADENZA OF OVERALL SIZE 1500 MM X 1500 MM	NOS			
	MAIN TABLE- 1500MM X 600MM				
	SIDE TABLE - 900MM X 450MM				
	Providing and laying a L-Type Workstation counter with side cadenza along with key board tray , Wire manager, CPU Trolley & Foot Rest of overall size as mentioned above and supported on 19mm thk plywood on three sides . It shall consist of 3/4" thk. Comm. Ply top as per design (with 1 1/2" thk half round moulding on the edges) supported on 3/4" thk. Comm. Ply verticals at sides and at back. The top of the counter and all other external surfaces to be finished in 1.0 mm. thk. Laminate and all inner surfaces should be finished with 0.80mm thk laminate of balancing shade in white colour, of approved shade & make. Each Workstation should also be provided with- 1no. Computer key board tray (either ready made / made to the order as per architects design using 3/4" thk comm ply base and 1" x 2" round edged moulding on the front fixed with telescopic/double(Hafele/ebco make) approved sliders) ,. It shall consists of side cadenza of size 900mm x 450mm, comprising of 2 Nos 6" high drawer with locks, along the length of 900mm (3'-0") and shutter below with lock, all made with 18/19 mm thk plywood finished with 1.0mm thk laminate on all outer surfaces and 0.80mm thk balancing laminate of white colour on all inner surfaces. Rates should include all hardware like hinges, ballcatches, fully extendable drawer slides, locks, handles, magnets etc., of approved make. All exposed edges to have wooden lipping stained to match the desk and melamine finished.				
v	ZONAL MANAGER'S TABLE- Overall size : 7'-0" x 3'- 6" IN TEXTURED LAMINATE FINISH	NOS	1		
	Supply and fixing of Zonal Manager's table with top made up of 25mm thk ply and finished with 1.0MM THK TEXTURED LAMINATE of approved shade and make on top as approved by the architect and wooden beading/ moulding all round melamine polished. The table to include pedestal with two pencil drawers of 100mm deep & a file shutter of 450mm, wire manager, an keyboard tray, CPU trolley. The works to include all hardware like castors, brass hinges, ballcatches, fully extendable drawer slides, locks, handles etc. of approved make.Locks to be of single control type. All exposed surfaces to be finished with 1.0mm thk textured laminate of approved shade and make and all inner surfaces including the inner surfaces of the drawers and side cadenza should be finished with 0.80mm thk balancing laminate of plain ivory colour in matte finish. Rates shall also be inclusive of 12 mm thk clear glass with bevelled edges on all sides to be placed on the table top. All hardware fittings should strictly be of Haffle/ Hettich/Ozone make Only				
vi	DY. ZONAL MANAGER'S TABLE- Overall size : 6'-0" x 3'- 0" IN LAMINATE FINISH	NOS	1		

	Supply and fixing of Dy. Zonal Manager's table with top made up of 25mm thk ply and finished with 1.0mm thk laminate of approved shade and make on top as approved by the architect a. The table to include pedestal with two pencil drawers of 100mm deep & a file shutter of 450mm, wire manager, an keyboard tray, CPU trolley. The works to include all hardware like castors, brass hinges, ballcatches, fully extendable drawer slides, locks, handles etc. of approved make.Locks to be of single control type. All exposed surfaces to be finished with 1.0mm thk laminate of approved shade and make and all inner surfaces including the inner surfaces of the drawers and side cadenza should be finished with 0.80mm thk balancing laminate of plain ivory colour in matte finish. Rates shall also be inclusive of 12 mm thk clear glass with bevelled edges on all sides to be placed on the table top. All hardware fittings should strictly be of Haffle/ Hettich/Ozone make Only				
viii	DEPATMENT HEAD/ CHIEF MANAGER'S TABLE- Overall size : 5'-0" x 2'- 6" IN LAMINATE FINISH	NOS	5		
	Supply and fixing of table with top made up of 19mm thk ply finished with laminate of 1.0mm thk on top as approved by the architect and wooden beading/ moulding all round melamine polished. The table to include two pencil drawers of 100mm deep & a file shutter of 450mm, a wire manager, a keyboard tray and 250mm wide CPU trolley. The works to include all hardware like castors, brass hinges, ballcatches, fully extendable drawer slides, locks, handles etc. of approved make.Locks to be of single control type. All exposed edges to have wooden lipping stained to match the desk and melamine finished.Design and detail of the table shall be as per Architects design. All the visible external surface to be with 1.0mm thk laminate of approved shade and make and all inner surfaces should be finished with 0.80mm thk laminate of balancing laminate in white colour. Rates shall also be inclusive of 12 mm thk clear glass with bevelled edges on all sides to be placed on the table top.				
ix	SIDE CADENZA- OVERALL SIZE 3'-3"-3'-6" X 1'-3" X 2'-6"				
	Providing and laying side cadenza of above sizes and as mentioned in the drawing.It shall consist of 3/4" thk plywood top, side and bases and 1/4" thk back. The edges on th top shall be provided with suitable(as per architect's design)wooden moulding with melamine finish.A pair of 3/4" wood shutters will be provided which will slide on 1" x1" wooden battens above skirting. 1" a3/8" deep vertical depression shall be made on each shutters to act as handle as shown in the drawing. All external surfaces should be finished in 1.0mm laminate / veneer of approved shade and make. A 3/4" thk fixed ply wood shelf on battens shall be provided at 16" intervals from the base.Rates shall be inclusive of necessary approved fittings like sliding rollers, locks, tower bolts and any other misc. hardware items				
a	IN LAMINATE FINISH -OVERALL SIZE 3'-6" X 1'-6" X 2'-6"	NOS	1		
b	IN LAMINATE FINISH -OVERALL SIZE 3'-0" X 1'-6" X 2'-6"	NOS	5		
c	IN LAMINATE FINISH - OVERALL SIZE 4'-0" X 1'-6" X 2'-6"	NOS	1		
x	DINING TABLE OF OVER ALL SIZE- 3'-6" DIA IN LAMINAT E FINISH	NOS			
	Providing and making a table of over all size of top as mentioned above. It shall consist of ¾" thk. BWP. Ply top as per design (double edge on outer edge with 1 1/2" thk half round moulding on the edges) supported on ¾" thk. BWP. Ply verticals.supported on wooden base (as designed by the architect). Suitable wooden moulding as architect design with mellamine shall be provided to the edge of the top. All external surfaces to be finished in 1.0 mm laminate.				
xi	LUNCH PLATFORM (1' 6" WIDE) IN LAMINATE FINISH	RFT	9		
	Providing and laying platform of 1'3" to 1'6" width (Clear width) and at 3 '6" height (finished top level) from floor and finished with 1.0mm thk laminate of approved shade and make. It shall be laid on BWR ply wood 19mm thick supported on Steel L angle bracket. The plat form should be cantilevered from the wall as shown in the drawing. 9" wide 19 mm thick BWR ply wood to be provided below the entire lunch counter for tiffin and kitchen items. The ply surface to be painted with enamel paint after applying putty.				
X	DOCTOR'S TABLE WITH PATIENT INTERACTION TOP	NOS	1		
	Supply and fixing of table with top made up of 19mm thk ply finished with laminate of 1.0mm thk on top as approved by the architect and wooden beading/ moulding all round melamine polished. The table to include two pencil drawers of 100mm deep & a file shutter of 450mm. The works to include all hardware like castors, brass hinges, ballcatches, fully extendable drawer slides, locks, handles etc. of approved make.Locks to be of single control type. All exposed edges to have wooden lipping stained to match the desk and melamine finished.Design and detail of the table shall be as per Architects design. It shall also consist of an foldable/ sliding type elliptical top for pattient co-ordination & examination in 19mm thk ply and finished with 1.0 mm thk laminate of overall length 2'-6" and width 1'-8", folded inside the Doctors Table Top when not in used and pulled out whwn needed for use. All the visible external surface to be with 1.0mm thk laminate of approved shade and make and all inner surfaces should be finished with 0.80mm thk laminate of balancing laminate in white colour. Rates shall also be inclusive of 12 mm thk clear glass with bevelled edges on all sides to be placed on the table top.				
XI	INSPECTION BED WITH MATTRESS AND PILLOW	NOS	1		

	Supply and fixing Single bed for patient examination of overall size 800mm x 1800 mm, made with 19mm thk plywood sides, base and top and finished with 1.0 mm thk laminate of approved shade and make on all exposed surfaces and all inner surfaces should be finished with paint. The rate shall be inclusive of 2-3 inch high mattress along with a bedsheet and a pillow of shade as approved by the architect.				
F	FALSE CEILING & POP WORKS				
i	FALSE CEILING IN PLY WITH PAINT FINISH (PAINTING WILL BE MEASURED SEPARATELY)	S.FT.	12		
	Providing and fixing 12mm ply with necessary support from ceiling of 2"x2" Sal wood members provided at 2'-0" c/c and finished with paint of approved shade, with necessary primer etc. as per the approved design. (Painting will be measured separately)				
ii	FALSE CEILING IN PLYWOOD AND FINISHED WITH LAMINATE FINISH	S.FT.	42		
	Providing and fixing wooden ceiling with 12mm ply and necessary support from ceiling of 2"x1" Sal wood members provided at 2'-0" c/c as per design and as directed by the Engineer-in-charge/ architect				
iii	FALSE CEILING IN PLY WITH VENEER IN MELLAMINE POLISH	S.FT.	88		
	Providing and fixing 12mm ply with necessary support from ceiling of 2"x1" Sal wood members provided at 2'-0" c/c and finished in veneer with mellamine polish of approved shade.				
iv	PLYWOOD BOXING FOR T.V CONSOLE ETC	S.FT.	32		
	Providing and fixing plywood boxing made with 19mm thk plywood as per approved design and as directed by the architect/ EIC and finished of Solid Surface (CORIAN) of approved shade and make in approved design. (Note- The cost of corian shall be paid separately as per the item of corian panelling)				
v	FALSE CEILING - GYP BOARD	S.FT.	1720		
	Providing and fixing Gypsum false ceiling comprising of the following:				
	Framework: GI channel framework in 24 to 26 guage. The perimeter channel will be GI channel having one flange of 20mm and the other 30mm and web 27mm along the perimeter of the ceiling. It shall be screw fixed to brick wall / partition with the help of rawl plug of dimension 38mmx12mm dia fixed into the soffit at 610mm centres. The intermediate channels of size 45mmx0.9mm thick with flanges of size 15mm each shall be suspended from ceiling using angle of size 25mmx10mmx0.55mm spaced not more than 1220mm c/c which are fixed to soffit with GI 27mmx37mmx25mmx1.6mm cleat and steel expansion fasteners. Ceiling section of 0.55mm thickness having curled web of 80mm and flanges of 26mm are fixed to intermediate channel with the help of connecting clip of 2.64mm dia perpendicular to intermediate channel at 457mm centre to centre.				
	Ceiling Board: Gypsum board false ceiling of India Gypsum make - Plain Gypboard: Milky white colour of 12.5mm thickness shall be fixed to the ceiling section using 3.5x25mm corrosion resistant self-tapping zinc plated dry wall screw at 230mm centres				
	No additional load like light fittings etc. shall be directly put on the ceiling frame. Separate suspension system shall be adopted for the same.				
	NOTE: The rate shall be inclusive of vertical drops/ bands upto 6-8" and provision for core lighting, small moulding, verticals in two levels, 18.75mm x 12.5mm grooves on the edges, cutouts for cove lights and AC grills				
	Note Only the plan area will be measured for payment. No Extra payment will be made for Grooves, Cutouts, Mouldings etc.)				
vi	2' X 2' GRID CEILING- DUNE MAX MICROLOOK of, SILHOUETTE series of Knauff Armstrong make	S.FT.	1040		
	Providing & fixing in position Acoustical Ceiling tiles of Armstrong -DUNE MAX MICROLOOK or approved equivalent make, SILHOUETTE series , in true horizontal level suspended on inter locking Grid system using hot dipped galvanized steel section, entire surface prefinished in baked polyester paint, rotary stitched double-web construction main Beam tee of size 42x15mm - 6mm reveal at every 600mm c/c maximum and double rotary stitched cross tee of size 42x15mm - 6mm reveal at every 600mm. c/c and Shadow moulding of size 19mm X 7mm X 7mm X 14mm fixed to periphery of the wall. The tiles and grid system to be used as follows:				
	TILE SIZE: 600mm X 600mm X 15mm				
	EDGE : DUNE MICROLOOK				
	FRAME WORK & INSTALLATION - silhouette section				
	Frame work to consist of:				
	Main Runner spaced at 600 mm center, fixed to the roof at every 1200mm c/c by using 2.0 mm thick pre-straightened GI wire. First and last hanger should not be at a distance more than 450mm from the adjacent wall				
	600mm x 600mm module to be formed by fixing 600mm Cross Tee between center of Main Runner.				
	Shadow moulding to be secured to wall at 450mm centers. Installation to be done as per approved Manufacturer's specification.				
G	POP PUNNING, WALL PUTTY & PAINTING WORKS				
i	POP PUNNING FOR GYPSUM CEILING	S.FT.	1850		

	Providing and applying POP Punning on Gypsum Ciling (average 6mm thk). The rate shall include scrapping, levelling and preparing the surface. The rate shall include scrapping, levelling and preparing the surface. The rate shall be inclusive of all types of grooves above the skirting, around the windows and door frames. If the average thickness is found to be 4mm or less than POP will be considered as a putti finish and the rate shall be 50% of the quoted rate				
	WALL PUTTY ONLY IN HALL AND CUSTOMER AREAS	S.FT.	980		
	Providing and applying Wall Putty on walls and columns (average 12mm thk). The rate shall include scrapping, levelling and preparing the surface. The rate shall be inclusive of all types of grooves above the skirting, around the window and door frames. If the average thickness is found to 8mm~6mm or less, then Wall Putty will be considered as pulti finish - at the rate of - 50% the quoted rate (Make: Birla / Asian / Despal)				
	PLASTIC EMULSION ON GYPSUM CEILING	S.FT.	1850		
	Providing & applying plastic emulsion paint on walls, columns & ceilings. The rate shall include scrapping, levelling & preparing the surface. Primer coat + (minimum) 3 coats to get evenly spread quality finish (roller finish) of approved make , quality & finish shall be provided.				
	LUSTRE PAINT ON WALLS	S.FT.	980		
	Providing & applying Luster Paint on walls, columns & ceilings. The rate shall include scrapping, levelling & preparing the surface. Primer coat + (minimum) 3 coats to get evenly spread quality finish (roller finish) of approved make quality & shade shall be provided				
	ENAMEL PAINT IN EXISTING ROLLING SHUTTER, WINDOW GRILLS & OTHER M.S WORKS	S.FT.	156		
	Providing & applying 1 st quality oil paint of approved make, quality & shade. The rate shall include scrapping, levelling & preparing the surface with primer quote.				
	DISTEMPER PAINTS FOR WALLS (TOILETS, STORE, UPS AND STRONG ROOM)	S.FT.	1500		
	Providing and applying Distemper paint on walls , columns & ceilings. The rates shall include scrapping, levelling & preparing the surface. Primer coat +(MINIMUM) 3 coats to get evenly spread quality finish(roller Finish) of approved make, quality and finish shall be provided.Note- Rates shall also include - filling up the cracks in the wall & ceilings, making good surface .				
	TEXTURED PAINT	S.FT.	216		
	Providing & applying a coat of textured finish on walls and columns. The rate shall include scrapping, levelling & preparing the surface. Primer coat + (minimum) 3 coats of approved make, quality & shade shall be provided				
H	ROLLER BLINDS, VERTICAL BLINDS, FILM etc.				
	VERTICAL BLINDS	S.FT.	256		
	Supplying and Fixing VERTICAL BLINDS Vista/Mac/Parytex make. Blinds made using 100% polyester with acrylic polymer coating, of the shade and colour as approved by the Arcitect/ Bank ffficial(only for external windows. In case of using blinds on any internal partition, prior approval from the Architect/ Bank should be obtained otherwise tne payment for the same quantities shall not be considered)				
	ROLLER BLINDS IN ZM'S CABIN , ANTE ROOM AND CONFERENCE ROOM	S.FT.	298		
	Providing and fixing of Vista or Equivalent Roller Blinds having openness factor 3%, Weighted composition 75% PVC,25% Polyester with fabric thickness 0.6 to 0.7mm, 250cm of maximum width at 470 gsm(+ or - 5%) fabric weight conforming to the Fire resistance NFPA 701,BS 5867 part - 2 type A, with required colour fastness to light grade of 6 & UV Blockage up to 97% and Hardware consist of Control unit, Idler, Head rail, Roller tube, Bottom rail, Operating chain and Fixing brackets & clamps complete as per the hardware specifications as described below .The cost inclusive of supply,transport and fixing of Roller Blinds all complete making good to window /opening as per the directions of Engineer-In- Charge. The detailed item specifications are as under-				
	Control unit: The Control unit is made of high strength reinforced plastic. The clutch is of wrap spring design. High carbon steel springs are provided to transmit motion from driving to driven members of clutch Mechanism. Clutch is operated directionally by the use of endless beaded chain. Clutch never needs any Adjustment				
	Idler: Idler is of high strength reinforced plastic, consisting of a center shaft. The idler is mounted on the Bracket by using a plastic lock. The metal sleeve inside the plastic lock provides bearing surface for the Center shaft, which rotates freely, providing smooth, quiet and long wearing operation.				
	Roller tube: tt is an anodized extruded tube of high strength alloy. Control unit and Idler are fixed to the either ends of the tube. The fabric of the blind is fitted to the tube with heavy duty adhesive tape.				
	Bottom rail: It is an aluminum extruded rail with a groove for fixing the fabric and power coated in white. It is fixed to the bottom of the fabric and the purpose of it is, to keep the fabric in tension and straight. The fabric is fitted to the tube using plastic insert. The end caps of the tube are ABS.				

	Operating chain: This is made of 4.5mm plastic beads molded on 2.2mm thick polyester chord. The pitch of the beads is 5mm. The chain drives the sprockets of the control unit to close and open the blind. The pitch of the chain corresponds to the sprocket in perfect match for trouble free operation.				
	Fixing brackets & clamps: These are used to fix the blind to the wall or ceiling. 'L' bracket is made of mild steel and zinc plated. The clamp is made up of spring steel of thickness 0.7mm and zinc plated.				
	Roller tube : It is Aluminum alloy Extruded grooved tube, which is anodized. Size- 32mm- O.D.; weight - 0.27 kg/mtr / Size- 38mm- O.D.; weight - 0.38 kg/mtr Alloy & temp- 6063-T6 Fabric is fitted on the tube with double sided tape				
	Bottom Rail : Extruded Aluminum grooved section- powder coated in white, Size:21mm O.D. Alloy- HE9WP, Weight-0.28 Kg/mtr. Fabric is fitted to the bottom rail with plastic insert. Bottom rail end cap- made of ABS ,Bottom Rail: Extruded Aluminum grooved section- powder coated in white, Size:21mm O.D., Alloy-HE9WP, Weight- 0.28 Kg/mtr.				
I	FROSTED FILMS/ SUN CONTROL FILM				
i	Sun Control Film	S.FT.	380		
	Providing and fixing in position Sun control film of approved make and shade with required frosting pattern on the glass surface complete as per the directions of EIC/ Architect (Payment shall be made for the finished area of the film actually provided. No deduction shall be made for openings upto 0.1 Sq.m. area each and nothing shall be paid extra for making such openings.)				
	Garware make - Grey 5				
	3M - CRYSTAL GLASS FINISHES 7725 SE325				
J	MISC. ITEMS				
i	COLOURED DESIGNER FROSTING FILM IN CONFERENCE ROOM , ENTRANCE DOOR & DZM'S CABIN	S.FT.	340		
	Providing and fixing Non-reflective matte, frosted, scratch resistant, high performance resin coated polyester film with required coloured frosting pattern on the glass surface complete as per the directions of EIC/ Architect (Payment shall be made for the finished area of the film actually provided. No deduction shall be made for openings upto 0.1 Sq.m. area each and nothing shall be paid extra for making such openings.)				
ii	COLOURED ACRYLIC SHEET LOGO FOR THE BANK, BACK LIT				
	Supplying , fabricating and installation of Canara Bank's Logo of 2 Nos of Triangle (Blue and yellow colour) made of coloured acrylic sheet 5-6mm thk in box section, and as per the sizes as mentioned in the detailed drawings . This Coloured Acrylic sheet box logo should be fixed with strip light fitted from inside , as per the direction of the architect.				
a	OVERALL SIZE 750MM X 750MM	NOS	1		
b	OVERALL SIZE 450MM X 450 MM	NOS	4		
iii	INCUMBENCY BOARD	NOS	1		
	Supply and Fixing of Incumbency Board in ZM's cabin or at place as directed by the Bank officials/ architect, of overall size 2'-6" to 3'-0" x 5'-0", made up of 6mm thk acrylic sheet fixed to wall with 4nos S.S Studs and pasted with Vinyl film over it				
iv	MAGNETIC WHITE BOARD				
	Providing and fixing of magnetic white board of approved make scratch resistant matt finish P3 surface consisting of ceramic steel of thickness 0.55mm to 0.65 mm, having a weight of 3-4 kgs per sqm. The core material shall be of interior grade 9mm thickness with density 700 to 800 kg/cum. With a backing of galvanized steel of 0.25 mm thickness having approximate weight of 1.96 kgs/sqm. This entire assembly shall be housed in an anodized aluminum extruded section conforming to IS-6477 and IS-3965/2673 and corners of moulded ABS. The front and back surface will be affixed with 10-15 micron silver matt satin finish. This should be provided with clamp for hanging arrangement with locking facility including one set of accessories comprising of magnets, magnetic dry markers and magnetic				
a	4' x 6' (1200mm x 1800mm)	NOS	1		
xi	PIN-UP BOARDS	S.FT.	66		
	Providing and fixing pinup boards. It consist 12mm thick soft boards of good density to be mounted over 12mm thick BWP. ply. The soft board will be covered with a plain fabric (approx Rs.250 /Rmts. of Dark Blue Colour) from front and edges. Suitable steam beach moulding 25mm x 25mm size to be fixed on all four sides and will be finished in melamine polish				
	Note : Only soft boards provided on other than the partitions will be measured and soft board made in the partitions will be the part of the partition measurement (rate) and not consider separately.				
xii	ROLLING SHUTTER WITH APPROVED SHADE OF ENAMEL PAINT				
	Providing & fixing M. S. Rolling shutters (18gauge sheets) for the facade openings (middle 1/3rd grill). Rate shall include all necessary locking arrangements. 2 coats of anti rust paint to be provided for the shutter and finally finishing with Enamel paint of approved shade on both sides	SFT	70		
xiii	MAP OF NORTHEASTERN STATES ON ACRYLIC BOARD				

	Supplying & Fixing Map of Northeastern states on Coloured vinyl fim and fixed on 4/5mm thk acrylic board of maximum size 8'-0" x 4'-0", showing different states of Northeast with important places of each state	Nos	1		
K	BOUGHT OUT FURNITURE				
1	SOFAS				
1	Providing and supplying Sofas of approved make and colour. Sofas shall have mild steel chrome plated legs finished with leatherite.				
a	Two seater Leatherette Sofa in black colour	5	NOS.		
b	Single seater Leatherette Sofa in black colour	2	NOS.		
c	Two seater Tadem Sofa with Cushioned seat and back in chrome finish		NOS.		
A	TOTAL OF CARPENTRY WORKS				

BOQ FOR ELECTRICAL WORKS OF PSB Zonal Office, Guwahati

GENERAL NOTE

1	UPS input and Output wiring should be done with FRLS Insulated stranded copper conductor laid through M.S Conduit. (From input DB to UPS and from UPS Output to UPS Output DB)
2	All wires for circuit wiring and other wiring should be drawn inside M. S. Conduits Only unless otherwise specified
3	Specifications of all wires should be followed strictly as mentioned in the BOQ
4	All makes of materials should be strictly followed as mentioned in the detailed specifications of the Tender document
5	Earthing Test Certificate should be provided alongwith the Final bill for further bill verification
6	Single Line diagram showing the all the wiring including point wiring, computer and RAW power wiring, Circuit wiring etc. all complete should be submitted with the Final Bill
7	Only DATA and Voice point wiring is allowed to be carried out through MS Conduits

PART C :- ELECTRICAL WORKS

Sl. No	Description	Unit	Qty	Rate	Amount
SECTION-A					
I	MAIN LT PANEL				
1.1	Supplying and installation of metal enclosed wall/ floor mounted front operated cubical type switch gear panel suitable for indoor installation conforming to IS: 8623 (Part I & II). Panel should be made of sheet steel and thickness not less than 2mm and structural steel having light section. The panel shall be completely dust tight and vermin proof and shall be painted with anti corrosive and anti condensation type two coats of primer and two coats of paint. All wiring shall be PVC insulated and PVC sheathed of 1100 volt grade of required size. The panel should have provision of entry of cable at the bottom and also provision of out going feeders from the bottom of the panel.It shall have compartmentalized construction with bus bar chambers, cable alley, cable glands plate etc. as required, duly painted from inside as well outside. The panel shall incorporated double busbar system. There should be 2 sets of BUS BAR in such a way that AC load should not be connected to GENERATOR power. The bus bar shall be of high quality copper of uniform cross section. The panel shall consist of the following items (viz. voltmeter, ammeter, CT, indicating lamps, selector switch etc.) connected as per drawing and shall be flush mounted on the front of the panel.				
a	Incomer :- 150A 4P 50KA MCCB - 1 No				
b	Outgoings :- 1 Nos. 40Amp. TP MCB (For LDB, UPS, Inverter and Spare Feeder) from Generator Powered Bus. 3 Nos. 63 Amp. TP MCB (For PDB, UPS, Inverter and Spare Feeder) from Generator Powered Bus. 2 Nos. 63 Amp. TP, MCB (For AC DB and Spare Feeders) from Non-Generator Powered Bus. 8 Nos. 63 Amp. TP, MCB (For cassette ACs and Spare Feeders) from Non-Generator Powered Bus 1 Nos. 40 AMP DP MCB. 3 Nos (for Glow Sign board, Strong Room, and spare feeder) from generator Powered Bus. The design of panel should be got approved by the Architect before manufacturing. Also, the provision for 1/2 spare outgoings should be considered for future expansion. The job shall be completed to the satisfaction of the Bank.				
c	1 no., 0-400A, Ammeter with CT and selector switch				
d	1no., 0-500V, Voltmeter with selector switch and fuse				
e	1Set, TPN, Copper busbars of size 40mm x 10mm thk PVC insulated suitable for 640 Amp load				
f	1 Set, RYB, indicating lamps with resistors and fuses				
	Full Set as above	Set.	1		
1.2.	CHANGE OVER				
	Supplying with fitting and fixing Four Pole 415V Front handle operated On Load Change over switch (IP-20 protection powder painted sheet steel enclosure fitted on angle iron frame of the following capacity complete with making necessary connection as approved, specified and directed by the deptt.				
	C&S, Havells, Indo Asian, HPL, GECO make)				
	a) 163A	Each			
SECTION-B					
2	MCCB DISTRIBUTION BOARD				
	Supplying, installation, testing and commissioning of surface/recess mounting, 220/415 volts prewired MCCB distribution boards with all switchgears as specified below, of sheet steel, dust protected, duly phosphatized and powder painted, inclusive of 200 amps tinned uniformly rated electrolytic copper busbar, common neutral link, earth bar, din bar for mounting MCCB/MCCB/RCCBs detachable gland/knock out plates and with built in loose wire box, and superior make terminal connectors for all incoming and outgoings circuits, duly prewired with adequate size of FR PVC insulated copper conductor upto the terminal connector/neutral link and ready for installation as specified below:				
2.1	S.I.T.C. Of L.D.B. [MCCB DB- LIGHT] (LIGHT DB)				

	S & T of 4 Way TPN (8+12) IP 43 PPI Horizontal Distribution Board for distribution to all Light points of different areas (as indicated in the circuit diagram), having below mentioned switchgears (Earth bar inside these DB should be insulated from the body) - 40A, 10kA, TPN MCB as incomer - 1 Nos, output directly connected to 1 No of 40 A TPN RCCB (30 mA) 6 (10 Amp (10 KA) SP MCB as outgoing - 10 Nos Note- Rates Shall be inclusive of S.I.T.C. of sub main line-3X 6+1x4 Sq.mm. F.R.L.S. copper flexible wires in 19/20 mm. MS conduit from Main D.B To L.D.B	No.	1		
2.2	S.I.T.C. Of P.D.B. [MCBDB-POWER] (Raw Power DB)				
	S & I of 6 Way TPN (8+18) IP 43 PPI Horizontal Distribution Board for distribution to all raw power points of different areas (as indicated in the circuit diagram), having below mentioned switchgears (Earth bar inside these DB should be insulated from the body) - Incomer 63Amp 10kA, TPN MCB - 1 No .output directly connected to 1 No of 63 A TPN RCCB (30 mA) 16A SP MCB-1 Nos. 10A SP MCB- 17 Nos. with all wiring connections.(Max. 3 Points to be looped on one MCB, 4 nos. in exceptional Note- Rates Shall be inclusive of S.I.T.C. of sub main line-3X 6+1x4 Sq.mm. F.R.L.S. copper flexible wires in 19/20 mm. MS conduit from Main D.B To PD.B	No.	1		
2.3	S.I.T.C. Of ACDB [MCB DB- AC] - If Required as per Bank approval				
	S & T of 4Way TPN (4+12) IP 43 PPI Horizontal Distribution Board for distribution to all AC points of different areas (as indicated in the circuit diagram), having below mentioned switchgears (Earth bar inside these DB should be insulated from the body) - Incomer 63Amp 10kA, TPN MCB - 1 No Outgoing- 25A SP MCB-7 Nos Note- Rates Shall be inclusive of S.I.T.C. of sub-main line 4 x 6.0mm² + 2x4.0 mm² F.R.L.S. copper flexible wires in 19/20 mm. Medium Gauge MS conduit from Main Panel To ACDB	No.	1		
2.4	MCBDB for UPS POWER				
	18way SPN DB IP 42 IK 09 with metal Door - 1 No.				
	Incomer				
	63A DP MCB - 1 No.	No.s	1		
	Outgoing				
	16A SP 10 KA MCB - 16 Nos.				
	Note- Rates Shall be inclusive of S.I.T.C. of sub-main line 4 x 6.0mm² + 2x4.0 mm² F.R.L.S. copper flexible wires in 19/20 mm. Medium Gauge MS conduit from Main Panel To ACDB				
2.5	MCBDB/UPS-SERVER & EMERGENCY LIGHT				
	8way SPN DB IP 42 IK 09 with metal Door - 1 No.				
	Incomer				
	32A DP MCB - 1 No.	No.s	1		
	Outgoing				
	10A SP 10 KA MCB - 4 Nos.				
2.6	S.I.T.C of 32A DP MCB in Metallic box for UPS I./P.& O./P.	No	2		
	SECTION-C				
3	CABELS / MAINS				
	All cables / wires shall be routed through PVC conduits / bends / elbows etc., as required, of appropriate dia. The conduits shall be clamped firmly to the walls / columns / pillars etc. with clips / clamps and fasteners rigidly even if above false ceiling. Complete job shall include cutting chiseling in walls, floor and making good of all chases / cuts etc. with combination of cement-mortar, including painting with type and shade of existing wall. The work shall be completed to the satisfaction of Bank. NO CABLE / WIRE / CONDUIT SHALL BE VISIBLE IN THE BRANCH HALL / CUSTOMER LOBBY / STAFF WORKING AREA.				
3.1.	SITC of 3.5 Core 50.0 Sq.mm Cu conductor Armoured Cable for Generator line connection up to Main Panel Unit complete in all respect as required	Mtrs	0		
3.2.	SITC of 3.5 Core 35.0 Sq.mm Cu conductor Armoured Cable for service line connection up to Main Panel complete in all respect as required.	Mtrs	30		
4	POINT WIRING				
4.1.	Supply & Installation of concealed point wiring using 600v grade 2.5 sqmm copper conductor PVC insulated wires (with proper R,Y,B color code) pulled through haevy gauge PVC conduits laid concealed over false ceiling or in wall chases including circuit wires from the relevant DB and also including 1.5 Sq.mm Green Colour Copper earth wire and provision of grid plate type (ROMA) switches and sockets as approved by Bank / Architect. Each circuit feeding not more than 8 points / 800 W as per the following configuration				
a	Primary light points including the cost of 6A switch (Single Point-45 Nos. Double Loop Points-46Nos, Triple Loop point-26 No.)	Pts	117		

b	Primary light points including the cost of 6A switch in UPS Power	Pts	14		
c	6A plug point as primary point. [SO]	Pts	54		
d	Secondary 6A Plug point on switch board. [SO]	Pts	3		
e	16A Plug Point directly taken from DB for hotplate/geyser / zerox / fridge [P]	Pts	2		
f	Exhaust fan/ Wall Fan point consisting of 6A socket near fan and switch on light switch board	Pts	18		
g	<u>S.I.T.C. of Timer with M.C.B.'s control for Sign Board of Branch.</u> - Wiring for Signages with 2R x2.5 Sq.mm and 1 Rx 1.5 Sq.mm, PVC insulated copper conductor flexible cable to be connected to the SPN D/D consumer along with a Timer and Contactor unit installed in Electrical Room room.	Set	2		
h	S.I.T.C. of call bell with bell point .	Nos.	2		
5	COMPUTER/ RAW POWER WIRING				
	Note- All sockets should be placed below the workstations as mentioned in the drawings but the controlling switch should fixed above the work stations and at place as directed by the architect				
5.1.	S & I of point wiring for UPS or stabilized power plug points on workstations / table for computers using 3C X 2.5 Sqmm Cu. PVC sheathed white color flexible cable pulled through above False ceiling and cutting the walls as raceways are not provided and taken upto table top using PVC rigid or flexible conduits run within wooden or metal partitions. Each point consisting of 3 Nos of 6A/16A 2 / 3 Pin sockets and 1 No 16A switch, wired together forming one point. Switches and sockets to be (ROMA). Earth wire to be of Green colour only. (Only 2 tables served by one circuit from UPS DB) Cost is inclusive of necessary cutting the walls and including PVC Pipe required for taking the wires. [SOC]	Pts	45		
5.2.	S & I of points similar to above but to be used as raw power point on the tables consisting of one 6/16A socket with switch of other color and flexible cable of black color & circuit taken from Raw Power DB (2 tables (Maximum 3) served by one circuit from LDB/PDB) Taken Above False ceiling and through walls/ partitions inside M.S. Conduits as raceways are not provided. Cost is inclusive of necessary cutting the walls and including M.S. Conduits as required for taking the wires.	Pts	50		
	SECTION-E				
6	LIGHTING FIXTURES (Bajaj or equivalent)				
6.1.	S & I of lighting fixtures as per the details given below including necessary hardware such as clamps,nuts, bolts, nails, screws and suspension chains as required for fixing the fixtures in position as directed by architect / Consultant.				
a	<u>PANEL LIGHT</u> - High efficacy, recess-mounted panel with white powder coated CRCA housing and full mounted acrylic diffuser (1'x1'), 120 Lm / W for 18 W and 120 Lm, Model- as approved by the Engineer-incharge/ Architect. [PL]. <u>3 Years written warranty from Company side to be submitted with the Final Bill</u>	Each	25		
b	<u>PANEL LIGHT</u> - High efficacy, recess-mounted panel with white powder coated CRCA housing and full mounted acrylic diffuser (2'x2'), 120 Lm / W for 36 W and 120 Lm, of overall dimensions - Length: 595 mm , Width: 595 mm & Height: 35 mm , Model- and make as approved by the Engineer-incharge/ Architect. [PL]. <u>3 Years written warranty from Company side to be submitted with the Final Bill</u>	Each	34		
c	<u>DOWN LIGHT [DL]</u> - Maintenance-free, round downlight with die cast aluminium housing and sleek backlit design suitable for low height ceiling, 15 W , 6500 CCT(K), having cutout: Ø105 mm, Overall Dimension: Ø120 x 28 mm, Model- Areva Prime , having Item Code- IDL-WHT-LARP01R015XC , Wattage-15W, CCT (K)- 6500 K, of M/s Jaquar or equivalent make as approved by the Engineer-incharge/ Architect. [PL]. 3 Years written warranty from Company side to be submitted with the Final Bill	Each	53		
d	<u>Down Light</u> -S.I.T.C. of12/13 Watt 6000/6500 K,(≥720 lumens) Recessed/Surface mounted LED Down Lighting Fixtures with fixing accessories. As Emergency Ligh	Each	14		
e	SITC of Ceiling Profile Lighth Type TruGroove, Installation/mounting type Recessed, Color Temperature Tc (K) 3000 / 3500 / 4000 Housing (Material And Finish) 3/4" to 2" thick Extruded thick aluminum trim/Section and die-cast endplates, System Wattage 20W, Classifications (IP/IK) IP20, Cover (Glass/ PC) Poly carbonate, Electrical Class II,/ LED Lamps 240Nos/Mtr (LM26) 5 mtr roll with LED Driver lumens Including cost of 3/4" to 2" thick Aluminum Channel Accessories complete as required (Make IP Mac, Sanspa, Helius,)	RFT	44		
f	Mirror light in Toilet (Wall mounted decorative luminaire suitable for 1x15W CFL B22 cap.).	Each	5		
g	MODERN CHANDELIERS at reception- Chandelier with Solid Glass Rod and Brass Finish (D 650 x H 1320 MM), Model- Capella, having item code- DMO-BRS-SL12024X6L, of M/s Jaquar or equivalent make as approved by the Engineer-incharge/ Architect [PL]	Each			
h	<u>ROPE LIGHT</u> - Supply and fixing of IP65 LED Rope Light in POP/ Wooden cove as per design and as directed by the architect, having Rated input voltage-220-240 V AC of Cool White or desired colour, having product Item Code- STH-WHT-LJNP01S060XC, of 45 meter roll, cuttable to required sizes and suitable for indoor application alongwith all drivers and necessary accessories as required , of M/s Jaquar or equivalent make as approved by the Engineer-incharge/ Architect. [PL]. 3 Years written warranty from Company side to be submitted with the Final Bill	Metres	98		
i	2' wide Tubelights T5 14 Watt	No	9		

j	Energy saving, environmental friendly, long life, exclusive innovative die-cast aluminium IP66 flood light 80-100 Watt, suitable for highlighting architectural façade and general purpose lighting	Nos.	2		
f	Supplying including fitting fixing of following star rated Plastic Blade, new 450 mm dia bracket/wall fan of Ivory Colour , complete with all accessories of following sweeps with making necessary connection cable, as approved by the Deptt.s etc. as required complete and as directed by the Department .				
	a) 450 mm sweep [WF]	EACH	14		
g	Supply and fixing of 10" - 12" Metal bladed exhaust fans with louvers.[EF]	EACH	4		
SECTION-F					
6	EARTHING				
	Rate for Earthing under this head shall be inclusive of the cost of Copper Strip 25mm x 5mm for Copper Earthing upto a length of 15metre per earthing. Payment shall be made only for length in excess of 15 Metre				
6.1.	Supply, Installation, Testing and Commissioning on Maintenance free Chemical Earth Electrodes complying with the latest version of IS 3043 / IEC / IEEE Specifications. The Earth Electrode shall be with 3 M long, 17 mm. dia high tensile strength, copper bonded Steel Rods coated with minimum 250 micron pure eletrolytic Copper. Soil enrichment compound in quantities not less than 10 Kgs shall be used and the Earth Pit shall be back-filled with good quality soil without any Stones / Granules / Sand etc. The Earth Station shall be provided with suitable requisite Copper / GI terminals, 450 x 450 mm brick	Each	2		
6.2	Providing & fixing (Excess above 15Metre Length)25 mm x 5 mm Cu strip on surface or in recess for connection as required.	RM	110		
SECTION-G					
7	WIRING FOR DATA AND VOICE OUTLETS				
7.1	Supplying, laying and termination of 4 pair Copper solid, twisted pair G600 CAT--6 cables through specified dia MS conduits / raceways. Cables must meet and exceed category 6/ class E standards requirements in ISO/IEC11801, CENELEC EN50173 & TIA 568-B2-1. and providing & terminating with RJ-45 (Krone make) with face plates / I/O Ports in suitable modular / MS box from server / EPABX room to individual work stations and terminating other end with RJ-45 connector including numbering with ferule. Note- Rates shall be all inclusive as mentioned in the description above and the payment for the same item shall be made on the number of points provided based on the above description.				
a	Outlets with Back Box & Single Face Plate & Termination Of LAN Cable etc. of Compscope/ D'Link Make (Including One extra in IT incharge/ Security , one each at ZM's table,1 No for CCTV, 7 nos at conference table)	Nos	12		
b	Same as above but with Double Face Plate & Termination Of LAN Cable etc. of Compscope/ D'Link Make	Nos	38		
c	Tesing, Labelling, scanning of I/O Nodes & submission of report.	Nos	88		
d	S.I.T.C. of Fully loaded 3-4 Nos 24 port Jack Panels of required port as per the above LAN points	Nos	1		
e	S.I.T.C. of Managed Switches 10/100 MBPS for above LAN Points	Nos	1		
f	S.I.T.C. of 3 Ft. Factory Crimped Mounting Cords Same Makes as in Item no b.	Nos	88		
g	S.I.T.C. of 7Ft. Factory Crimped Mounting Cords .Same Make as Item No b.	Nos	88		
h	S.I.T.C. of VALRACK/PRESIDENT etc Network Rack (42 U with 5/15 PDU, Cable manager, Fan, Tray etc. all complete) or of required size as per above LAN Points with proper dressing of cables	Nos	1		
7.2	Providing and laying Cat 5 cable (Make: D-Link) for voice through specified dia PVC conduits / raceways for voice and providing & terminating with RJ-11 (Krone make) with face plates / I/O Ports in suitable modular / MS box from server / EPABX room to individual work stations and terminate the other end with RJ-11 connector or on a Crone module with numbering of each cable with Ferule. Note- Rates shall be all inclusive as mentioned in the description above and the payment for the same item shall be made on the number of points provided based on the above description				
Note- All Voice outlet should be fixed above the work stations and at place as directed by the architect					
a	RJ-11 for Voice (THROUGH FALSE CEILING AND WALL)	points	24		
7.3	Supplying, laying and fixing of PVC telephone flexible wire through specified dia PVC conduits / raceways of following size: (Rates Shall be inclusive of the cost of PVC Conduits of required sizes)				
a	20-pair	mtr.	180		
7.4	Cat 6 Jack Panel of required sizes as per Voice points	No.	1		
7.5	SS Rack of required sizes as per Voice points, Mount Recessed Frame for Voice Terminations	No.	1		
8	A.C POINT WIRING				

	A.C. power point wiring from AC DB (As per SLD) with 1100 volt grade 2 Nos. single core 6 sq.mm. + 1 No. 4 sq.mm. (Green colour for earthing) PVC insulated flexible FRLS copper conductor cable through suitable size M.S. conduit (ISI marked embossed on conduit surface) complete with junction box, circular box, elbows, bends, couplers and other accessories on surface above false ceiling or concealed by chase cutting on wall complete with North-West make AC power unit having 25A DP MCB with enclosure, 25A Socket, 20A Starter, mounting box & front plate, interconnection, mending good all damages to original finish, painting etc. as required. All connections of wires to be done by means of 'Wago' type connectors. Each Ac will be connected through Inverter to be located near the ACDB. Rates shall be inclusive of cost of	NOS	15		
9	MISCELLANEOUS WORKS				
9.2	4 Pole 100 Amp Manual Changeover Switch For Mains to D.G. supply switching (If D.G. Back-up is provided). Rates shall be inclusive of complete wiring and no payment for wiring shall be entertained for this item of work	No	1		
10	CONFERENCE ROOM'S WORKS				
10.1	DESK TOP UNIT (POP-UP BOXES) FOR CONFERENCE TABLE	EACH	7		
	Supply, installation, testing and commissioning of LEGRAND make Aluminium floor adaptor power outlets of 8 module pop-up box with LEGRAND ARTEOR 3 no. of 6 A, 240V modular socket (Shuttered) controlled by 1 no. 16 A modular switch, module plates etc. in complete. The pop-up boxes are to be flushed and concealed inside the furniture surface along with making good to the furniture to uphold the architectural beauty. The outlets are to be terminated and wired by 2 X 2.5 sq mm (P+N) + 1 X 2.5 sq mm (E) FRLS Copper conductor of 1.1 KV grade from the Power DB through pre laid conduits/ raceways upto a maximum of 20 mtrs. Rates shall be all inclusive including the cost of POP up Box, Switch, Sockets, Lan Point, Wiring, conduits, end terminations, etc all complete.				
10.2	S.I.T.C. TV Coaxial Cable for TV Display	Mtr	20		
10.3	S.I.T.C. of TV Coaxial Cable Socket Outlets with moulded Front Plate G.I. anodized enclosure in/on wall with other associated accessories including chasing/ embedding etc.	No	1		
10.4	S.I.T.C of surface mounted 16 Watt External Speakers for Conference room	No	8		
10.5	S.I.T.C of 200 watt 4 Zone amplifier of Ahuja make for above speakers (For Conference Room)	No	1		
10.6	S.I.T.C.embedded microphone of Bosh/ Ambhujia/ F&D / JBL/ AKG/ Portonics with button less switch along with accessories & automation ALL COMPLETE	No	11		
C	TOTAL OF ELECTRICAL & OTHER RELATED WORKS				

ESTIMATE FOR AIR-CONDITIONING WORKS FOR GUWAHATI ZONAL OFFICE OF PSB

SNO	DISCRPTION	UNIT	QTY	RATES	AMOUNT
	Note- All A.C should be of 5 Star Rating only				
1	Supply, Installation, Testing & Commissioning of 5 Star 3 Ton Ceiling mounted “Cassette” Air- Conditioner by cutting false ceiling & comprising of Indoor & Outdoor units. The Indoor unit comprising multi-row DX cooling coil, Drier, expansion valve/device , air blower driven by motor with mounting accessories. Outdoor unit will comprise the Rotary/Scroll compressor, condenser coil & fan, Cordless remote controller etc. including Refrigerant gas charging , water drain system etc.	Nos	1		
2	Supply, Installation, Testing & Commissioning of 5 Star 2.5 Ton Ceiling mounted “Cassette” Air- Conditioner by cutting false ceiling & comprising of Indoor & Outdoor units. The Indoor unit comprising multi-row DX cooling coil, Drier, expansion valve/device , air blower driven by motor with mounting accessories. Outdoor unit will comprise the Rotary/Scroll compressor, condenser coil & fan, Cordless remote controller etc. including Refrigerant gas charging , water drain system etc.	Nos	4		
3	S.I.T.C. of 5 Star 1.0 Ton capacity High wall mounted Split A.C. comprising Indoor & Out-door units. Indoor unit comprising Multi Row DX cooling coil, expansion valve, drier, motor driven air-blower with metallic frame etc. Out-door unit will have rotary/scroll compressor, condenser coil, & fan, Cordless remote control unit etc. including refrigerant gas charging.	Nos	3		
4	S.I.T.C. of suitable voltage stabilizers for above capacity Air-Conditioners.(Make : V-Guard / Microteck only to be Provided)	Nos	3		
5	S.I.T.C. of 19 mm dia & 16 mm dia Copper Refrigerant Pipes with Foam insulation between Indoor & Outdoor units.with breaking of wall wherever required for 2-3 Tr Cassette/ Inverter Air conditioners.	Mtr.	88		
6	S.I.T.C. of 12.5 sq.mm. & 6.25 Sq.mm. dia. Copper refrigerant pipe with foam Insulation between Indoor & Outdoor units with breaking of wall for making hole wherever required For Split Air- Conditioners.	Mtr.	112		
7	S.I.T.C. of 4 core & 4 sqmm Copper conductor flexible cable between Indoor & Outdoor Unit through holes made as above for Cassette / Inverter A.C.	Mtr.	88		
8	S.I.T.C. of 3 core & 4 sqmm copper conductor flexible cable between Indoor & Outdoor units through holes as made above for Split A.C.'s.	Mtr.	112		
9	S.I.T.C. of 19/25 mm. PVC conduit pipe to be used as a drain water pipe. Through holes as made above.	Mtr.	580		
10	Drain Pump: The drain pump collects water in a Drain pan. When the water level reaches a certain point,a float activates the pump. The pump then pushes the water through a dedicated line to a drain or outside.	Nos	2		
11	S.I.T.C. of L shape / suitable shape M.S. Frame stand for mounting Outdoor Units on wall / On floor with all fixing hardwares. Within above Catwalk for cassette & split A.c.'s.	Nos	15		
12	S.I.T.C. of Automatic Digital timer for Server and UPS room AC with 4/8/12 hr Operation option.	Nos	1		
13	Civil work: chisling of walls, palstring of walls, etc required	LOT	1		
14	RE-INSTALLATION/ SHIFTING OF FOLLOWING ACS				
	1.5 TR & 1.0 TR, Hi-Wall Type Split Air-Conditioners				

<p>Taking down and re-installation/ shifting along with gas charging including servicing, repair and running maintenance of following Split type Acs of different makes comprising of floor and wall mounted condensing units including all the scope of work specified above complete as required including repair of Voltage Stabilizer/ Auto Electronic controller (Note:- Copper piping and drain piping shall be measured and paid for separately):</p>	Nos	5		
<p>NOTE : AC units of Voltas, Blue-Star, Carrier only; AC's with COPPER Condenser & Evaporator coils are only to be supplied.</p> <p>Only one of these Makes to be quoted. Pl. enclose Tech. Brocher of the quoted Cassette/ Split A.C.</p> <p>A.C.'s having Service centre In/Near the City should be preferred.</p>				
TOTAL				

Note: All items rate are excluding GST.

CCTV IP Camera System					
SNO	DESCRIPTION	UNIT	QTY	RATES	AMOUNT
1	SITC of Advanced dynamic 8 channel digital event recording system with Digital multiplexer, DVR, Video Motion Detection & Video management System features suitable for CCTV cameras and as specified in the technical specifications inclusive of the rack cost and inclusive of 10 TB SATA Internal Surveillance Hard Drive for 12.5 frames second at 4CIF (704 X 576) resolution. TCP/IP connectivity, dual streaming and H.264 compression.	NOS	1		
2	SITC of fixed dome indoor Colour Varifocal Lens Camera having 0.20 lux level requirement in night mode with the following components / sub assemblies as per specifications, complete with power supply unit, necessary brackets for fixing in the false ceiling etc. as required.(The camera shall be UL/ EN/ FCC certified) <ul style="list-style-type: none"> a. 1/3" progressive scan CCD image sensor Day/Night camera with inbuilt DSP, advanced features like High resolution of minimum 640 x 480, AGC, BLC, extended sensitivity, support on screen display etc. b. 1/3" Image format varifocal lens (4 to 8 mm) 	NOS	8		
3	SITC of coaxial FRLS RG 6 cable for CCTV system.	Metres	220		
4	SITC of 2C x 1.5 sq mm FRLS cable .	Metres	220		
5	SITC of cam power supply	Nos.	8		
6	SAMSUNG 80 CM (32 inch)HD LED,TV,(UA32T4010ARXXL)	NOS	1		
7	Supply,Installation,Testing and commissioning of D-Link 9 U Rack With PDU , Fan and Mounting accessories	NOS	1		
8	Supply,Installation,Testing and commissioning of Cat 6 outlet for CCTV with D-Link Cat-6 cable For Camera	BOX	6		
Grand Total For CCTV Camera System					

Fire Fighting System					
SNO	DESCRIPTION	UNIT	QTY	RATES	AMOUNT
1	Supply, installation, testing and commissioning of Single Loop Intelligent, Addressable Main Fire Alarm Control panel suitable for operation on 230 V, 1 Ph, 50 Hz, AC supply with sufficient number control relay modules, Data entry, necessary programming and comprising following as per specifications complete as required:- a) Intelligent Detection Panel:- i) Microprocessor based central processing unit of at least 16 bit device, EPROM, non volatile memory with real time clock for communication and controlling the Intelligent / Addressable devices and history buffer of Minimum 1000 events with time and date stamp. ii) Capable of integrating 50-60 Detectors and 50-60 Modules. iii) operator interface, control and annunciation panel with back-lit alphanumeric liquid crystal display, system status LED, two level password access and with alphanumeric keypad. iv) One no. printer port to connect printer and other similar accessories. v) Suitable capacity maintenance free battery with 24 hours backup in normal conditions and 30 minutes in alarm condition alongwith battery charger. vi) The housing cabinet shall be corrosion proof, with manufacture standard finish, attack rated door, door lock and transparent viewing on front panel alongwith painting with rust-resistant prime coat complete as required vii) shall be UL/FM/VDS listed.	No.	1		
2					
3	Supply, installation, testing and commissioning of intelligent addressable Smoke and Heat Detector (Multisensor - 3D) with Standard base, Junction box,connector for loop in and loop out, insect resistant screen, built-in tamper resistant features including connection etc. with inbuilt isolator modules and other accessories as required Detectors shall be UL/FM/VDS listed.	Nos.	24		
4	Supply, installation, testing and commissioning of intelligent addressable reponse indicators	Nos.	12		
5	Supply, installation, testing and commissioning of intelligent addressable manual call point	Nos.	4		
6	Supply, installation, testing & commissioning of Addressable Hooter / SOUNDER complete with control module.UL / LPCB approved, make - HONEYWELL, MORLEY IAS, or equivalent as approved by the Deptt.)	Nos.	2		
7	Supply, installation, testing & commissioning of Intelligent Addressable monitor modules with standard base, junction box, connector for loop in and loop out, built in tamper resistant features etc for integrating third party inputs, shall be UL/FM/VDS listed	No.	1		
8	Supply and laying 2 x 1.5 sq mm (14 SWG), 1.1 KV grade flame retardant copper conductor PVC cable with steel braiding and overall shielded with aluminium mylar tape including connection etc. as required.	Metres	350		
	Total				

OPTION - 07
 REVISED ON 21.01.2025

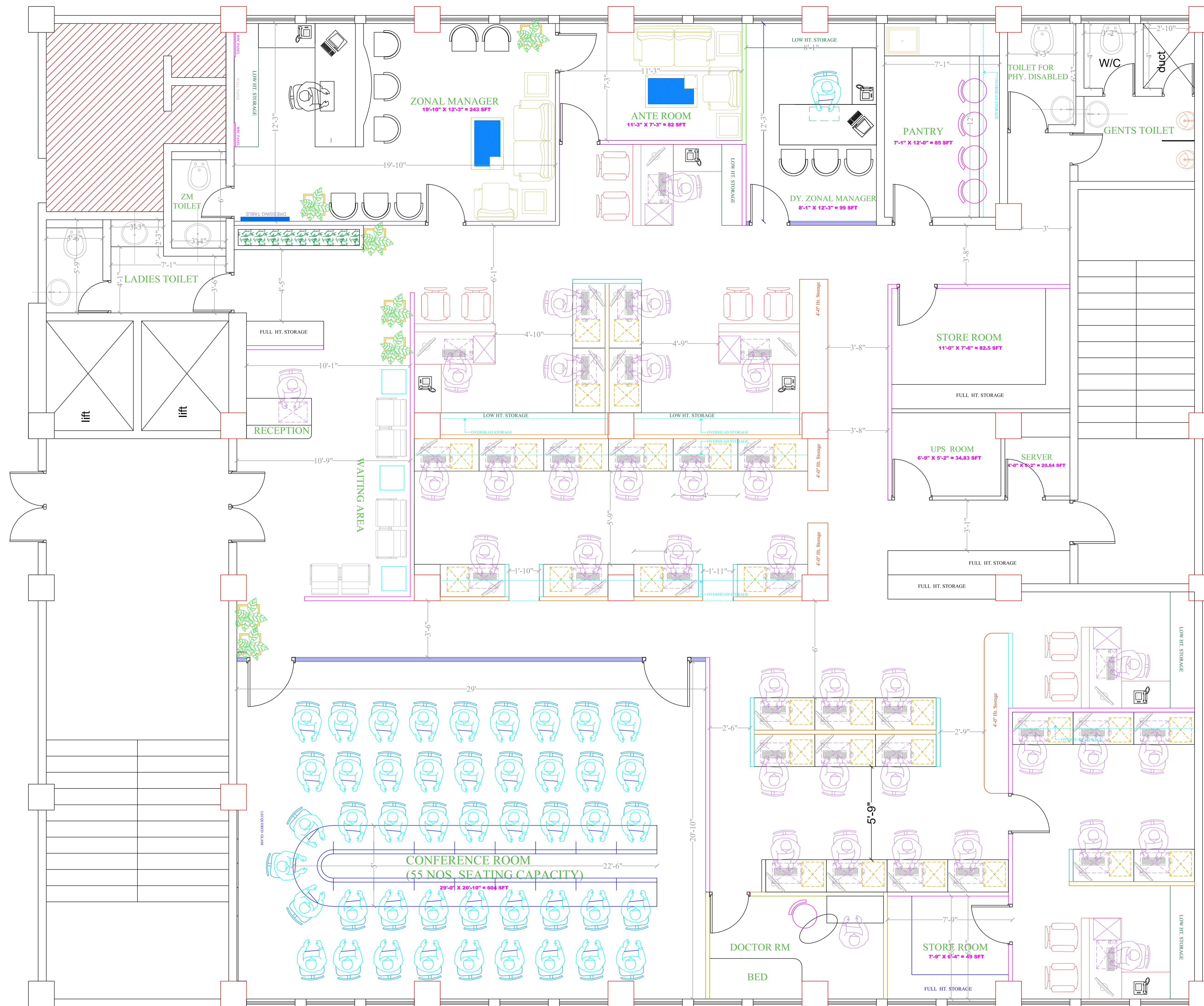

PROPOSED LAYOUT PLAN FOR GUWAHATI ZONAL OFFICE

CLIENT
PUNJAB & SIND BANK
 GUWAHATI ZONAL OFFICE
 UZAN BAZAR, RIVER SIDE
 GUWAHATI - 01, ASSAM

Description of Proposal.
PROPOSED LAYOUT PLAN FOR GUWAHATI ZONAL OFFICE
 AT SETHI TRUST BUILDING, BHANGAGARH, GUWAHATI

SIGN & STAMP

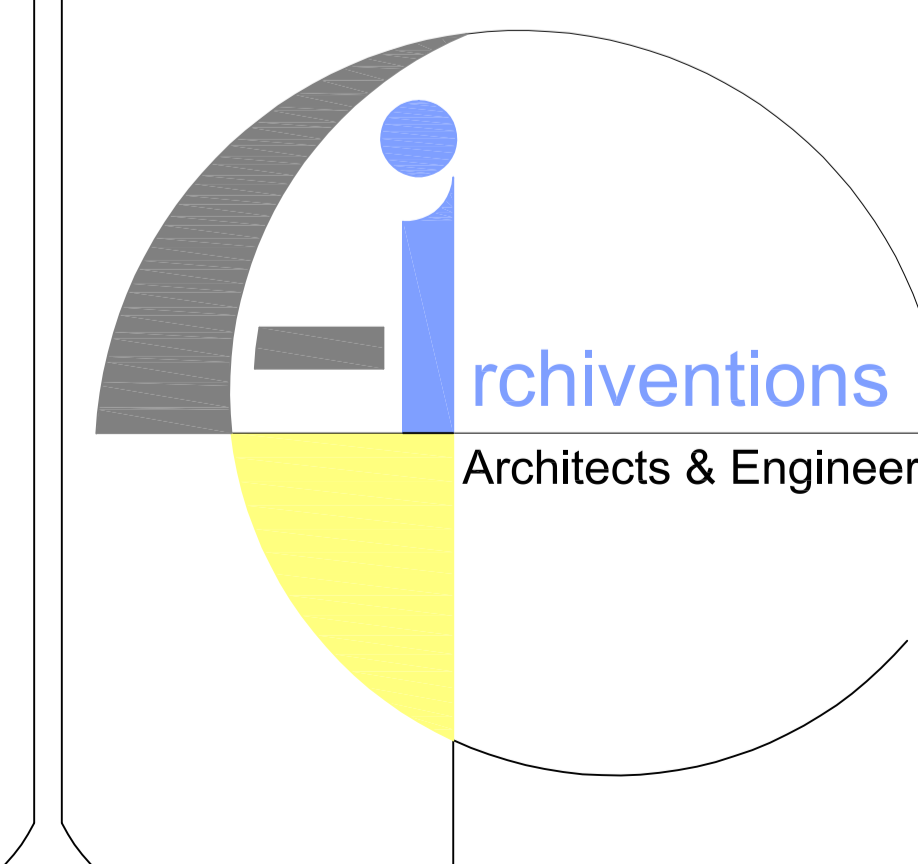

FIRM NAME & ADDRESS

ARCHIVENTIONS

Architects , Planners & Interior Designers
 C.O.A. Regd. No.- CA / 2004 / 32922

ADDRESS
 HOUSE NO-95, GROUND FLOOR
 LACHITNAGAR MAIN ROAD,OPPMHARI NAAMGHAR
 LACHITNAGAR, GUWAHATI-781007, ASSAM
 PH- 9854062928/9436017122

FLOOR PLANS

(FOURTH FLOOR PLAN)

JOB NO.	DATE	SCALE	DEALT BY	CHKD BY	DRG NO.
			AR. DEBOJYOTI DEBROY		

Ar. Debojyoti Debroy
 Chief Architect
 Archiventions
 Architects & Engineers